



Salon Films (H.K.) Ltd.
香港沙龙电影有限公司

EQUIPMENT CATALOGUE
设备目录

Headquarters / 总部：

Hong Kong 香港

Salon Films (H.K.) Ltd.
香港沙龙电影有限公司

Unit C, 4/F., Freder Centre, 68 Sung Wong Toi Road, Tokwawan,
Kowloon, Hong Kong.
香港 九龙 土瓜湾 宋皇台道68号 飞达工商业中心四字楼C座

Tel 电话：(852) 2338 0505
Fax 传真：(852) 2338 2539
E-mail 电子邮件：salonHQ@salonmedia.com
Website 网址：http://www.salonmedia.com

Production & Services 制作与服务

E-mail 电子邮件：Production@salonmedia.com

Technical Equipment & Service 技术器材与服务

E-mail 电子邮件：Rental@salonmedia.com

Bank Information 银行资料：

Account's Name: Salon Films (H.K.) Ltd.

Shanghai Commercial Bank Ltd
President Theatre Branch

Shop A, G/F, 517 Jaffe Road
Causeway Bay, Hong Kong

Hong Kong Dollars Currency A/C
A/C No.: #332-82-07012-0

USD Currency A/C
A/C No.: #332-28-00689-6
Swift No.: SCB KHK HH XXX

Branches / 分公司：

Beijing 北京

Beijing Jinggang Salon Digital Video Films Ltd.
北京京港沙龙影视数字制作技术有限公司

Room 203, Wanhe Tower, No. 35 Erlizhuang, Zhixin Road, Haidian District, Beijing, China 100083
中国北京市 海淀区 二里庄35号楼 万和大厦203室 邮编：100083

Tel 电话：86-10 5986 2706
Fax 传真：86-10 5986 2706
E-mail 电子邮件：office@salonfilms.cn

Beining Jinggang Salon Warehouse
北京京港沙龙仓库

Unit A, First Floor, Cross-Strait Cooperation Science and Technology Industrial Park,
Cross Bridge Village, Ma Chi Kou Town, Changping District, Beijing, China.
中国北京市 昌平区 马池口镇 横桥村 顺沙路 两岸共赢科技产业园A座一层
邮编：102200

Tel 电话：86-10 6074 5362

Bank Information 银行资料：

单位名称：北京京港沙龙影视数字制作技术有限公司

开户行：中国工商银行北京北太平庄支行

账号：0200010009200036497

注册地址：北京市海淀区二里庄35号楼二层 203

统一社会信用代码（纳税人识别号）：91110108600001955A

Shanghai 上海

Salon Shanghai Multimedia Company Ltd.
上海沙龙多媒体综合技术应用发展有限公司

No. 11, 5/F., Block D, Orient International Mansion, 85 Lou Shan Guan Road,
Chang Ning District, Shanghai, China 200336
中国 上海市 长宁区娄山关路85号 东方国际大厦D座5楼11号 邮编：200336

E-mail 电子邮件：monali@salonmedia.com / 13816887189@163.com

Salon Shanghai Warehouse
沙龙上海仓库

602 Shang Zhong Road, Shanghai 200231 China
中国 上海市 上中路602号 邮编：200231

Tel 电话：86-21 5429 6096

Bank Information 银行资料：

单位名称：上海沙龙多媒体综合技术应用发展有限公司

开户行：工行上海市闸北支行延长分行

账号：1001295109300105629

Guangzhou 广州

Beijing Jinggang Salon Digital Video Films Ltd. (Guangzhou branch)
北京京港沙龙影视数字制作技术有限公司 (广州分公司)

Room 102, First Floor, Taohui Mall, No. 97, Jingye Road, Wenchong,
Huangpu District, Guangzhou, China 510725
广州市 黄埔 文冲敬业路97号 淘汇商城首层102室, 邮编：510725

Tel 电话：86-20 3431 7984

E-mail 电子邮件：siupinglaw@salonmedia.com / salongz@163.com

Bank Information 银行资料：

单位名称：北京京港沙龙影视数字制作技术有限公司广州分公司

开户行：中国工商银行股份有限公司广州广州大道支行

账号：3602072209200883672

Macau 澳门

Salon Multimedia Macau Ltd.
沙龙(澳门)多媒体有限公司

Avenida do Almirante Magalhães Correia No. 41,
Ind. Keck Seng W3, EM Macau
澳门 高利亚海军上将大马路41号 激成工业中心(第三期)3楼W座

Tel 电话：853 2871 6333

Fax 传真：853 2871 6338

E-mail 电子邮件：info@salonmacao.com

Bank Information 银行资料：

Account's Name: Salon Multimedia (Macau) Ltd.

Bank Name: Banco Nacional Ultramarino

MOP Currency A/C No.: 9014900393

Kuala Lumpur 吉隆坡

Salon Films (M) Sdn Bhd
马来西亚沙龙电影有限公司

Lot 6.12, 6th Floor Wisma Central, Jalan Ampang,
50450 Kuala Lumpur, Malaysia

Tel 电话 : 60 3 2693 7482
Fax 传真 : 60 3 2693 1728
E-mail 电子邮件 : daven@salonmedia.com

Bank Information 银行资料 :

Bank Name: Maybank Berhad

A/C No.: 0140 1154 0845

Singapore 新加坡

SIMF Management Pte Ltd.

1 Scotts Road, #24-10 Shaw Centre, Singapore 228208

Tel 电话 : 65 6222 5059
E-mail 电子邮件 : salonHQ@salonmedia.com



SALON FILMS (H.K.) LTD.
香港沙龍電影有限公司

PANAVISION 70MM LENS

PRIMO 70 SERIES 普利莫 (顶级) 70系列镜头 13

PANAVISION 35MM LENS

PRIMO CLOSE FOCUS ANAMORPHIC LENS 近摄变形宽银幕镜头 14
PRIMO ANAMORPHIC LENS 变形宽银幕镜头 14
"C" SERIES ANAMORPHIC LENS "C" 系列变形宽银幕镜头 14
"G" SERIES ANAMORPHIC LENS "G" 系列变形宽银幕镜头 14
SUPER HIGH SPEED ANAMORPHIC LENS SUPER HIGH SPEED 近摄变形宽银幕镜头 15
ANAMORPHIC TELEPHOTO LENS 变形宽银幕长焦镜头 15
ANAMORPHIC ZOOM LENS 变形宽银幕变焦镜头 15
ANAMORPHIC MACRO LENS 变形宽银幕微距镜头 15
PRIMO CLOSE FOCUS SPHERICAL LENS RPIMO系列近摄平面镜头 16
PRIMO PRIMES LENS RPIMO系列平面镜头 16
PRIMO V SPHERICAL LENS RPIMO V 系列平面镜头 16
ULTRA SPEED MK II LENS ULTRA SPEED MK II 系列平面镜头 17
SUPER SPEED MK II LENS SUPER SPEED MK II 系列平面镜头 17
NORMAL SPEED MK II LENS NORMAL SPEED MK II 系列平面镜头 17
PVINTAGE SUPER SPEED LENS PVINTAGE SUPER SPEED 系列平面镜头 17
TELEPHOTO LENS 长焦镜头 18
ZOOM LENS 变焦镜头 18
ZOOM LENS ACCESSORY 变焦镜头附件 18
SPECIAL LENS SYSTEM 特殊镜头 19
PANAVISION / CENTURY SWING SHIFT SYSTEM PANAVISION / CENTURY 移轴镜头系统 19

CAMERAS 摄像机

ARRI ALEXA SXT CAMERA 4:3 20
ARRI ALEXA XT CAMERA 4:3 20
ALEXA - M.4:3 CAMERA - XR 20
ALEXA STUDIO - XR 20
ALEXA MINI BODY SET 20
ARRI ALEXA HD CAMERA 21
RED MONSTRO 8K VV 21
RED WEAPON HELIUM 8K S35 21
RED GEMINI 5K S35 21
RED DRAGON 6K CAMERA 21
SONY VENICE 6K FULL FRAME CAMERA SET (RAW) 索尼 VENICE 6K 全片幅摄录机 22
SALON MULTICAM 4K LIVE PRODUCTION SYSTEM 22
SONY A7R3 CAMERA 索尼 A7R3摄录机 22
BLACKMAGIC MICRO CINEMA CAMERA 2K 22
BLACKMAGIC POCKET CINEMA CAMERA 4K 22

MEDIA STATION 数据工作站 23

3D EQUIPMENT 3D 器材

3ALITY DIGITAL TS RIG 23
SCREENPLANE RIG 23
ZOOM LENS 23

35MM ANAMORPHIC LENSES 35MM 变形宽银幕镜头

POWERSCOPE ANAMORPHIC LENSES POWERSCOPE 变形宽银幕镜头 24
MASTER ANAMORPHIC LENSES MASTER 变形宽银幕镜头 24
COOKE ANAMORPHIC/I LENSES COOKE 变形宽银幕镜头 24

35MM SPHERICAL LENSES

ZEISS SUPREME PRIME LENSES (FULL FRAME) 蔡司SUPREME PRIME系列镜头(全片幅) 25
ZEISS COMPACT PRIME CP.3 LENSES (FULL FRAME) 蔡司COMPACT PRIME CP.3系列镜头(全片幅) 25
ARRI MASTER PRIME SERIES ARRI MASTER PRIME系列镜头 25
ARRI ULTRA PRIME LENSES 阿莱ULTRA PRIME定焦镜头 25
35MM HIGH SPEED LENSES 35MM 高速镜头 26
ZEISS 35MM PRIME LENSES 蔡司35MM 定焦镜头 26
35MM TELEPHOTO LENSES 35MM 长焦镜头 26
35MM OPTICS ACCESSORIES 35MM光学附件 26
ARRI 35MM MACRO LENSES (W/54MM PL-MOUNT) 阿莱35MM微距镜头 (W/54MM PL-接环) 26

35MM ZOOM LENSES (W/54MM PL-MOUNT) 35MM 变焦镜头 (W/54MM PL-接环)

ANGENIEUX OPTIMO ZOOM 安琴 OPTIMO 变焦镜头 27
ANGENIEUX OPTIMO DP ZOOM 安琴 OPTIMO DP 变焦镜头 27
ALURA ZOOM ALURA 变焦镜头 27
ANGENIEUX HR ZOOM ANGENIEUX HR 变焦镜头 27
OTHER ZOOM LENS 其他变焦镜头 27
35MM SPECIAL PURPOSE LENSES 35MM 特殊用途镜头 27
TILT FOCUS LENS 移轴镜对焦镜头 27

VIDEO & MONITORING 视频监视器、录像机

HD MONITOR 高清监视器 28
3D MONITOR 28
RECORDER 记录仪 29
HD VIDEO WIRELESS TRANSMITTER / RECEIVER 无线高清发射 / 接收器 29
CONVERTER 转换器 29
VIDEO MIXER 视频混合器 29

CAMERA ACCESSORIES 摄影机附件

BATTERIES AND CHARGES 电池充及电器 30
GRIPS AND HANDLES 手柄及把手 30
HEADS 云台 30
MOUNTS AND BASES 支架及底座 30
MATTE BOXES AND SUNSHADES 遮光罩及附件 31
FOLLOW FOCUS AND VIEWFINDER 跟焦器及取景器 31
TRIPODS 三脚架 31
SPRAY DEFLECTORS 电动防雨屏 31

LENS FILTERS 镜头滤光镜 32-33

REMOTE PRODUCTS AND METER 遥控产品 34

STEADICAM 稳定拍摄系统

STEADICAM ULTRA CINE STABILIZING SYSTEM 斯坦尼康ULTRA CINE 稳定拍摄系统 35
MKV NEXUS STABILIZING SYSTEM MKV NEXUS 稳定拍摄系统 35
MKV EVOLUTION STABILIZING SYSTEM (MODULAR DESIGN) MKV EVOLUTION 稳定拍摄系统 (组合设计) 35
STEADICAM ACCESSORIES 稳定拍摄系统附件 35
HANDHELD STABILIZER 手提稳定器 36
HANDSFREE TRANSPORTER 智能拍摄车 36

CAR MOUNTS EQUIPMENT 影机汽车架 36

UNDERWATER HOUSING 潜水摄影机罩 36

TABLE OF CONTENTS

目录

PAGE 页码

LIGHTING EQUIPMENT

照明设备

HMI PAR - FLICKER FREE SET	高温直射镝灯	38
HMI ARRI "M" SERIES	高温多面反射镝灯 (阿莱-M系列)	38
K5600 ALPHA HMI LIGHT	K5600 ALPHA 高温灯	38
HMI FRESNEL - FLICKER FREE SET	高温聚光镝灯	38
HMI BEAM LIGHT	高温束光灯	38
X-LITE - FLICKER FREE	高温X-LITE系列影子灯	38
JOKER BUG	高温泛光日光灯	39
XENON	氙气灯	39
LIGHTNING STRIKE	闪电灯	39
CARBON ARCS	碳精灯	39
TUNGSTEN LAMPS (FRESNEL)	低色温聚光灯 (Fresnel)	39
DEDOLIGHT	特图力	39
TUNGSTEN LAMPS (OPEN FACE)	低色温散光灯 (Open Face)	40
TUNGSTEN LAMPS (SOFT LIGHT)	低色温柔光灯	40
FAY AND PAR LAMPS	聚射灯具	40

LIGHTING ACCESSORIES

灯 - 配件

SPEED RING		41
CHIMERA		41
FLORESCENT LIGHTING	灯管灯	41
LED		42
ARRI SKYPANEL LED SOFTLIGHT		42
ADDITIONAL ACCESSOIRES FOR SKYPANEL		42
ARRI L-SERIES	阿莱 - L系列	43
LED TUBE (RECHARGEABLE BATTERY)	LED 光管 (充电式)	43
TUNGSTEN BATTERY SUNGUNS	低色温手提灯	43
LANTERN	LANTERN 灯笼灯	43
HMI BALL	高温球灯	43
AIRLITE		43
UMBRELLA SOFT BOX	伞子灯	43
SOURCE FOUR PAR	多用途直射灯	44
DISTRIBUTION CABLES AND ADAPTERS	配电箱、电线及接头	44
ELECTRONIC DIMMERS	电子调光器	44
VARIAC	变压器	45
POWER DISTRIBUTION BOXES	配电箱	45
INVERTER	逆变器	45
OTHER		45

SMOKE MACHINES & FANS

放烟机和风扇

SMOKE MACHINE	放烟机	46
FANS	风扇	46
GENERATORS	发电机	46

GRIP EQUIPMENT

场景工程设备

STANDS	支架	48
MOUNTINGS	夹具	48-50
REFLECTORS, CLOTH AND OVERHEADS	反光板、柔光布及框架装置	51-52
SCRIMS, FLAGS, CUTTER AND WOOD	纱、旗板及木器	52-53
PARALLELS, SANDBAG AND OTHER		53
CART	手推车	53
STEELDECK		53

TABLE OF CONTENTS

目录

PAGE 页码

DOLLIES

移动摄影车

SUPER PEEWEE DOLLY	SUPER PEEWEE 摄影移动机车	56
PEEWEE TRACKS AND ACCESSORIES	PEEWEE 轨道和配件	56
FISHER DOLLY	FISHER 摄影移动机车	57
SUPER PANTHER III DOLLY	SUPER PANTHER III 电动升降移动摄影车	57
PLATFORM, BRIEFCASE AND FOCUS DOLLY	移动车	57
DOORWAY DOLLY	小气吹移动摄影车	57
WESTERN DOLLY	大气吹移动摄影车	57
DANNA DOLLY		57
RICKSHAW	人力车	57
CRASH BOX	爆炸箱	57
SLIDER	移动滑轨	57
G.F.M GRIP EQUIPMENT	G.F.M 配套附件	57
GFM ADJ GAS RISER	G.F.M 气压立柱	57

CRANE EQUIPMENT

摄影升降台设备

THE SUPERTECHNO 30		58
NEW TECHNO CRANE WITH Z HEAD (22 FT)		59
GF 8 XTEN-FULL SET	G.F. 8 XTEN 11米升降系统 (套装)	59
GF 16-FULL SET	G.F. 16 -16米升降系统 (套装)	59
G.F. JIB ARM	G.F. 摇臂	59
GF MINI-JIB	G.F. 摇臂 - 短	59
MINI JIB ARM - LONG	小型摇臂 - 长	59
SUPER MAXI JIB ARM	SUPER MAXI 摇臂	59
SWISS JIB - IMPROVED VERSION	瑞士摇臂 - 改进版	59
PANTHER SUPER JIB III	PANTHER 超摇臂 III	59
STANDARD PORTA JIB	标准 PORTA 摇臂	59
PHOENIX CRANE	PHOENIX 摇臂	59
TULIP CRANE	TULIP 摇臂	59
TULIP CRANE SUPER SKYMOTE	TULIP CRANE SUPER SKYMOTE 摇臂	59

CAMERA REMOTE PRODUCTS

远程摄影机产品

POWER POD MK IV REMOTE	POWER POD MK IV 遥控云台系统	60
REMOTE HEAD (PAN BAR OR HAND WHEEL CONTROL)	遥控云台	60
CABLE CAM	飞猫 (滑索式拍摄架)	60
WALKIE TALKIE	对讲机	60



SALON FILMS (H.K.) LTD.
香港沙龍電影有限公司

PANAVISION 70MM LENS

DAILY HK\$
每日价格 (港元)

PANAVISION PRIMO 70 SERIES 普利莫 (顶级) 70系列镜头

Introducing the Primo 70 series lenses, the highest performance motion picture lenses ever developed. Primo 70 lenses on digital cameras represent a new creative choice to the cinematographer, building on the Primo heritage and extending it into the future. Intrinsic characteristics of these new lenses include flat field, natural sharpness, minimal chromatic aberration, minimal breathing, excellent field illumination, and close focus performance. Other artistic traits include roundness, dimensionality, Pleasing skin tones, personality and good bokeh. Wider formats are currently in development.

PRIMO 70 SERIES 普利莫 (顶级) 70系列镜头

CLOSE FOCUS TO 最近对焦距离

14mm T3.1	8"	3,471
24mm T2.0	12"	3,471
27mm T2.0	14"	3,471
35mm T2.0	14"	3,471
40mm T2.0	14"	3,471
50mm T2.0	16"	3,471
65mm T2.0	20"	3,471
80mm T2.0	24"	3,471
100mm T2.0	30"	3,471
125mm T2.0	36"	3,471
150mm T2.0	48"	3,471
200mm T2.8	48"	3,471
250mm T2.8	48"	3,471
28-80mm T3.0	33"	5,889
70-185mm T3.5	60"	5,889
200-400mm T4.5	78"	5,889

PANAVISION 35MM LENS

DAILY HK\$
每日价格 (港元)

PRIMO CLOSE FOCUS ANAMORPHIC LENS 近摄变形宽银幕镜头	CLOSE FOCUS TO 最近对焦距离	
--	--------------------------	--

Colour matched lense providing excellent image quality over an extended focus range
色比配镜头，在更广阔的对焦范围提供卓越的图像质量

35MM T2	33"	1,482
40MM T2	30"	1,482
50MM T2	30"	1,482
75MM T2	54"	1,482
100MM T2	54"	1,482

PRIMO ANAMORPHIC LENS 变形宽银幕镜头	CLOSE FOCUS TO 最近对焦距离	
----------------------------------	--------------------------	--

Colour matched lense providing excellent image quality
色比配镜头，提供卓越的图像质量

35MM T2	42"	1,482
40MM T2	42"	1,482
50MM T2	42"	1,482
75MM T2	54"	1,482
100MM T2	54"	1,482

"C" SERIES ANAMORPHIC LENS "C" 系列变形宽银幕镜头	CLOSE FOCUS TO 最近对焦距离	
---	--------------------------	--

Compact lense providing good image quality
致密镜头，提供优良图像质量

20MM T2.8	42"	1,794
30MM T3	48"	1,482
35MM T2.3	33"	1,482
40MM T2.8	30"	1,482
50MM T2.3	30"	1,482
60MM T2.8	20"	1,482
75MM T2.5	54"	1,482
100MM T2.8	54"	1,482
150MM T3.5	60"	1,482
180MM T2.8	84"	1,482

"G" SERIES ANAMORPHIC LENS "G" 系列变形宽银幕镜头	CLOSE FOCUS TO 最近对焦距离	
---	--------------------------	--

25MM T2.6	30"	1,482
30MM T2.6	30"	1,482
35MM T2.6	36"	1,482
40MM T2.6	36"	1,482
50MM T2.6	36"	1,482
60MM T2.6	36"	1,482
75MM T2.6	36"	1,482
100MM T3	36"	1,482

PANAVISION 35MM LENS

DAILY HK\$
每日价格 (港元)

SUPER HIGH SPEED ANAMORPHIC LENS SUPER HIGH SPEED 近摄变形宽银幕镜头	CLOSE FOCUS TO 最近对焦距离	
--	--------------------------	--

24MM T1.6 Auto Panastar Lens	72"	1,482
35MM T1.4 Auto Panastar Lens	54"	1,482
50MM T1.1 Auto Panastar Lens	48"	1,482
55MM T1.4 Auto Panastar Lens	48"	1,482
75MM T1.8 Auto Panastar Lens	54"	1,482
100MM T1.8 Auto Panastar Lens	54"	1,482

ANAMORPHIC TELEPHOTO LENS 变形宽银幕长焦镜头	CLOSE FOCUS TO 最近对焦距离	
--	--------------------------	--

360MM T3.8	5' 6"	1,482
400MM T3.5	9'	1,768
600MM T4.5	27'	1,768
800MM T5.6	15'	1,768
1200MM T8	27'	1,768

ANAMORPHIC ZOOM LENS 变形宽银幕变焦镜头	CLOSE FOCUS TO 最近对焦距离	
-----------------------------------	--------------------------	--

48/550MM T4.5 Primo Zoom Lens	4' 1"	4,836
270/840MM T4.5 Primo Zoom Lens	8' 6"	4,563
40/200MM T4.5 Super Panazoom Lens	2' 6"	1,482
50/500MM T2.3 Super Panazoom Lens	5' 6"	2,262

ANAMORPHIC MACRO LENS 变形宽银幕微距镜头	CLOSE FOCUS TO 最近对焦距离	
------------------------------------	--------------------------	--

55MM T2.5 Macro Pantar Lens	10"	1,482
150MM T3.2 Macro Pantar Lens	17"	1,482
200MM T3.2 Macro Pantar Lens	18"	1,482
250MM T3.2 Macro Pantar Lens	29"	1,482

PANAVISION 35MM LENS

DAILY HK\$
每日价格 (港元)

PRIMO CLOSE FOCUS SPHERICAL LENS RPIMO系列近摄平面镜头	CLOSE FOCUS TO 最近对焦距离	
---	--------------------------	--

Colour matched lense providing excellent image quality over an extended focus range
色比配镜头，在更广阔的对焦范围提供卓越的图像质量

14.5MM T1.9	8.25"	1,404
17.5MM T1.9	7.5"	1,404
21MM T1.9	9.5"	1,404
27MM T1.9	9.5"	1,404
35MM T1.9	11"	1,404

PRIMO PRIMES LENS RPIMO系列平面镜头	CLOSE FOCUS TO 最近对焦距离	
----------------------------------	--------------------------	--

Colour matched lense providing excellent image quality
色比配镜头，提供卓越的图像质量

10MM T1.9	24"	1,599
14.5MM T1.9	24"	1,209
17.5MM T1.9	24"	1,209
21MM T1.9	24"	1,209
27MM T1.9	24"	1,209
35MM T1.9	24"	1,209
40MM T1.9	24"	1,209
50MM T1.9	24"	1,209
75MM T1.9	36"	1,209
100MM T1.9	36"	1,209
150MM T1.9	60.8"	1,209
1.4X Primo Extender (-1 STOP)		585
Wide Angle Adapter For 10MM		585

PRIMO V SPHERICAL LENS RPIMO V 系列平面镜头	CLOSE FOCUS TO 最近对焦距离	
--	--------------------------	--

Primo V eliminate coma, astigmatism (vertical and horizontal focus differences), and other aberrations caused by the extra layers of glass in digital cameras.

Primo V 系列改良型镜头，迎合当代高清摄影机的结构及要求，提供超卓的图像质量。

10MM T1.9	24"	1,443
14.5MM T1.9	24"	1,443
17.5MM T1.9	24"	1,443
21MM T1.9	24"	1,443
27MM T1.9	24"	1,443
35MM T1.9	24"	1,443
40MM T1.9	24"	1,443
50MM T1.9	24"	1,443
75MM T1.9	36"	1,443
100MM T1.9	36"	1,443

PANAVISION 35MM LENS

DAILY HK\$
每日价格 (港元)

ULTRA SPEED MK II LENS ULTRA SPEED MK II 系列平面镜头	CLOSE FOCUS TO 最近对焦距离	
--	--------------------------	--

14MM T1.9	24"	250
17MM T1.9	24"	250
20MM T1.9	30"	250
24MM T1.3	24"	250
29MM T1.3	27"	250
35MM T1.3	24"	250
40MM T1.3	24"	250
50MM T1.4	24"	250
75MM T1.9	24"	250
100MM T1.6	48"	250
125MM T1.6	42"	250
150MM T1.5	60"	250

SUPER SPEED MK II LENS SUPER SPEED MK II 系列平面镜头	CLOSE FOCUS TO 最近对焦距离	
--	--------------------------	--

24MM T2	24"	250
28MM T2	24"	250
35MM T1.6	24"	250
50MM T1.4	24"	250
55MM T1.1	30"	250

NORMAL SPEED MK II LENS NORMAL SPEED MK II 系列平面镜头	CLOSE FOCUS TO 最近对焦距离	
--	--------------------------	--

8MM T2.8 NIKON Fisheye	12"	554
9.8MM T2.8	24"	250
16MM T2.8	21"	250
20MM T2.8	30"	250
24MM T2.8	24"	250
28MM T2.8	24"	250
32MM T2.8	24"	250
35MM T2	24"	250
40MM T2	24"	250
50MM T2	27"	250
75MM T2	30"	250
100MM T2.4	42"	250
150MM T2.8	60"	250

PVINTAGE SUPER SPEED LENS PVINTAGE SUPER SPEED 系列平面镜头	CLOSE FOCUS TO 最近对焦距离	
--	--------------------------	--

14MM T1.9	24"	655
17MM T1.9	24"	655
24MM T1.2	24"	655
29MM T1.2	28"	655
35MM T1.6	24"	655
40MM T1.3	24"	655
50MM T1.1	24"	655
75MM T1.1	24"	655
100MM T1.6	48"	655

PANAVISION 35MM LENS

DAILY HK\$
每日价格 (港元)

TELEPHOTO LENS
长焦镜头

CLOSE FOCUS TO
最近对焦距离

200MM T2 CANON	8'	1,326
300MM T2.8 CANON	10'	1,326
400MM T2.8 CANON	15'	1,326
600MM T4.5 CANON	27'	1,326
800MM T5.6 CANON	45'	1,326

ZOOM LENS
变焦镜头

CLOSE FOCUS TO
最近对焦距离

14.5/50MM T2.2 3:1 Close Focus	15"	4,329
17.5/75MM T2.3 Primo Zoom Lens	15"	4,329
24/275MM T2.8 11:1 Primo Zoom Lens	2' 9"	4,945
135/420MM T2.8 3:1 Primo Zoom Lens	8' 6"	4,329
20/120MM T3 Pan Zoom Lens	3' 6"	844
20/100MM T3.1 5:1 Cookie Zoom Lens	5' 6"	1,170
25/250MM T4 Super Pan Zoom Lens	5' 6"	1,170
150/600MM T6.3 CANON Zoom Lens	10'	2,201

ZOOM LENS ACCESSORY
变焦镜头附件

Panabar Zoom Control	312
Super Zoom Control	312
Zoom Control	312
PFX Zoom Heater Cover	312

PANAVISION 35MM LENS

DAILY HK\$
每日价格 (港元)

SPECIAL LENS SYSTEM
特殊镜头

PANAVISION FRAZIER LENS SYSTEM	8,556
PANAVISION FRAZIER 镜头	

Includes:

- 1 17MM
- 1 20MM
- 1 24MM
- 1 28MM
- 1 35MM
- 1 45MM
- 1 50MM
- 1 Modular Follow Focus Box
- 1 Image Rotation Motor
- 1 Small Filters

PANAVISION / CENTURY SWING SHIFT SYSTEM
PANAVISION / CENTURY 移轴镜头系统

Bellow lens system that allow for a variety of extreme lens movements including: swing, shift, tilt, rise and fall, macro focusing and beyond.
距离皮腔镜头系统允许各种极限镜头运动，包括：摇摆、移转、倾斜、上升、下降及微距摄影。

PANAVISION / CENTURY SWING SHIFT SYSTEM	2,691
14MM T2.8	593
18MM T2.8	538
24MM T2.8	538
28MM T2.8	538
35MM T2.8	538
45MM T2.8	538
55MM T2.8	538
75MM T2.8	538
90MM T2.8	538
105MM T2.4	538
135MM T4.5	538
150MM T3.5	538

CAMERAS

摄像机

DAILY HK\$
每日价格 (港元)

ARRI ALEXA SXT CAMERA 4:3

14,000

Includes: 包括:

- 1 ALEXA EVF-1 1个 ALEXA 电子目镜
- 1 Finder Extension 1个 目镜延伸支架
- 1 7" ON-BOARD Monitor 1个 7寸机顶(辅助监视器)
- 1 Center Handle 1个 提手
- 2 Power Cable 2个 供电线
- 4 1 Tb Capture Drive 4个 1 Tb 录制存储硬盘
- 1 Capture Drive Dock 1个 录制存储模块
- 3 28V Li-on Battery (with Charger) 3个 28V锂电池连充电器

ARRI ALEXA XT CAMERA 4:3

12,000

ALEXA - M.4:3 CAMERA - XR

12,000

ALEXA STUDIO - XR

12,000

Includes: 包括:

- 1 ALEXA EVF-1 1个 ALEXA 电子目镜
- 1 Finder Extension 1个 目镜延伸支架
- 1 7" ON-BOARD Monitor 1个 7寸机顶(辅助)监视器
- 1 Center Handle 1个 提手
- 2 Power Cable 2个 供电线
- 4 512 GB Capture Drive 4个 512(GB) 录制存储硬盘
- 1 Capture Drive Dock 1个 录制存储模块
- 3 28V Li-on Battery (with Charger) 3个 28V锂电池连充电器

ALEXA MINI BODY SET

10,000

Includes: 包括:

- 1 Titanium PLA LDS Mount with L-Bus Connector 1个 钛制PL卡口带L-Bus(跟焦)控制接口
- 1 ALEXA MINI Viewfinder w/Bracket 1个 ALEXA MINI 目镜 / 支架
- 2 Lightweight Adapter Plate 2个 轻质转接板
- 1 Side Bracket 1个 侧安装支架
- 1 Bridge Plate 1个 底板承托板
- 1 Shoulder Pad 1个 肩垫
- 2 Power Cable 2个 供电线
- 3 CFast 2.0 Card 256 GB 3个 CFast 2.0存储卡 256 GB
- 1 CFast 2.0 Card Reader 1个 CFast 2.0存储卡读卡器
- 1 7" On-Board Monitor 1个 7寸机顶(辅助)监视器
- 4 14.8V V-Mount 4个 14.8伏特V口电池
- 1 14.8V V-Mount Battery Charger 1个 14.8伏特SMALL电池充电器

CAMERAS

摄像机

DAILY HK\$
每日价格 (港元)

ARRI ALEXA HD CAMERA

7,000

Includes: 包括:

- 1 ALEXA EVF-1 1个 ALEXA 电子目镜
- 1 Finder Extension 1个 目镜延伸支架
- 1 7" On-Board Monitor 1个 7寸机顶(辅助)监视器
- 1 Center Handle 1个 提手
- 2 Power Cable 2个 供电线
- 3 64GB SONY SxS Memory Card 3个 64GB SONY SxS 存储卡
- 1 SxS Card Reader 1个 SxS 存储卡读卡器
- 4 14.8V V-Mount Battery 4个 14.8伏特 V口电池
- 1 14.8V V-Mount Battery 1个 14.8伏特 V口电池充电器

Optional Accessories:

CODEX 512 GB Capture Drive 512 GB 录制存储硬盘 1,200
CFast 2.0 Card 128 GB 400
CFast 2.0 Card 256 GB 800
SONY SxS Memory Card 64 GB 800
CODEX On-Board Recorder 7,000
(ARRI RAW / RGB 4:4:4:4) PACK
includes: (ARRI RAW格式/RGB 4:4:4:4格式)
包括: 包括:
3 256 GB Datapack 3个 256GB 存储器
1 Transfer Station 1个 转换模块
1 ALEXA Handle 1个 ALEXA 控制手柄

RED MONSTRO 8K VV

16,000

RED WEAPON HELIUM 8K S35

12,000

RED GEMINI 5K S35

8,500

Includes: 包括:

- 1 DSMC MAG PL Mount 2.0 1个 钛制PL卡口
- 1 DSMC2 RED PRO Touch LCD Mon 1个 LCD触摸屏
- 4 RED MINI-MAG 960GB with Case 4个 960GB 存储卡
- 1 RED Station RED MINI-MAG 1个 存储卡读取器
- 1 DSMC2 V-Mount I/O Expander 1个 DSMC2 V口扩展器模块
- 1 Top-Handle 1个 提手
- 1 Monitor Support 1个 显示器承托
- 1 Bridge Plate 1个 底板承托板
- 4 14.8V V-Mount Battery 4个 14.8伏特 V口电池
- 1 Battery Charger 1个 电池充电器

RED DRAGON 6K CAMERA

8,500

Includes: 包括:

- 1 DSMC 1.8" SSD Side Module 1个 1.8寸 SSD存储卡存储模块
- 1 RED Touch 7" LCD 1个 7寸 LCD触摸屏
- 1 RED Mote 1个 遥控器
- 1 DSMC TI PL Mount 1个 钛制PL卡口
- 1 RED Bomb EVF 1个 电子目镜
- 1 DSMC Side Handle 1个 侧手柄控制器
- 4 14.8V V-Mount Battery 4个 14.8伏特 V口电池
- 1 Battery Charger 1个 电池充电器
- 4 Redmag 1.8" SSD 128GB / 240GB 4个 1.8寸 128GB / 240GB SSD存储卡
- 1 Bridge Plate 1个 底板承托板

Optional Accessories: 可选组件:

Shoulder Set 肩扛套装 350
64 GB RED Drive 64 GB RED 存储卡 100
128 GB RED MAG 1.8" 128GB RED 存储卡 500
240 GB RED MINI-MAG 240GB SSD存储卡 500
512 GB RED MINI-MAG 512GB SSD存储卡 800
SMALL HD 7" TV Logic / LCD MON SMALL 7寸 TV LOGIC / 1,000
(HDMI / HDSD) HD LCD监视器
SWIT 7" TV LOGIC / LCD MON SWIT 7寸 TV LOGIC / 视威 600
(HDMI / HDSD) LCD监视器 (HDMI/HDSD)

CAMERAS

录像机

DAILY HK\$
每日价格 (港元)SONY VENICE 6K FULL FRAME CAMERA SET (RAW)
索尼 VENICE 6K 全片幅摄影机

12,000

Includes:

- 1 AXS-R7 - RAW / X-OCN Recoeder
- 1 AXS - CR1 Compact Card for AXS Media
- 4 AXS Memory A Series Card - 512 GB
- 1 DVF-EL200 Full HD OLED Viewfinder
- 1 Viewfinder Bracket
- 1 Top Handle
- 1 Bridge Plate
- 4 14.8V V-Mount Battery
- 1 Battery Charger
- Optional Accessories:
- AXS Memory A Series Card - 512 GB
- 7" On-Board Monitor

1,000
800

SALON MULTICAM 4K LIVE PRODUCTION SYSTEM

23,500

Includes:

- 4 BLACKMAGIC URSA Broadcast Cameras 4K
- 2 FUJINON XA17X7.6BRM-M48
- 2 FUJINON XA16X8B-XB8
- 3 Broadcast Remote Zoom & Focus Kit
- 4 BLACKMAGIC Camera Fiber Converters
- 4 BLACKMAGIC Studio Fiber Converters
- 3 BLACKMAGIC URSA Studio Viewfinder
- 1 BLACKMAGIC URSA Handheld Viewfinder
- 1 BLACKMAGIC URSA Mini Shoulder Kit
- 1 BLACKMAGIC ATEM 1 M/E Advanced Panel
- 1 BLACKMAGIC ATEM 4 M/E Broadcast Studio
- 1 BLACKMAGIC ATEM Camera Control
- 2 BLACKMAGIC Hyperdeck Studio 12G
- 1 BLACKMAGIC Smart Videohub 12G 40X40
- 1 BLACKMAGIC Teranex AV
- 1 BLACKMAGIC SmartScope Duo 4K
- 1 BLACKMAGIC Audio Monitor
- 1 CYBERPOWER PR1500ELCDRTL20
- 1 SAMSUNG 43" LED 4K TV
- 1 BEHRINGER X32 Compact MIXER
- 4 SMPTE / LEMO Hybrid Fiber Cables

SONY A7R3 CAMERA 索尼 A7R3摄影机

500

BLACKMAGIC MICRO CINEMA CAMERA 2K

300

BLACKMAGIC POCKET CINEMA CAMERA 4K

500

3D EQUIPMENT

3D 器材

DAILY HK\$
每日价格 (港元)

MEDIA STATION

数据工作站

Mac Pro Station
(SAS interface / 6TB RAID)Mac Pro工作站
(SAS接口 / 6TB RAID硬盘存储)

3,000

CODEX Vault (Process/ Storage/ Archive)
HP LTO5 Tape driveCODEX读取 (加工 / 存储 / 归档)
HP LTO5磁带记录仪5,000
600

3ALITY DIGITAL TS RIG

3ALITY Technica TS-2 Rig w/SIP2100
3ALITY Technica TS-5 Rig w/SIP2100
3ALITY Technica SIP2100 (16:9 / 4:3)32,000
32,000
4,000

SCREENPLANE RIG

STEADY-FLEX Lightweight Rig For Handheld or Steadicam

26,000

ZOOM LENS

16-42MM T2.8 ANGENIEUX DP Zoom-PL Mount (Pair)
30-80MM T2.8 ANGENIEUX DP Zoom-PL Mount (Pair)4,000
4,000

35MM ANAMORPHIC LENSES
35MM 变形宽银幕镜头

DAILY HK\$
每日价格 (港元)

POWERSCOPE ANAMORPHIC LENSES POWERSCOPE 变形宽银幕镜头	CLOSE FOCUS TO 最近对焦距离	
24MM T2.0	NA	2,000
35MM T2.5	NA	2,000
50MM T2.5	NA	2,000
75MM T2.4	NA	2,000
100MM T3.2	NA	2,000

MASTER ANAMORPHIC LENSES MASTER 变形宽银幕镜头	CLOSE FOCUS TO 最近对焦距离	
28MM T1.9	2' 3"	2,900
35MM T1.9	2' 6"	2,900
40MM T1.9	2' 4"	2,900
50MM T1.9	2' 6"	2,900
60MM T1.9	3'	2,900
75MM T1.9	3'	2,900
100MM T1.9	3' 1"	2,900
135MM T1.9	3' 11"	2,900
180MM T1.9	5'	2,900

COOKE ANAMORPHIC / LENSES COOKE 变形宽银幕镜头	CLOSE FOCUS TO 最近对焦距离	
25MM T2.3	22"	2,900
32MM T2.3	22"	2,900
40MM T2.3	22"	2,900
50MM T2.3	22"	2,900
65MM T2.3 MACRO	5.5"	3,200
75MM T2.3	31"	2,900
100MM T2.3	35"	2,900
135MM T2.3	47"	2,900
180MM T2.3	64"	2,900
300MM T2.3	101.5"	2,900

35MM SPHERICAL LENSES
35MM 球面镜头

DAILY HK\$
每日价格 (港元)

ZEISS SUPREME PRIME LENSES (FULL FRAME) 蔡司SUPREME PRIME系列镜头(全片幅)	CLOSE FOCUS TO 最近对焦距离	
25MM T1.5 SP	10"	1,200
29MM T1.5 SP	13"	1,200
35MM T1.5 SP	10"	1,200
50MM T1.5 SP	18"	1,200
85MM T1.5 SP	33"	1,200
100MM T1.5 SP	45"	1,200

ZEISS COMPACT PRIME CP.3 LENSES (FULL FRAME) 蔡司COMPACT PRIME CP.3系列镜头(全片幅)	CLOSE FOCUS TO 最近对焦距离	
15MM T2.9 CP.3	12"	600
18MM T2.9 CP.3	12"	600
21MM T2.9 CP.3	10"	600
25MM T2.1 CP.3	10"	600
28MM T2.1 CP.3	10"	600
35MM T2.1 CP.3	12"	600
50MM T2.1 CP.3	18"	600
85MM T2.1 CP.3	39"	600
100MM T2.1 CP.3	30"	600
135MM T2.1 CP.3	39"	600

ARRI MASTER PRIME SERIES ARRI MASTER PRIME系列镜头	CLOSE FOCUS TO 最近对焦距离	
12MM T1.3 MP	16"	2,200
14MM T1.3 MP	14"	1,800
16MM T1.3 MP	14"	1,500
18MM T1.3 MP	14"	1,500
21MM T1.3 MP	14"	1,500
25MM T1.3 MP	14"	1,500
27MM T1.3 MP	14"	1,500
32MM T1.3 MP	14"	1,500
35MM T1.3 MP	14"	1,500
40MM T1.3 MP	16"	1,500
50MM T1.3 MP	20"	1,500
65MM T1.3 MP	2' 3"	1,500
75MM T1.3 MP	2' 9"	1,500
100MM T1.3 MP	3' 6"	1,500
135MM T1.3 MP	3' 3"	1,800
150MM T1.3 MP	4' 11"	1,800
100MM T2 MP Marco	13.75"	1,800

ARRI ULTRA PRIME LENSES 阿莱ULTRA PRIME定焦镜头	CLOSE FOCUS TO 最近对焦距离	
10MM T2.1 UP	15"	1,200
12MM T2 UP	12"	1,000
14MM T1.9 UP	9"	800
16MM T1.9 UP	9"	700
20MM T1.9 UP	12"	700
24MM T1.9 UP	12"	700
28MM T1.9 UP	12"	700
32MM T1.9 UP	15"	700
40MM T1.9 UP	18"	700
50MM T1.9 UP	24"	700
65MM T1.9 UP	27"	700
85MM T1.9 UP	36"	700
100MM T1.9 UP	36"	700
135MM T1.9 UP	60"	700
180MM T1.9 UP	102"	1,200

35MM SPHERICAL LENSES 35MM 球面镜头

DAILY HK\$
每日价格 (港元)

35MM HIGH SPEED LENSES 35MM 高速镜头	CLOSE FOCUS TO 最近对焦距离	
18MM T1.3 ZEISS LENS	10"	400
25MM T1.3 ZEISS LENS	10"	400
35MM T1.3 ZEISS LENS	14"	400
50MM T1.3 ZEISS LENS	28"	400
85MM T1.3 ZEISS LENS	36"	400
18-85MM T1.3 ZEISS Lens Set (5 pcs)		1,400
18-85MM T1.3 ZEISS 镜头装置 (5个)		

ZEISS 35MM PRIME LENSES 蔡司35MM 定焦镜头	CLOSE FOCUS TO 最近对焦距离	
10MM T2.1 ZEISS Lens	14"	950
12MM T2.1 ZEISS Lens	10"	600
14MM T2.1 ZEISS Lens	9"	600
16MM T2.1 ZEISS Lens	10"	400
20MM T2.1 ZEISS Lens	8"	400
24MM T2.1 ZEISS Lens	14"	400
32MM T2.1 ZEISS Lens	24"	400
40MM T2.1 ZEISS Lens	16"	400
50MM T2.1 ZEISS Lens	18"	400
85MM T2.1 ZEISS Lens	36"	400
100MM T2.1 ZEISS Lens	39"	400
135MM T2.1 ZEISS Lens	60"	400
180MM T3.0 ZEISS Lens	60"	400

35MM TELEPHOTO LENSES 35MM 长焦距镜头	CLOSE FOCUS TO 最近对焦距离	
200MM T1.8 CANON Lens	9'	700
300MM T2.8 CANON Lens	10'	700
300MM T3 ZEISS Lens	11.5'	700
400MM T2.8 CANON Lens	15'	700
500MM T4.5 CANON Lens	20'	700

35MM OPTICS ACCESSORIES 35MM光学附件

1.4 Times Lens Extender PL	1.4倍、增透镜-PL接环	300
2 Times Lens Extender PL	2倍、增透镜-PL接环	300
ANGENIEUX Optimo 2x Extender	ANGENIEUX Optimo 2倍增接环-PL接环	300

ARRI 35MM MACRO LENSES (W/54MM PL-MOUNT) 阿莱35MM微距镜头 (W/54MM PL-接环)	CLOSE FOCUS TO 最近对焦距离	
16MM T2.1 ARRI Macro Lens	6"	700
24MM T2.1 ARRI Macro Lens	7"	700
32MM T2.1 ARRI Macro Lens	8"	700
40MM T2.1 ARRI Macro Lens	10"	700
50MM T2.1 ARRI Macro Lens	8"	700
60MM T2.8 ARRI Macro Lens	10"	700
100MM T3 ARRI Macro Lens	14"	700
200MM T4.3 ARRI Macro Lens	23"	700

35MM ZOOM LENSES (W/54MM PL-MOUNT) 35MM 变焦镜头 (W/54MM PL-接环)

DAILY HK\$
每日价格 (港元)

ANGENIEUX OPTIMO ZOOM 安琴 OPTIMO 变焦镜头	CLOSE FOCUS TO 最近对焦距离	
15-40MM T2.6 ANGENIEUX Optimo Zoom	24"	3,500
17-80MM T2.2 ANGENIEUX Optimo Zoom	24"	5,000
19.5-94MM T2.6 ANGENIEUX Optimo Zoom	24"	5,000
24-290MM T2.8 ANGENIEUX Optimo Zoom	24"	5,000
28-340MM T3.2 ANGENIEUX Optimo Zoom	54"	5,000

ANGENIEUX OPTIMO DP ZOOM 安琴OPTIMO DP 变焦镜头	CLOSE FOCUS TO 最近对焦距离	
16-42MM T2.8 ANGENIEUX Optimo DP Zoom	30"	2,000
30-80MM T2.8 ANGENIEUX Optimo DP Zoom	30"	2,000

ALURA ZOOM ALURA 变焦镜头	CLOSE FOCUS TO 最近对焦距离	
15.5-45MM T2.8 Alura Zoom	24"	2,000
18-80MM T2.6 Alura Zoom	24"	2,000
45-250MM T2.6 Alura Zoom	48"	2,000

ANGENIEUX HR ZOOM ANGENIEUX HR 变焦镜头	CLOSE FOCUS TO 最近对焦距离	
17-102MM T2.9 ANGENIEUX HR Zoom	30"	1,800
25-250MM T3.5 ANGENIEUX HR Zoom	67"	1,400

OTHER ZOOM LENS 其他变焦镜头	CLOSE FOCUS TO 最近对焦距离	
18-90MM T2.3 Technovision Zoom	30"	1,800
20-100MM T3.1 Cooke Zoom	28"	1,000
25-250MM T4 Cooke Zoom	66"	1,000
150-600MM T4.5 CANON Zoom Motorized	120"	2,500

35MM SPECIAL PURPOSE LENSES 35MM 特殊用途镜头

T3.2 Optex Periscope Lens	Optex 潜望镜 T3.2	1,800
T5.4 Optex Borescope Lens	Optex 管窥镜 T5.4	1,800
Includes:	包括:	
14MM, 24MM, 35MM, 75MM Lenses	14MM, 24MM, 35MM, 75MM镜头	
Optex Lens Set (Periscope + Borescope)	Optex镜头套装 (Periscope + Borescope)	2,200
CENTURY Low Angle Prism	低角度棱镜	1,000
LENSBABY Movie Maker's Kit II	LENSBABY 特效镜套装	1,000
BELOMO 8MM Fisheye Lens	8MM 鱼眼镜	400

TILT FOCUS LENS 移轴镜对焦镜头

24MM T3.5 CANON Tilt Focus Lens	24MM T3.5 CANON 移轴镜	800
45MM T2.8 CANON Tilt Focus Lens	45MM T2.8 CANON 移轴镜	800
90MM T2.8 CANON Tilt Focus Lens	90MM T2.8 CANON 移轴镜	800
CANON Tilt Focus Lens Set (3 Pcs)	CANON 移轴镜套装 (3个)	1,800
Incl.: 24MM / 45MM / 90MM	包括: 24MM / 45MM / 90MM	
SAMUELSON Shift & Tilt Lens Set	SAMUELSON 移轴镜套装	2,500
Incl.: 28MM T3.5 / 35MM T2.8 / 90MM T2.8	包括: 28MM T3.5 / 35MM T2.8 / 90MM T2.8	

VIDEO & MONITORING

视频监控器、录像机

DAILY HK\$
每日价格 (港元)

HD MONITOR	高清监视器	
BLACKMAGIC Smartcope Duo 4K Rack-Mount Monitor	BLACKMAGIC Smartcope Duo 4K 监视器	200
PANASONIC 21" HD LCD Monitor (HD/SDI)	PANASONIC 21寸高清 LCD (HDSDI) 监视器	1,000
JVC 24" HD LCD Monitor (HDSDI / SD)	JVC 24寸 高清 LCD (HDSDI / SD) 监视器	900
JVC / PANASONIC 17" HD LCD Monitor (HDSDI / SD)	JVC / PANASONIC 17寸 高清 LCD(HDSDI / SD) 监视器	700
SMALLHD 7" 702 Bright Full HD Monitor	SMALLHD 7寸 LCD / Full HD 监视器	400
SMALLHD 7.7" AC7 OLED SDI Monitor	SMALLHD 7.7寸 OLED SDI 监视器	500
SMALLHD 7.7" DP7 PRO LCD Monitor	SMALLHD 7.7寸 PRO LCD 监视器	400
TVLOGIC 5.8" LCD Monitor LFM	TVLOGIC 5.8" LFM 监视器	400
TVLOGIC 7" LCD Monitor SRM / LVM	TVLOGIC 7" SRM / LVM 监视器	600
TVLOGIC 17" LCD Monitor LVM	TVLOGIC 17" LVM 监视器	1,200
SWIT 7" LCD Monitor S-1071H	视威 7寸SDI / HDMI S-1071H 视频监视器	400
SWIT 9" LCD Monitor S-1090H	视威 9寸 SDI / HDMI S-1091H 视频监视器	600
SONY 17" OLED Monitor PVM-A170	索尼 17寸 OLED PVM-A170 监视器	1,200
SONY 25" OLED Monitor PVM-A250	索尼 25寸 OLED PVM-A250 监视器	1,500
ZUNZHENG 7" LCD Monitor TM070	尊正 7寸 LCD TM070 监视器	500
ZUNZHENG 17" OLED Monitor CM172	尊正 17寸 OLED CM172 监视器	1,200
ZUNZHENG 21" LED Monitor BM210	尊正 21寸 LED BM210 监视器	1,000
ZUNZHENG 25" OLED Monitor CM250	尊正 25寸 OLED CM250 监视器	1,500
RAINBOW HD 7" Transvideo Monitor	RAINBOW HD 7寸 Transvideo 监视器	1,000
NAVTECH Rover Wireless Monitor	NAVTECH Rover 无线监视器	1,500
LEADER Waveform Monitor	LEADER Waveform 示波器	2,000
3D MONITOR		
VIDEO SWITCHER 16X16 HDSDI		300
10" TRANSDVIDEO 3D Monitor (DUAL HDSDI)	10寸 3D立体监视器	1,800
12" TRANSDVIDEO 3D Monitor (DUAL HDSDI)	12寸 3D立体监视器	1,800
46" JVC LCD Monitor w/Display Port	46寸 3D立体监视器	2,000

VIDEO & MONITORING

视频监控器、录像机

DAILY HK\$
每日价格 (港元)

RECORDER	记录仪	
ATOMOS 7" Shogun Inferno 4K HDMI / SDI Recording Monitor	ATOMOS 7寸 Shogun Inferno 4K HDMI / SDI 监视器	400
ATOMOS Sumo 19" HDR High Brightness Monitor	ATOMOS Sumo 19" HDR 监视器	700
AJA Ki Pro HD Recorder	AJA Ki Pro 硬盘监视器	500
BLACKMAGIC Video Assist 4K 7" HDMI / 6G-SDI Recording Monitor	BLACKMAGIC 4K 记录仪	500
Sound Devices PIX 240 (HDSDI / HDMI)	Sound Devices PIX 240 (HDSDI / HDMI) 记录仪	1,000
Video Devices PIX-E5 Recorder	Video Devices PIX-E5 Recorder 记录仪	1,000
Video Devices PIX-E5 Recorder		
HD VIDEO WIRELESS TRANSMITTER / RECEIVER	无线高清发射 / 接收器	
VAXIS THOR 2000 SDI / HDMI Transmitter / Receiver	威固 THOR 2000 高清发射器 及接收器	1,200
VAXIS THOR 2000 SDI / HDMI Receiver	威固 THOR 2000 高清接收器	700
VAXIS STORM 2000 Transmitter	威固 STORM 2000 高清发射器	1,200
VAXIS STORM 2000 Receiver	威固 STORM 2000 高清接收器	700
VAXIS STORM 1000+ Transmitter / Receiver	威固 STORM 1000+ 高清发射器及接收器	1,000
VAXIS STORM 1000+ Receiver	威固 STORM 1000+ 高清接收器	600
VAXIS STORM 1000+	威固 STORM 1000+	1,000
MINI Transmitter / Receiver	迷你高清发射器及接收器	
VAXIS STORM 1000+ MINI Receiver	威固 STORM 1000+ 迷你高清接收器	600
CVW 300 Pro Wireless HD Video Transmitter / Receiver (HDMI / SDI)	CVW 无线发射 / 接收器	1,000
TERADEK Bolt 300 HD-SDI & HDMI Transmitter / Receiver	TERADEK 无线发射 / 接收器	1,000
TERADEK Cube-355 HD-SDI Decoder with WiFi	TERADEK Cude 无线图传 接收端 (HDSDI / WIFI)	600
TERADEK Serv Pro SDI / HDMI Video		800
TEREDEK Link Dual-Band Wi-Fi Router		200
CONVERTER	转换器	
SWIT S-9204 SDI Multi Viewer and Switcher		400
SWIT S-4604 HDMI To SDI Converter	SWIT S-4604 HDMI 转SDI 转换器	100
AJA HD To SD Down-Converter		300
AJA 信号转换器	AJA Lut Box	300
AJA HD5DA 1X4 HD / SDI Distribution Adaptor		400
SWIT S-9204 4 SDI Multiviewer and Switcher	SWIT 高清四画面分割 / 主监切换	200
BLACKMAGIC Video Hub w/Smart Control Video Switcher		500
VIDEO MIXER	视像混合器	
PANASONIC HD Video Mixer AW-HS50 (720P)		1,500

CAMERA ACCESSORIES

摄影机附件

DAILY HK\$
每日价格 (港元)

BATTERIES AND CHARGES 电池充及电器

14.8V V-Mount Battery	14.8伏特 V口电池	80
14.8V V-Mount Battery Charger	14.8伏特 V口电池充电器	140
12V 10AMP Battery	12伏特 10安电池	60
12V Battery Charger	12伏特 电池充电器	60
24V 10AMP Battery	24伏特 10安电池	60
24V Battery Charger	24伏特 电池充电器	110
28V Block Battery With Charger	28伏特 电池连充电器	160

GRIPS AND HANDLES 手柄及把手

ARRI Handheld Shoulder Set S-2 /S-3/ S-4	阿莱肩架 (套装) S-2 /S-3 /S-4	250
ARRI Right Hand Grip	阿莱把手 (右)	50
Handheld Set (Other Brand)	肩架	200

HEADS 云台

ARRI Gear Head	阿莱船型云台	1,590
PANAHEAD Geared Head	PANAHEAD 船型云台	1,540
ARRI 150H Fluid Head	阿莱 150H 液压云台	400
SACHTLER 7+7 Fluid Head	SACHTLER 7+7 液压云台	400
CARTONI Maxima Fluid Head		800
O'CONNOR 2575 B/C/D Fluid Head	O'CONNOR 2575 B/C/D 液压云台	780
O'CONNOR 120 EX Fluid Head	O'CONNOR 120 重型云	1,200
CARTONI Lambda Head	CARTONI Lambda Head 液压云台	800
RONFORD 2-Axis Head (F7)	RONFORD 2-轴头 (F7)	640
RONFORD 3-Axis Head (F7)	RONFORD 3-轴头 (F7)	1,200
WEAVER Steadman 2-Axis Head	WEAVER Steadman 二轴云台	870
WEAVER Steadman Roll Axis Module	WEAVER Steadman 第三3轴	510
CARTONI C40 Dutch Head	CARTONI C40 Dutch 云台	350
DENZ BOGIE Swing Head	DENZ BOGIE 摇摆云台	500
MOTORIZED Swing Head	机动摇摆云台	700
TANGO Head	TANGO 云台	500

MOUNTS AND BASES 支架及底座

ARRI Bridge Plate	阿莱底板	100
DENZ Tilt Plate	DENZ 倾斜底板	200
GF-Low Rocker	低角度摇摆云台	350
Low Angle Rock	低角度摇摆云台	200
Camera D Bag	D袋	150
Steadibag / Saddle Bag	马鞍袋	120

CAMERA ACCESSORIES

摄影机附件

DAILY HK\$
每日价格 (港元)

MATTE BOXES AND SUNSHADES 遮光罩及附件

4" x 5.650" Clip On Matte Box - 2Stages	4寸 x 5.650寸 夹式遮光斗 - 两夹片	200
4" x 5.650" Clip On Matte Box - 3Stages	4寸 x 5.650寸 夹式遮光斗 - 三夹片	200
6.6" x 6.6" ARRI Matte Box LMB-6	6.6寸 x 6.6寸 阿莱遮光斗 LMB-6	200
6.6" x 6.6" ARRI Matte Box MB-14	6.6寸 x 6.6寸 阿莱遮光斗 MB-14	500
3" x 3" ARRI Clip On Matte Box	3寸 x 3寸 阿莱 夹式遮光斗	80
4" x 4" ARRI Matte Box	4寸 x 4寸 阿莱 遮光斗	150
4" x 5.650" Matte Box MB-18	4寸 x 5.650寸 夹式遮光斗 MB-18	180
Sunshade Extension	遮飞	150
Reducer Frame 6.6" x 6.6" to 4" x 5.650"	滤镜适配器 6.6寸 x 6.6寸 转 4寸 x 5.650寸	70

FOLLOW FOCUS AND VIEWFINDER 跟焦器及取景器

ARRI Eyepiece Leveler	阿莱目镜撑杆	50
ARRI Weather Protector	阿莱防雨套	100
ARRI Director Viewfinder	阿莱导演取景器	500
KISH UDF Ultimate Director Viewfinder with Video	KISH UDF 导演取景器含监视系统	1,200
ARRI Universal Follow Focus System (FF3 / FF4)	阿莱跟焦器 (FF3/FF4)	250
ARRI Follow Focus Extension Control	阿莱跟焦伸缩管	30

TRIPODS 三脚架

RONFORD Tripod Tall (Mitchell / Bowl)	RONFORD 高三脚架 (平底/圆底)	120
RONFORD Tripod Short (Mitchell / Bowl)	RONFORD 低三脚架 (平底/圆底)	120
RONFORD Billet Bazooka	RONFORD 重型多节脚架	2,300
Bazooka	重型多节脚架	600
MITCHELL HI / LOW HAT	平底高/低香炉脚	100
HI-HAT (150MM Bowl)	圆底香炉脚 (150MM)	100
Roller Spreader	活动三脚架	250
Metal Spreader	金属三脚架	60
Ladder Pod	梯型脚架	700
Tri-Head	三角香炉脚	400

SPRAY DEFLECTORS 电动防雨屏

ACTION DISC Rain Deflector (Dia. For Prime Lenses) (4" x 4")	电动防雨屏 (定焦镜头适用)	1,000
SPRAYOFF Rain Deflector Mini (6.6" x 6.6")	电动防雨屏MK2	1,500
FILMOTECHNIC Zero Rain Deflector	FILMOTECHNIC Zero 电动防雨屏	1,500

LENS FILTERS
镜头滤光镜

LENS FILTERS
镜头滤光镜

DAILY HK\$
每日价格 (港元)

DESCRIPTION	说明	3" x3"	4" x4"	4" x5.650"	4.5"	6.6" x6.6"	138MM
85 / 85N3 / 85NB / 85N9 / 85NB	85 / 85N3 / 85NB / 85N9 / 85NB 调色温	30	40	60	40	70	60
Black Pro Mist 1/8-5	黑点1/8-5柔光镜	30	40	40	60	70	60
Classic Black Soft	经典黑柔光	NA	NA	60	NA	70	NA
Classic Soft 1/8-2	经典柔光 1/8-2	NA	NA	60	NA	70	NA
Clear	保护镜	30	40	60	40	70	60
Close Up + Lenses 1/2-3	1/2-3 倍近摄镜	NA	NA	NA	NA	NA	60
CC Color Compensating	颜色补偿	30	40	60	40	70	60
Color Grad* Blue 1-5	渐变* 蓝色1-5	30	65	80	NA	100	NA
Color Grad* Cool Blue 1-5	渐变* 冷蓝色 1-5	30	65	80	NA	100	NA
Color Grad* Coral 1/8-5	渐变* 珊瑚色 1/8-5	30	65	80	NA	100	NA
Color Grad* Cyan1-5	渐变* 青绿色 1-5	30	65	80	NA	100	NA
Color Grad* Green 1-5	渐变* 绿色 1-5	30	65	80	NA	100	NA
Color Grad* Magenta 1-5	渐变* 洋红色 1-5	30	65	80	NA	100	NA
Color Grad* Pink 1-5	渐变* 粉红色 1-5	30	65	80	NA	100	NA
Color Grad* ND 0.3-0.9	渐变* 灰 0.3-0.9	30	65	80	NA	100	NA
Color Grad* Red 1-5	渐变* 红色 1-5	30	65	80	NA	100	NA
Color Grad* Sunset 1-3	渐变* 日落色	30	65	80	NA	100	NA
Color Grad* Yellow 1-5	渐变* 黄色 1-5	30	65	80	NA	100	NA
Color Grad* Chocolate 1-3	渐变* 巧克力色 1-3	30	65	80	NA	100	NA
Color Grad* Tobacco 1-3	渐变* 烟草色 1-3	30	65	80	NA	100	NA
Combin Polarising 85 POL	85 偏光镜	30	40	60	40	70	60
Combin Polarising 85B POL	85B 偏光镜	30	40	60	40	70	60
Coral Filter 1/8-5	珊瑚色	30	40	60	40	70	60
Fluorescent Light FL-D	荧光白 FL-D	30	40	60	40	70	60
Fluorescent Light FL-B	荧光蓝 FL-B	30	40	60	40	70	60
FOG Effect Filter 1/8-5	雾镜 1/8-5	30	40	60	40	70	60
Glimmer Glass 1/8, 1/4, 1/2, 1, 2, 3		NA	NA	60	NA	70	NA
Hollywood Blackmagic 1/2, 1, 2		NA	NA	60	NA	70	NA
IRND Neutral Density 3/6/9	IR灰镜 3/6/9	30	40	60	40	70	60
Low Contrast Filter 1/8-5	低反差滤镜 1/8-5	30	40	60	40	70	60
LL-D	LL-D减光镜	30	40	60	40	70	60
ND Neutral Density 3/6/9	灰镜 3/6/9	30	40	60	40	70	60
Polarising Filter	偏光镜	30	40	60	40	70	60
Pro Mist	白点柔光镜	30	40	60	40	70	60
Sepia 1/2	1/2褐色	30	40	60	40	70	60
Soft Contrast 1-5	柔和反差镜 1-5	30	40	60	40	70	60
Softnet Black 1-4	黑柔网镜 1-4	30	40	60	40	70	60
Softnet White	白柔网镜	30	40	60	40	70	60
Softnet Red	红柔网镜	30	40	60	40	70	60
Softnet Skinstone	肤色柔网镜	30	40	60	40	70	60
Soft FX 1/2-5	柔光镜 1/2-5	30	40	60	40	70	60
STD. Color	颜色	30	40	60	40	70	60
STD. Color 81A	颜色 81A	30	40	60	40	70	60
STD. Color 81B	颜色 81B	30	40	60	40	70	60
STD. Color 85	颜色 85	30	40	60	40	70	60
Star Effect Filter	星镜	30	NA	NA	50	NA	70
Ultra Contrast 1/8-5	超反差镜 1/8-5	30	40	60	40	70	60

CAMERA ACCESSORIES 摄影机附件

DAILY HK\$
每日价格 (港元)

REMOTE PRODUCTS AND METER 遥控产品		
PRESTON Light Ranger 2 (The Item Including Dovetail Clamp, Video Overlay and Serial Cable)		2,000
PRESTON FI+Z Wireless Remote Control System (Hand Unit 3 / MDR 3)		2,500
Includes:	包括:	
1 G4 FI Control	1个 对焦、光圈控制	
1 MICROFORCE Digital 2 Zoom Control	1个 变焦控制	
3 PRESTON DM Digital Motor	3个 数码马达	
1 MDR-3 Motor Driver	1个 MDR-3 驱动器盒 (供三个摩打使用)	
Cmotion Compact One Hand Unit	无线跟焦器	1,100
BARTECH Wireless Control Focus	无线跟焦器	1,000
Includes:	包括:	
1 Control Transmitter Module	1个 控制连发射	
1 Receiver	1个 接收器	
1 Focus Servo Motor with Bracket	1个 跟焦马达	
PRESTON FI+Z Radio Remote Lens Control System	PRESTON FI+Z 无线镜头控制系统	1,800
Includes:	包括:	
1 FI+Z Control	1个 对焦、光圈、变焦控制	
1 V+F Microforce Zoom Control	1个 变焦控制	
2 DM-1 Digital Motor	2个 数码马达	
1 MDR-2 Digital River	1个 MDR-2 驱动器盒	
1 MDR-4 Digital River	1个 MDR-4 驱动器盒	
SCORPIO Wireless Remote Control System	SCORPIO无线遥控系统	1,800
Includes:	包括:	
1 FI+Z Control	1个 FI+Z 控制	
3 SCORPIO Digital Motors	3个 SCORPIO马达	
1 Radio Transmitter	1个 无线电发信器	
1 Radio Receiver	1个 无线电接收器	
1 Motor Driver Box	1个 马达驱动盒	
MICRO Force Zoom Control with Motor	变焦控制	350
HEDEN Focus Control with Motor	HEDEN对焦 马达对焦控制	300
HEDEN Zoom Control with Motor	HEDEN变焦 马达变焦控制	300
HEDEN M26T Servo Motor	HEDEN M26T 伺服马达	150
HEDEN M26P Servo Motor	HEDEN M26P 伺服马达	150
Cmotion Wireless FIZ (3m / 3 motors)	马达控制器连HEDEN马达 (3m / 3个)	1,800
Cmotion Wireless FIZ (8m / 6 motors)	马达控制器连HEDEN马达 (8m / 6个)	3,600
ARRI Wireless Compact Unit WCU-4 (FIZ)	ARRI WCU-4无线跟焦器	1,800
Cine Tape Measure	Cine Tape 测距仪	1,000

STEADICAM 稳定拍摄系统

DAILY HK\$
每日价格 (港元)

STEADICAM ULTRA CINE STABILIZING SYSTEM	斯坦尼康ULTRA CINE 稳定拍摄系统	6,000
Includes:	包括:	
1 Operation Vest	1个 工作衣	
1 Adjustable Stabilizer Support Arm	1个 可调稳定臂	
1 Camera Mounting Assembly with Viewing Monitor	1个 摄影机支架附带监视器	
1 Side-To-Side Balancing Camera Base Plate Assembly	1个 平衡摄影机地板	
1 Telescoping Balance Post	1个 远拍平衡杆	
1 Docking Bracket	1个 泊架	
4 14.8V V-Mount Battery	4个 14.8伏特 V口电池	
1 14.8V V-Mount Battery Charger	1个 14.8伏特 V口电池充电器	
MKV NEXUS STABILIZING SYSTEM	MKV NEXUS 稳定拍摄系统	6,000
Includes:	包括:	
1 Operation Vest	1个 工作衣	
1 Adjustable Stabilizer Support Arm	1个 可调稳定器支持臂	
1 Camera Mounting Assembly with Viewing Monitor	1个 摄影机支架附带监视器	
1 Side-To-Side Balancing Camera Base Plate Assembly	1个 平衡摄影机地板	
1 Telescoping Balance Post	1个 可延伸平衡杆	
1 Docking Bracket	1个 停靠托架	
4 14.8V V-Mount Battery	4个 14.8伏特 V口电池	
1 14.8V V-Mount Battery Charger	1个 14.8伏特 V口电池充电器	
MKV EVOLUTION STABILIZING SYSTEM (MODULAR DESIGN)	MKV EVOLUTION 稳定拍摄系统 (组合设计)	6,000
Includes:	包括:	
1 Operation's Vest (AP Back Mount Vest)	1个 工作衣 (AP 后背背心)	
1 Adjustable Stabilizer Support Arm	1个 可调稳定器支持臂	
1 Camera Mounting Assembly with Viewing Monitor	1个 摄影机支架附带监视器	
1 Side-To-Side Balancing Camera Base Plate Assembly	1个 平衡摄影机地板	
1 Telescoping Balance Post	1个 可延伸平衡杆	
1 Docking Bracket	1个 停靠托架	
4 14.8V V-Mount Battery	4个 14.8伏特 V口电池	
1 14.8V V-Mount Battery Charger	1个 14.8伏特 V口电池充电器	
STEADICAM ACCESSORIES 稳定拍摄系统附件		
Stadicam Low Mode Bracket	稳定拍摄系统附件	100
GYRO K6 / GYRO K8	GYRO K6 / GYRO K8	600

STEADICAM 稳定拍摄系统

DAILY HK\$
每日价格 (港元)

PHOTO: MOVIE MASTER LIGHTING & GENERATIONS
图片：照明和发电机

HANDHELD STABILIZER 手提稳定器

Easyrig Cinema 3 / Vario 4	Easyrig 背负鱼杆	1,000
TILTA Armor-Man 2.0	TILTA 铁甲战士 2.0	1,200
Ready Rig		1,500
FREEFLY MOVI M10 Stabilizer	FREEFLY MOVI M10 电子稳定器	3,000
FREEFLY MOVI M15 Stabilizer	FREEFLY MOVI M15 电子稳定器	4,500
FREEFLY MOVI PRO Hand Held Bundle	FREEFLY MOVI PRO 电子稳定器	4,500
Alpha 1A Wheel Control For MOVI PRO	Alpha 1A 控制轮	1,500
FLOWCINE Serene	FLOWCINE 减震器	600
TYLER Mini Gyro	TYLER 避震阻尼器	3,000
DJI RONIN	DJI RONIN 电子稳定器	1,500
DJI RONIN 2	DJI RONIN 2 电子稳定器	4,500
DJI Master Wheels 3-Axis		4,500
DJI Force Pro		1,000
FLOWCINE Gravity One Camera Stabilizer	FLOWCINE 稳定器	1,000
FLOWCINE Black Arm	FLOWCINE (黑臂) 稳定器	4,000
TILTA Shock Absorption Arm	TILTA (减震臂) 稳定器	3,000

HANDSFREE TRANSPORTER 智能拍摄车

Handsfree Transporter-Lean Steering	智能拍摄车 - 倾身控制	5,000
Includes:	包括：	
On-Broad Batteries	电池	
Steadicam Hardmount	斯坦尼康接架	
Special Wheel Set (Indoor / Off-road / Grass)	轮胎 (室内/野外/草地)	
Optional Accessories:	可选配件：	
Batteries set	电池	1,000
Out-Broad Charger	充电器	200

CAR MOUNTS EQUIPMENT 影机汽车架

MO KIT Camera Car Mount	MO KIT 摄影机汽车支架	600
EGRIPMENT Super Grip	EGRIPMENT 摄影机汽车支架	200
FILMTECHNISCHE Universal Car Mount	FILMTECHNISCHE 摄影机汽车支架	200
MATTHEWS Head Mount Kit	MATTHEWS 摄影机车头支架	800
MATTHEWS Side Mount Kit	MATTHEWS 摄影机汽车架	200
MODERN Deluxe Dish	云台	200
Camera Wedge Plate 0 to 90 Degrees	翘板	200
Speed Rail Door Mount Kit	摄影机车窗支架	200
4.5" Suction Cup	4.5寸吸盘	60
6" Suction Cup	6寸吸盘	60
10" Suction Cup	10寸吸盘	80

UNDERWATER HOUSING 潜水摄影机罩

SCUBACAM Underwater Housing	SCUBACAM 潜水摄影机罩	5,000
-----------------------------	-----------------	-------



LIGHTING & GENERATIONS

LIGHTING EQUIPMENT
照明设备

DAILY HK\$
每日价格 (港元)

LIGHTING EQUIPMENT
照明设备

DAILY HK\$
每日价格 (港元)

HMI PAR - FLICKER FREE SET

高温直射镡灯

ARRISUN 575W	700
ARRISUN 1.2K	1,000
ARRISUN 2.5K	1,200
ARRISUN 4KW	1,600
ARRISUN 6KW	2,500
ARRISUN 12KW	4,000
ARRILUX 125W (AC / DC)	400
ARRILUX 400W (AC / DC)	950
ARRISUN 200W (AC / DC)	700
(Above Items Including Bulb, Cable, Ballast)	

HMIARRI "M" SERIES

高温多面反射镡灯 (阿莱-M系列)

ARRI M8 800W	900
ARRI M18 (1.2KW)	1,100
ARRI M18 (1.8KW)	1,200
ARRI M40 (2.5KW)	1,400
ARRI M40 (4KW)	1,600
ARRI M90 (6KW)	3,200
ARRI M90 (9KW)	3,600
ARRIMAX 12K/18K (12KW)	4,500
ARRIMAX 12K/18K (18KW)	5,000
(Above Items Including Bulb, Cable, Ballast)	

K 5600 ALPHA HMI LIGHT

K 5600 ALPHA 高温灯

Alpha 6/9K (6KW)	3,200
Alpha 6/9K (9KW)	3,600
Alpha 18K	5,000
(Above Items Including Bulb, Cable, Ballast)	

HMI FRESNEL - FLICKER FREE SET

高温聚光镡灯

ARRI 200W	400
ARRI 575W	550
ARRI 1.2K	650
ARRI 2.5K	900
ARRI 4KW	1,300
ARRI 6KW	2,000
ARRI 12KW	3,100
ARRI 18KW	4,000
(Above Items Including Bulb, Cable, Ballast)	

HMI BEAM LIGHT

高温束光灯

MOLE-RICHARDSON 24"	MOLE-RICHARDSON 24寸	2,000
HMI Molebeam 4K Daylight Projector	4K高温束光灯	

X-LITE - FLICKER FREE

高温X-LITE系列影子灯

1.2KW	1,200
2.5KW	1,200
4KW	1,600
6KW	2,500
(Above Items Including Bulb, Cable, Ballast)	

JOKER BUG

高温泛光日光灯

200W (AC / DC)	800
400W (AC / DC)	1,000
800W (AC)	1,000
(Above Items Including Bulb, Cable, Ballast)	
JOKER 400/800W Speed Ring	30

XENON

氙气灯

4KW	2,300
-----	-------

LIGHTNING STRIKE

闪电灯

40KW Lighting Strike	40千瓦闪电灯	2,400
70KW Lighting Strike	70千瓦闪电灯	2,800

CARBON ARCS

碳精灯

Carbon Arc Brute Set	碳精灯设备	2,000
Set Includes:	设备包括:	
Grid, Frame, Smoke Stack, Gel Frame	网格、框架、烟囱、Gel框架	
Optional : Pairs of Carbons For Brute Moar	可选组件: 破支一对	100
E&E AC/DC Rectifier	E&E 交流/直流整流器	750

TUNGSTEN LAMPS (FRESNEL)

低温聚光灯 (Fresnel)

100/200 Pepper	100/200瓦聚光灯	45
300/500 MIZAR	300/500瓦聚光灯	55
650W Spotlight	650瓦聚光灯	65
1KW Spotlight	1千瓦聚光灯	100
2KW Spotlight	2千瓦聚光灯	150
5KW Spotlight	5千瓦聚光灯	300
10KW Spotlight	10千瓦聚光灯	600
10KW Big Eye Spotlight	10千瓦BIG EYE聚光灯	500
ARRI T-12 w/Dimmer	阿莱T系列1.2千瓦钨丝聚光灯	650
ARRI 20KW Spotlight w/Dimmer	阿莱20千瓦聚光灯附带调光器	3,000
ARRI 24KW Spotlight w/Dimmer	阿莱24千瓦聚光灯附带调光器	3,500

DEDOLIGHT

特图力

DEDOLIGHT 150W (3 Lamps/Set)	150瓦特图力 (每套3支灯)	500
DEDOLIGHT 200W HMI Lite Kit (Set)	200W 高温日光灯 (套装)	550
DEDOLIGHT 400W HMI Lite Kit (Set)	400W 高温日光灯 (套装)	650
DEDOLIGHT DLH-400SDT Spotlight (Set)	特图力400瓦高温柔光灯 (套装)	700

LIGHTING EQUIPMENT

照明设备

DAILY HK\$
每日价格 (港元)

TUNGSTEN LAMPS (OPEN FACE)		低色温散光灯 (Open Face)	
1KW Molette	1 千瓦Molette	50	
2KW Molette	2 千瓦Molette	55	
3KW Nooklite	1 千瓦Nooklite	65	
2KW Nooklite	2 千瓦Nooklite	75	
1KW CYC Lite	1 千瓦CYC Lite	50	
1KW TOTA Light	1 千瓦TOTA Light	50	
2KW Blonde	2 千瓦黄头灯	60	
650W MR TEENIE	650瓦MR TEENIE	50	
650W One-Light Nooklite	650瓦单灯Nooklite	50	
800W Redhead	800瓦红头灯	50	
Molegator Grip with Socket (Max 500W)	Molegator夹, 附带插座 (最大500瓦)	65	

TUNGSTEN LAMPS (SOFT LIGHT)		低色温柔光灯	
1KW Soft Light	1千瓦柔光灯	150	
2KW Soft Light	2千瓦柔光灯	200	
4KW Soft Light	4千瓦柔光灯	300	
5KW Soft Light	5千瓦柔光灯	350	
3KW Barger Lite DV3	3千瓦柔光灯	500	
MR 2KW Space Lite	MR 2千瓦灯笼灯	300	
MR 6KW Space Lite	MR 6千瓦灯笼灯	500	
MR 12KW Space Lite	MR 12千瓦灯笼灯	850	

FAY AND PAR LAMPS		聚射灯具	
1000W 6-Light Molepar (Maxibrute)	1000瓦聚射灯6头 (Maxibrute)	250	
1000W 7-Head Lite (RUBY 7)	1000瓦聚射灯7头	450	
1000W 9-Light Molepar	1000瓦聚射灯9头	900	
1000W / PAR64	1000瓦 / 标准 64	100	
1000W 12KW- Light Dino	1000瓦聚射灯 12头	1,200	
1000W 24KW- Light Dino	1000瓦聚射灯 24头	2,000	

LIGHTING ACCESSORIES

灯 - 配件

DAILY HK\$
每日价格 (港元)

SPEED RING		
165MM - 195MM Speed Ring		30
315MM - 495MM Speed Ring		50
540MM - 740MM Speed Ring		100
230MM TO 410MM Adjustable Speed Ring		100
305MM TO 545MM Adjustable Speed Ring		100
CHIMERA		
CHIMERA Lightbank (Size: XXS / XS / S)		300
CHIMERA Lightbank (Size: M)		400
CHIMERA Lightbank (Size: L)		500

FLORESCENT LIGHTING	灯管灯	
24" 2 Bank KINO FLO	24寸 2 管	200
24" 4 Bank KINO FLO	24寸 4 管	250
48" 2 Bank KINO FLO	48寸 2 管	250
48" 4 Bank KINO FLO	48寸 4 管	350
48" 8 Bank KINO FLO	48寸 8 管	600
48" 10 Bank KINO FLO	48寸 10 管	600
24" Single Bank KINO FLO	24寸 1 管	200
48" Single Bank KINO FLO	48寸 1 管	200
72" 16 KINO FLO Blanket Lite	72寸 16 管 Blanket Lite	1,800
9" 12V Mini-Flo (Set of 2)	9寸 12伏特 Mini-Flo (2头)	250
15" 12V Mini-Flo (Set of 2)	15寸 12伏特 Mini-Flo (2头)	300
BARFLY 100 Kit		300
BARFLY 200 Kit		400
BARFLY 400 Kit		400
KINO FLO Karnio	环管柔光灯	500
KINO FLO Select LED 30		900
Micro Flo 6" x 2 And 4" x 2 (Set)	套装微型管灯6寸2支 / 4寸2支	300
Papa Beam 400		350
Vista Beam 600		650

LIGHTING ACCESSORIES 灯 - 配件

DAILY HK\$
每日价格 (港元)

LED

ASTRA Litepanels 1X1 (3200 / 5600K)	400
C-700RSV (19") LED Lite	350
C-1500RSV (25") LED Lite	500
Celeb 201	400
Celeb 401	600
Celeb 401Q	600
Creamsource Bender Spot (Gaffer Kit)	1,000
DMG Lumière Maxi	2,000
DMG Lumière SL1 MIX	800
DMG Lumière MINI MIX	600
FALCON SO-28TD (Ø300MM) LED Lite	锐鹰圆型 LED (直径300MM) 250
FALCON SO-148TD (Ø1000MM) LED Lite	锐鹰圆型 LED (直径1000MM) 400
FALCON RX-12TD LED Lite (460MM X 320MM)	锐鹰布灯 (460MM X 320MM) 250
FALCON RX-18TD LED Lite (610MM X 460MM)	锐鹰布灯 (610MM X 460MM) 320
FALCON RX-24TDX LED Lite (625MM X 625MM)	锐鹰布灯 (625MM X 625MM) 350
FALCON RX-36TDX LED Lite (1210MM X 460MM)	锐鹰布灯 (1210MM X 460MM) 500
FOMEX Flexible LED FL600 1ft X 1ft	FOMEX 1尺 X 1尺可弯曲LED 400
FOMEX Flexible LED FL1200 2ft X 1ft	FOMEX 2尺 X 1尺可弯曲LED 700
Litepanel 1X1 (5600K)	350
Litepanel 1X1 (3200 / 5600K)	400
Litepanel Mini	300
LIGHTSTAR L-MAT LED (Bi Colour) - 4 Heads	莱星达 L-MAT 可调色温 LED灯- 4头 350
LIGHTSTAR L-MAT LED (Bi Colour) - 9 Heads	莱星达 L-MAT 可调色温 LED灯- 9头 500
LIGHTSTAR L-MAT LED (Bi Colour) - 12 Heads	莱星达 L-MAT 可调色温 LED灯- 12头 850
LISHUAI C-208A LED Lite (204MM X 124MM)	利帅长方形LED (204MM X 124MM) 250
LISHUAI C-218A LED Lite (284MM X 104MM)	利帅长方形LED (284MM X 104MM) 250
LED Par (PY5403)	染色灯 100
PHILIPS 300S LED Lite (Daylight)	350
ROSCO Litepad (Set)	500

ARRI SKYPANEL LED SOFTLIGHT

ARRI Skypanel S30-C	700
ARRI Skypanel S60-C	1,000
ARRI Skypanel S120-C	1,400
ARRI Skypanel S360-C	3,600

ADDITIONAL ACCESSOIRES FOR SKYPANEL

Wireless DMX Control (IPAD with Luminair 3 apps)	1,000
DoPchoice 40 SnapGrid (Skypanel S30/S60/S120)	300
Skypanel Remote	100
CHIMERA Lightbank with Frame For Skypanel	350
CHIMERA (S) Soft Egg-Crate (For Skypanel S30-C)	100
CHIMERA (M) Soft Egg-Crate (For Skypanel S60-C)	100
CHIMERA (L) Soft Egg-Crate (For Skypanel S120-C)	100
Skypanel S30-C Snapbag with Diffusion Cloth	200
Skypanel S30-C Snapbag (For Snapbag)	100
Skypanel S60-C Snapbag with Diffusion Cloth	200
Skypanel S60-C Snapbag (For Snapbag)	100
Skypanel S120-C Snapbag with Diffusion Cloth	200
Skypanel S120-C Snapbag (For Snapbag)	100
Skypanel S360-C Snapbag with Diffusion Cloth	300
Skypanel S360-C Snapbag (For Snapbag)	150

LIGHTING ACCESSORIES 灯 - 配件

DAILY HK\$
每日价格 (港元)

ARRI L-SERIES

阿莱 - L系列

ARRI L5-C Fresnel 115W	350
ARRI L7-C Fresnel 220W	500
ARRI L10-C Fresnel 510W	650

LED TUBE (RECHARGEABLE BATTERY) LED 光管 (充电式)

8" LED Daylight	8寸 LED光管 (高色温)	30
12" LED Daylight	12寸 LED光管 (高色温)	40
24" LED Daylight	24寸 LED光管 (高色温)	50
48" LED Daylight	48寸 LED光管 (高色温)	70
8" LED Tungsten	8寸 LED光管 (低色温)	30
12" LED Tungsten	12寸 LED光管 (低色温)	40
24" LED Tungsten	24寸 LED光管 (低色温)	50
48" LED Tungsten	48寸 LED光管 (低色温)	70
NANGUANG TRGB 1208B 24" LED Tube	南冠24寸 LED光管 (可调色)	120
NANGUANG TRGB 1212B 48" LED Tube	南冠48寸 LED光管 (可调色)	200

TUNGSTEN BATTERY SUNGUNS 低色温手提灯

250W 30V Sungun	250瓦 30伏特	120
Set Includes: Lamphead, Bulb, Handle, Battery	设备包括: 灯头、灯泡、手电、电池	
28V Lithium Battery	28伏特锂电池	100
Battery Charger	电池充电器	80

LANTERN

LANTERN 灯笼灯

JEM Ball 22" (500W / 1K)	22寸灯笼灯	300
JEM Ball 30" (1K / 2K)	30寸灯笼灯	350
HMI Adapter (For Joker Bug-Lite)	HMI 转接头	50

HMI BALL

高色温球灯

575W HMI Ball	575W 高色温球灯	1,000
1.2 KW HMI Ball	1.2KW 高色温球灯	1,200
2.5 KW HMI Ball	2.5KW 高色温球灯	2,500
4KW HMI Ball	4KW 高色温球灯	3,000

AIRLITE

LIGHTSTAR 1.2/1.8K Airlite	1.2 / 1.8KW 高色温充气球灯	700
LIGHTSTAR 2.5/4K Airlite	2.5 / 4KW 高色温充气球灯	900

UMBRELLA SOFT BOX

伞子灯

LOWEL RIFA EX-88 LIGHT (SET)	LOWEL RIFA 1千瓦伞子灯 (套装)	400
------------------------------	------------------------	-----

LIGHTING ACCESSORIES

灯 - 配件

DAILY HK\$
每日价格 (港元)

SOURCE FOUR PAR 多用途直射灯

ETC 750 (Lens Tube + Front Barrel) 19 Degree (Set)	170
ETC 750 (Lens Tube + Front Barrel) 26 Degree (Set)	170
ETC 750 (Lens Tube + Front Barrel) 36 Degree (Set)	170
ETC 750 (Lens Tube + Front Barrel) 50 Degree (Set)	170
ETC 750 To Joker 400W (Ring Adapter)	30
ETC 750 To Joker 800W (Ring Adapter)	30
Joker 400W HMI Body	Joker 400W
(For ETC Source Four 750)	(后部份 - 跟胆座+反光杯灯叉)
Joker 800WHMI Body	Joker 800W
(For ETC Source Four 750)	(后部份 - 跟胆座+反光杯灯叉)

DISTRIBUTION CABLES AND ADAPTERS 配电箱、电线及接头

Camlok 2-OTT 40ft	Camlok 2-OTT 40尺电缆	100
Camlok 4-OTT 80ft	Camlok 4-OTT 80尺电缆	110
16 Amp 3-Pin 40ft Extension Cable	16 Amp 3-Pin 40尺电线	15
16 Amp 3-Pin 100ft Extension Cable	16 Amp 3-Pin 100尺电线	35
32 Amp 3-Pin 40ft Extension Cable	32 Amp 3-Pin 40尺电线	35
32 Amp 3-Pin 100ft Extension Cable	32 Amp 3-Pin 100尺电线	50
32 Amp 3-Pin 160ft Extension Cable	32 Amp 3-Pin 160尺电线	120
63 Amp 3-Pin 50ft Extension Cable	63 Amp 3-Pin 50尺电线	70
63 Amp 3-Pin 40ft Extension Cable	63 Amp 5-Pin 40尺电线	80
63 Amp 3-Pin 80ft Extension Cable	63 Amp 5-Pin 80尺电线	110
125 Amp 3-Pin 40ft Extension Cable	125 Amp 5-Pin 40尺电线	100
Camlok Twofeer Adapter	Camlok 1出2 转接头	15
Camlok Threefeer Adapter	Camlok 1出3 转接头	15
16 Amp Threefeer	16 Amp 分流电源插座	15
32 Amp Y CORD	32 Amp 分流电源	15
63 Amp Y CORD	63 Amp 分流电源	30
63 Amp To 6 X 16 Amp Adapter	63 Amp 到 6 X 16 Amp 分流电源线	15
Camlok To 63 Amp Adapter	Camlok 到 63Amp 分流电源线	15
Camlok To Open End	Camlok 开口线	15
32 Amp To Open End	32 Amp 开口线	15
63 Amp To Open End	63 Amp 开口线	15
16 Amp To Gang Box (4 X 13A)	16 Amp 到 GANG BOX (4 X 13A)	15
13 Amp To 16 Amp Adapter	13 Amp 到 16 Amp 接头	15
15 Amp To 16 Amp Adapter	15 Amp 到 16 Amp 接头	15
16 Amp To 15 Amp Adapter	16 Amp 到 15 Amp 接头	15

ELECTRONIC DIMMERS 电子调光器

6KW 24CH Dimmer w/Panel	6千瓦24路电子调光器附带控制台	2,000
12KW 12CH Dimmer w/Panel	12千瓦12路电子调光器附带控制台	2,000
2KW 18CH Dimmer	2千瓦18路电子调光器	1,200
5KW 6CH Dimmer	5千瓦6路电子调光器	1,200
12KW 6CH Dimmer	12千瓦6路电子调光器	1,200
10/12 KW Electronic Dimmer	10 / 12千瓦电子调光器	250
20/24 KW Electronic Dimmer	20 / 24千瓦电子调光器	400
2KW Electronic Dimmer	2千瓦电子调光器	80
5KW Electronic Dimmer	5千瓦电子调光器	100
5KW Flicker Electronic Dimmer	5千瓦频闪控制器	500
Shadowmaker Dimmer (3 X 2 KW)	频闪控制器 (3 X 2KW)	500

LIGHTING ACCESSORIES

灯 - 配件

DAILY HK\$
每日价格 (港元)

VARIAC 变压器

1KW Variac	1千瓦变压器	30
2KW Variac	2千瓦变压器	40
3KW Variac	3千瓦变压器	50
5KW Variac	5千瓦变压器	100

POWER DISTRIBUTION BOXES 配电箱

180 Amp Power Box	180 AMP 配电箱	180
300 Amp Power Box	300 AMP 配电箱	350
600 Amp Power Box	600 AMP 配电箱	600

INVERTER 逆变器

DC-8 30V DC To 220V AC	DC-8 逆变器	250
------------------------	----------	-----

OTHER

200A Residual-Current Circuit Breaker (RCCB)	200A 漏电断路器	150
--	------------	-----

SMOKE MACHINES & FANS
放烟机和风扇

DAILY HK\$
每日价格 (港元)

PHOTO: GRIP EQUIPMENT
图片：场景工程设备

SMOKE MACHINE 放烟机

Fog Machine (JEM F-100)	放烟机	500
JEM Compact Hazer Pro (Smoke Machine)	烟枪 (喷烟机)	600
ROSCO V-Hazer 240V Fog Machine	烟枪 (喷烟机)	600

FANS 风扇

LTM 21" Model Fan	LTM 21寸风扇	300
-------------------	-----------	-----

GENERATORS 发电机

HONDA EU 30i Generator	本田 EU30i 发电机	500
HONDA EU 65i Generator	本田 EU60i 发电机	1,000
HONDA EU 70i Generator	本田 EU70i 发电机	1,200
1KW 220V Generator	1千瓦 220伏特 发电机	200

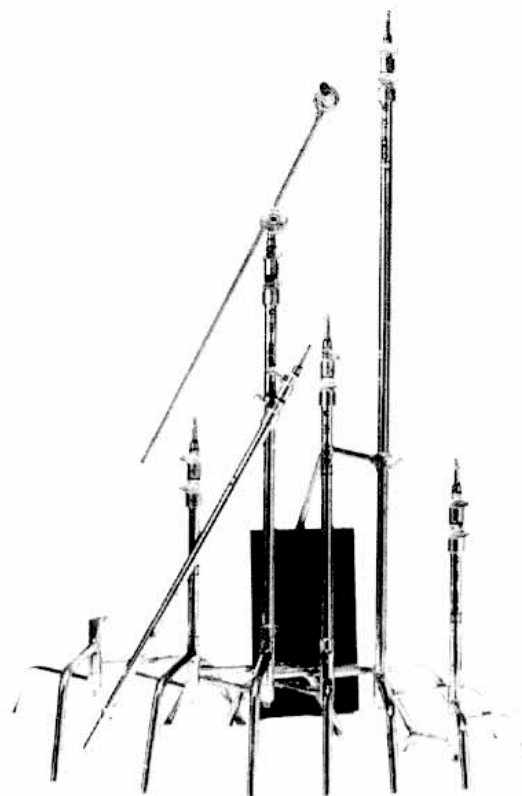

GRIPS

GRIP EQUIPMENT

场景工程设备

DAILY HK\$
每日价格 (港元)

STANDS	支架	
3-Section Super Crank-O-Vator	超级大摇升腿 (3节)	300
4-Section Super Crank-O-Vator	超级大摇升腿 (4节)	350
Baby Crank-O-Vator	小摇升腿	250
2 Sections Wind-Up Stand	2节升灯腿	80
Super Wind-Up Stand	大摇升灯腿	100
HI HI Roller Stand	超高万向轮夹头灯腿	80
MED Roller Stand	中高万向轮夹头灯腿	80
HI Roller Stand	高万向轮夹头灯腿	80
Mombo Combo Roller Stand	超特高万向轮夹头灯腿	100
Combo Roller Stand	重型灯腿	30
HD Combo Roller Stand	重型万向轮夹头灯腿	40
2 Sections Combo Stand	2 重型夹头灯腿	30
2 Sections Combo Roller Stand	万向轮 2 重型夹头灯腿	30
3 Sections Combo Stand	3 重型夹头灯腿	30
3 Sections Combo Roller Stand	万向轮 3 重型夹头灯腿	30
Low Boy Stand	重型矮灯腿	20
Low Boy Roller Stand	万向轮重型矮灯腿	30
MATTHEWS MAX Stand	长臂腿	500
20" C-Stand	魔术腿 20寸	30
40" C-Stand	魔术腿 40寸	30
60" C-Stand	魔术腿 60寸	40
004 Aluminum Stand	004 铝灯脚	15

MOUNTINGS	夹具	
2.5" Gobo Head	2 ½ 夹头	15
4.5" Gobo Head	4 ½ 大夹头	30
Mafer Clamp	鹰爪	15
Gaffer Grip	大力夹	20
Cator Grip	手夹	15
3" Matthellini Clamp (End Jaw)	3" 管夹	15
3" Matthellini Clamp (Center Jaw)	3" 管夹	15
6" Matthellini Clamp (End Jaw)	6" 管夹	15
6" Matthellini Clamp (Center Jaw)	6" 管夹	15
Foamcore Holder	米菠萝夹	15
Foamcore B-Board Fork	钢叉	15
Chain Vice Grip	老虎炼夹	20
Baby Pipe Clamp	小挂勾 (公)	15
Hanging Clamp	大挂勾	30
Junior Pipe Clamp	挂夹	15
6" Furniture Clamp with 5/8" Pin	6寸家具夹	15
12" Furniture Clamp with 5/8" Pin	12寸家具夹	15
24" Furniture Clamp with 5/8" Pin	24寸 家具夹	15
Baby 4" C-Clamp		20
Baby 6" C-Clamp		20
Baby 8" C-Clamp		20
Baby 10" C-Clamp		20
Baby 12" C-Clamp		20
Junior 4" C-Clamp		20
Junior 6" C-Clamp		20
Junior 8" C-Clamp		20
Junior 10" C-Clamp		20
Junior 12" C-Clamp		20

GRIP EQUIPMENT

场景工程设备

DAILY HK\$
每日价格 (港元)

MOUNTINGS	夹具	
Bailin Bracket	衣架	15
Baby Nail On Plate	小地龟	15
Right Angle Baby Plate	直角小地脚	15
Junior Nail On Plate	地龟	15
Baby Nail On Plate w/D-Ring	3寸 (公) 小地脚附吊	15
Concave Jr. Plate	曲型地脚 (母)	15
Turtle Base	地脚 (母)	15
Roller Turtle	万向轮地龟	30
Junior T Bone	T型地龟	15
Baby Offset Arm	小侧向移动臂	15
Junior Offset Arm	移动侧向臂	15
Junior Offset Arm (Telescoping)	可调较侧向臂	15
Mini Boom		200
Mega Boom		400
Pipe Boom Kit Complete w/Baby and Jr	灯笼吊臂 (套)	20
Spud Adapter 1-1/8-5/8	转接头	15
Tubing Hanger	音叉	15
Extension Ear (Set of Ear)	延长挂架组合 (一套)	50
Baby Double Header	双层夹头	20
Baby Triple Header	3头小灯支架	15
Junior Triple Header	3头大灯支架	30
Double Suction Cup	双吸盘	50
4.5" Suction Cup	4.5寸吸盘	40
6" Suction Cup	6寸吸盘	40
8" Suction Cup	8寸吸盘	40
10" Suction Cup	10寸吸盘	40
Filmtools Suction Cup	3寸 X 6寸吸盘	30
Condor Bracket	灯笼灯架	250
24" Tent Stakes	24寸营钉	15
32" Tent Stakes	32寸营钉	20
Drop Ceiling Clamp	天花挂勾	20
Baby Stand Riser	小延长通	20
Junior Stand Riser	大延长通	20
Baby Trombone	小挂勾	20
Junior Trombone	大型吊臂	30
Flex Arm Snap-in	多节臂	20
Broken Arm	中断C型夹	20
Baby Side Arm	小侧向臂	20
Putty Knife	灰铲灯架	20
45 Degree Angle Drop Down	45度角挂勾	20
Grid Helper	伸缩臂	40
Set Wall Bracket	墙角夹架	20
Poultry Bracket	电灯柱托架	20
Tree Branch Holder Large	树枝夹架大号	20
Grab Clamp w/Universal Head	倒挂夹跟转接头	40
Baby Pin w/ 3/8" Male Thread	转接头附3/8寸外螺纹 (公)	20
Cheeseborough Swivel Clamp	转动双层夹头	20
90 Degree Cheeseborough Clamp	90度双层夹头	20

Continue on next page... 续下页...

GRIP EQUIPMENT

场景工程设备

DAILY HK\$
每日价格 (港元)

MOUNTINGS

夹具

Grid Clamp w/Jr. Male Pin	挂夹附接头 (公)	20
Grid Clamp w/Jr. Revecier	挂夹附接头 (母)	20
Grid Clamp w/Baby Pin	挂夹附接头 (小公)	20
Grid Clamp w/D-Ring	管通带环	20
Grid Clamp w/Female Tee	管夹附接头 (大母)	20
Grid Clamp w/Female Crossover	管夹附横向接管	20
Grid Clamp w/Grip Head	管夹附高保头	20
Grid Clamp w/ 2" x 4.5" Flate Plate	管夹附 2寸 x 4.5寸块板	20
Grid Clamp w/ 4" x 4.5" Flate Plate	管夹附 4寸 x 4.5寸块板	20
Grid Clamp w/ 2" x 4.5" Swivel Flate Plate	管夹附 2寸 x 4.5寸可转动块板	20
Grid Clamp w/ 4" x 4.5" Swivel Flate Plate	管夹附 4寸 x 4.5寸可转动块板	20
Grid Clamp w/Jr. & Baby Revecier		20
Grid Clamp w/ 3/8" Male Thread	管夹附 3/8寸螺丝洞	20
Grid Clamp w/ 3/8" Female Thread	管夹附 3/8寸螺丝洞	20
Over And Under	双管接头	20
Over And Under Wide	双管接头 (阔)	20
Over And Under Ear	双管接头 (有叉)	20
Pole-Cate (3-9 ft)	撑杆 (3-9尺)	30
Pipe Ladder Truss	梯型托架	20
Pipe Cross Bracket	90度管卡	20
Pipe Frame Corner	管架角	20
Pipe Frame Ear	管架耳	20
Pipe Frame Sleeve	管架套通	20
Pipe Frame Corner w/Brace	管架角 支柱	20
Pipe Frame Tee	T型接头	20
Pipe Flange Base	地角	20
Pipe to Jr. Male Adapter	管转接头	20
Pipe To Pulley	管转接滑轮	20
Pipe Truss Bracket	三角托架	20
Pipe Vertical Truss Corner Bracket	三角托架角	30
Pipe Truss 90 Degree Pass Through Bracket	90度三角托架	30
Pipe Truss Base	管架 底座	30
Pipe Truss to Jr. Adapter	托架附接头 (大公)	20
Pipe Truss Adapter w/Ear	托架附接头 (有叉)	20
Pipe Wall Spreader Kit	钢管式墙撑器	30
Mini Pipe Frame Corner	小型直角接头	20
Mini Pipe Frame Corner w/Brace	管架角带支柱	20
Space Clamp	夹尺	20
Speed C Bracket	尺夹	20
Table Stand	三脚地灯座	15
2" x 4" Wall Spreader	2寸 x 4寸墙撑器	20
Horizontal Pipe Receiver w/ Flat Plate	坚地角	20
45 Degree Pipe Receiver Bracket	45度管卡	20
Pipe 4-Way Receiver Bracket	十字支撑	15
Condor Double Pipe Sider w/Jr. Receiver	双管倒吊灯座	80
Aluminum Pipe 2ft to 4ft	2尺至4尺铝管	15
Aluminum Pipe 5ft to 12ft	5尺至12尺铝管	30
Telescoping Hanger Double 3ft to 6ft	双圆通夹架3尺到6尺	60
Telescoping Hanger Double 4ft to 8ft	双圆通夹架4尺到8尺	60
Telescoping Hanger Double 5ft to 10ft	双圆通夹架5尺到10尺	60
Light Weight Telescoping Hnger Double 1ft to 2ft	轻型双圆通夹架1尺到2尺	30
Light Weight Telescoping Hnger Double 1.5ft to 3ft	轻型双圆通夹架1.5尺到3尺	35
Light Weight Telescoping Hnger Double 3ft to 6ft	轻型双圆通夹架3尺到6尺	40
Tent 6ft x 6ft	帐篷6尺 x 6尺	250
Tent 9ft x 9ft	帐篷9尺 x 9尺	400
Umbrella	雨伞	50

GRIP EQUIPMENT

场景工程设备

DAILY HK\$
每日价格 (港元)

REFLECTORS, CLOTH AND OVERHEADS

反光板、柔光布及框架装置

30" x 36" Silver Reflector	30寸 x 36寸银色反光板	35
42" x 42" Silver Reflector	42寸 x 42寸银色反光板	50
42" x 42" Gold Reflector	42寸 x 42寸金色反光板	50
3ft x 3ft Empty Frame	3尺 x 3尺旗板架	30
4ft x 4ft Empty Frame	4尺 x 4尺旗板架	40
6ft x 6ft Butterfly Set (Inc: Single, Double, Silk, Solid and Frame)	6尺 x 6尺蝴蝶框架 - 套装 (包括: 单、双、丝、黑布和框架)	280
6ft x 6ft Single Scrim	6尺 x 6尺单纱	100
6ft x 6ft Double Scrim	6尺 x 6尺双纱	100
6ft x 6ft Solid Black	6尺 x 6尺黑布	100
6ft x 6ft Artificial Silk	6尺 x 6尺人造丝	100
6ft x 6ft Gold Matthflectr	6尺 x 6尺反光布 (金)	100
6ft x 6ft Silver Matthflectr	6尺 x 6尺反光布 (银)	100
6ft x 6ft Friff B/W T55	6尺 x 6尺GRIFF B/W T55胶布 (黑/白)	100
6ft x 6ft Bleached Muslin	6尺 x 6尺麻布 (漂白)	100
6ft x 6ft Unbleached Muslin	6尺 x 6尺麻布 (原色)	100
6ft x 6ft 3030 Grid Cloth	6尺 x 6尺3030柔光布	100
6ft x 6ft 3032 Light Grid Cloth	6尺 x 6尺3032薄柔光布	100
6ft x 6ft 3034 Quarter Grid Cloth	6尺 x 6尺3034薄柔光布	100
6ft x 6ft Egg Crate (50")	6尺 x 6尺布蛋格 (50")	400
6ft x 6ft Frame Breakdown	6尺 x 6尺蝴蝶框架	100
6ft x 6ft Ultra Bounce	6尺 x 6尺黑白格仔布	120
8ft x 8ft Butterfly Set (Inc: Single, Double, Silk, Solid and Frame)	8尺 x 8尺蝴蝶框架 - 套装 (包括: 单、双、丝、黑布和框架)	350
8ft x 8ft Single Scrim	8尺 x 8尺单纱	180
8ft x 8ft Double Scrim	8尺 x 8尺双纱	180
8ft x 8ft Solid Black	8尺 x 8尺黑布	120
8ft x 8ft Artificial Silk	8尺 x 8尺人造丝	120
8ft x 8ft Griff B/W T55	8尺 x 8尺GRIFF B/W T55胶布 (黑/白)	120
8ft x 8ft Bleached Muslin	8尺 x 8尺麻布 (漂白)	150
8ft x 8ft Unbleached Muslin	8尺 x 8尺麻布 (原色)	120
8ft x 8ft 3030 Grid Cloth	8尺 x 8尺3030 柔光布	120
8ft x 8ft 3032 Light Grid Cloth	8尺 x 8尺3032 薄柔光布	120
8ft x 8ft 3034 Quarter Grid Cloth	8尺 x 8尺3034 薄柔光布	120
8ft x 8ft Ultra Bounce	8尺 x 8尺黑白格仔布	120
8ft x 8ft Checkerboard	8尺 x 8尺金色 + 银色反光布	180
8ft x 8ft Soft Frost	8尺 x 8尺磨砂透明胶布	120
8ft x 8ft Hi-Lite	8尺 x 8尺磨砂高透明胶布	130
8ft x 8ft Egg Crate (50")	8尺 x 8尺布蛋格 (50")	500
8ft x 8ft Heavy Duty Frame (brks. into 4sec.)	8尺 x 8尺重型蝴蝶框架	120
12ft x 12ft Butterfly Set (Inc: Single, Double, Silk, Solid and Frame)	12尺 x 12尺蝴蝶框架 - 套装 (包括: 单、双、丝、黑布和框架)	400
12ft x 12ft Single Scrim	12尺 x 12尺	200
12ft x 12ft Double Scrim	12尺 x 12尺 双	250
12ft x 12ft Solid Black	12尺 x 12尺 黑布	150
12ft x 12ft Artificial Silk	12尺 x 12尺 人造	150
12ft x 12ft Gold Matthflectr	12尺 x 12尺 金反光布	200
12ft x 12ft Silver Matthflectr	12尺 x 12尺 银反光布	200
12ft x 12ft Griffolyn	12尺 x 12尺 GRIFF B/W T55胶布 (黑/白)	200
12ft x 12ft 3030 Grid Cloth	12尺 x 12尺 3030柔光布	150
12ft x 12ft 3032 Light Grid Cloth	12尺 x 12尺 3032薄柔光布	150

Continue on next page... 续下页...

GRIP EQUIPMENT 场景工程设备

DAILY HK\$
每日价格 (港元)

REFLECTORS, CLOTH AND OVERHEADS 反光板、柔光布及框架装置		
12ft x 12ft Green Screen	12尺 x 12尺特技绿色布	700
12ft x 12ft Blue Screen	12尺 x 12尺特技蓝色布	700
12ft x 12ft Ultra Bounce	12尺 x 12尺黑白格仔布	150
12ft x 12ft Checkerboard	12尺 x 12尺金色 + 银色反光布	230
12ft x 12ft Soft Frost	12尺 x 12尺磨砂透明胶布	150
12ft x 12ft Hi-Lite	12尺 x 12尺磨砂高透明胶布	230
12ft x 12ft Egg Crate (50")	12尺 x 12尺布蛋格 (50")	800
12ft x 12ft Frame Breakdown	12尺 x 12尺蝴蝶框架	150
20ft x 20ft Overhead Set (Inc: Single, Double, Silk, Solid and Frame)	20尺 x 20尺蝴蝶框架 - 套装 (包括: 单、双、丝、黑布和框架)	700
20ft x 20ft Single Scrim	20尺 x 20尺单纱	350
20ft x 20ft Double Scrim	20尺 x 20尺双纱	350
20ft x 20ft Solid Black	20尺 x 20尺黑布	250
20ft x 20ft Artificial Silk	20尺 x 20尺人造丝	250
20ft x 20ft Gold Matthreflector	20尺 x 20尺反光布 (金)	350
20ft x 20ft Silver Matthreflector	20尺 x 20尺反光布 (银)	350
20ft x 20ft Griffolyn	20尺 x 20尺B/W T55胶布 (克/白)	200
20ft x 20ft 3030 Grid Cloth	20尺 x 20尺柔光布	200
20ft x 20ft 3032 Light Grid Cloth	20尺 x 20尺薄柔光布	200
20ft x 20ft Green Screen	20尺 x 20尺特技蓝色布	1,000
20ft x 20ft Blue Screen	20尺 x 20尺特技绿色布	1,000
20ft x 20ft Ultra Bounce	20尺 x 20尺黑白格仔布	300
20ft x 20ft Soft Frost	20尺 x 20尺磨砂透明胶布	300
20ft x 20ft Hi-Lite	20尺 x 20尺磨砂高透明胶布	300
20ft x 20ft Frame	20尺 x 20尺蝴蝶框架	300
20ft x 20ft Egg Crate (50")	20尺 x 20尺布蛋格 (50")	1,100

SCRIMS, FLAGS, CUTTER AND WOOD 纱、旗板及木器		
18" x 24" Single Scrim	18寸 x 24寸单纱	15
18" x 24" Double Scrim	18寸 x 24寸双纱	20
18" x 24" Silk Scrim	18寸 x 24寸丝	20
18" x 24" Lavender Scrim	18寸 x 24寸淡紫色纱	20
24" x 36" Single Scrim	24寸 x 36寸单纱	20
24" x 36" Double Scrim	24寸 x 36寸双纱	25
24" x 36" Silk Scrim	24寸 x 36寸丝	25
24" x 36" Lavender Scrim	24寸 x 36寸淡紫色纱	25
48" x 48" Single Scrim	48寸 x 48寸单纱	40
48" x 48" Double Scrim	48寸 x 48寸双纱	60
48" x 48" Artificial Scrim	48寸 x 48寸丝	50
48" x 48" Lavender Scrim	48寸 x 48寸淡紫色纱	50
10" x 24" Flag	10寸 x 24寸旗板	15
12" x 18" Flag	12寸 x 18寸旗板	15
24" x 36" Flag	24寸 x 36寸旗板	15
10" x 42" Cutter	10寸 x 42寸旗板	15
18" x 48" Cutter	18寸 x 48寸旗板	25
24" x 30" Cutter	24寸 x 30寸旗板	15
24" x 48" Cutter	24寸 x 48寸旗板	20
24" x 60" Cutter	24寸 x 60寸旗板	40
24" x 72" Cutter	24寸 x 72寸旗板	50
48" x 48" Cutter	48寸 x 48寸旗板	25
24" x 72" Floppy	24寸 x 72寸可延长旗板	60
48" x 48" Floppy	48寸 x 48寸可延长旗板	30

GRIP EQUIPMENT 场景工程设备

DAILY HK\$
每日价格 (港元)

SCRIMS, FLAGS, CUTTER AND WOOD 纱、旗板及木器		
18" x 24" Wood Cucoloris	18寸 x 24寸木制影旗	15
24" x 36" Wood Cucoloris	24寸 x 36寸木制影旗	30
48" x 48" Wood Cucoloris	48寸 x 48寸木制影旗	40
18" x 24" Celo Cucoloris	18寸 x 24寸铁质网模板	40
24" x 36" Celo Cucoloris	24寸 x 36寸铁质网模板	40
40" x 40" Celo Cucoloris	40寸 x 40寸铁质网模板	60
Set of 18 Dots	圆形丝网	100
Set of 12 Finder	长型丝网	100
1/4 Apple Box	1/4 木苹果箱 (3寸)	15
HALF Apple Box	1/2 木苹果箱 (6寸)	15
FULL Apple Box	木苹果箱 (12寸)	15
Set 16 Cup BLOCKS / CS / PANCAKE	垫板	30
Set Four Stair Blks	木梯	15
Wedges (50 Pcs)	木楔 (50 Pcs)	30
4ft Double Sided Aluminium Ladder	4尺铝梯	20
6ft Double Sided Aluminium Ladder	6尺铝梯	40
8ft Double Sided Aluminium Ladder	8尺铝梯	60
10ft Double Sided Aluminium Ladder	10尺铝梯	80
12ft Double Sided Aluminium Ladder	12尺铝梯	100
30ft Extension Ladder	30尺延长梯	120

PARALLELS, SANDBAG AND OTHER		
6ft Aluminum Walk-Up Scaffold	6尺铝高台	300
12ft Aluminum Walk-Up Scaffold	12尺铝高台	450
18ft Aluminum Walk-Up Scaffold	18尺铝高台	600
24ft Aluminum Walk-Up Scaffold	24尺铝梯高台	800
Includes: (Frame, Cross Brace and Top Platform)	包括: (框架、支杆、顶层平台)	
Umbrella with Stand	太阳伞连灯腿	50
Sound Blanket N/GR	隔音毯	30
Sandbag 20lbs	沙袋 (20磅)	15
Shot Bags 15lbs	铁沙袋 (15磅)	15

CART 手推车		
MAGLINER Junior Cart	MAGLINER 工作车	50
MAGLINER Senior Cart	MAGLINER 工作车	30
Grip Stand Cart	脚架推车	15
Sand Bag / Cable Cart	沙袋 / 电缆手推车	15
Speed Rail Cart	铝通手推车	60
Taco Cart	TACO 推车	200
Cage Cart	铁笼车	50
Milk Carts with 6 x Grey Plastic Bucket		100

STEELDECK		
4ft x 4ft	4尺 x 4尺 平台	300
4ft x 8ft	4尺 x 8尺 平台	350

DOLLIES 移动摄影车

PHOTO: SUPER IV PEEWEE 照片：移动摄影车

PHILOSOPHY

Camera movment, that is what we are all about! You may not always see us on screen, but we have been here a long time... Since 1945 Chapman/Leonard Studio Equipment, Inc. has been supplying camera support equipment to various productions. From feature films, commercials, television series, music video to infomercials, Chapman has moved it, helping to create many of the memorable scenes we all know today!

All along, Chapman has been involved with camera movement. Chapman equipment, under the careful direction of the Director, Director Cinematography and Dolly Grip, has created moments of fear, impact, loneliness, confusion and many other emotions that camera movement can enhance for a scene.

Chapman is continuing to develop new and improved ways to move the camera, combining old techniques with new, it is our goal to accomodated the Director and Director of Cinematography in their creative process and obtain in image they want to etch on film.

We proud to celebrate over 50 years in camera support. We look forward to many new projects in the future and will continue our tradition of quality equipment.

Re-printed with permission from Chapman/Leonard Studio Equipment Inc.

原则

镜头移动，这是我们的机器，你不一定能在镜头上看到我们，但我们在这行业里已经从业很久，自从1945年以来，Chapman/Leonard Studio Equipment, Inc. 一向向不同产品提供摄影机支持设备。从电影、广告、电视连续剧，音乐电视到商品销售，Chapman一直在幕后提供支持，帮助拍摄人员拍出了许多我们至今难以忘怀的经典镜头。

Chapman一直参与摄影机运动。Chapman的设备在导演。摄影和移动摄影车助理的仔细指导下，创作了能由镜头移动制造的恐怖、惊人、孤独、迷茫的时刻，和许多其它感性场面。

Chapman继续开发新型，改良的方法来移动摄影机。通过将既有技术和新技术结合起来，Chapman的目标就是帮助导演和摄影在电影中排除他们所要的效果。

我们很荣幸能够庆祝从业50周年。我们期待未来的新计划，并将保持我们高水准的工作。

印刷前获得了Chapman/Leonard Studio Equipment Inc.的许可



DOLLIES
移动摄影车DAILY HK\$
每日价格 (港元)**SUPER PEEWEE DOLLY****SUPER PEEWEE 摄影移动机车**

HYBRID IV	混合型 IV	3,800
Super PeeWee Dolly IV	Super PeeWee Dolly IV 摄影移动机车	3,000
Super PeeWee Dolly III Plus	Super PeeWee Dolly III Plus 摄影移动机车	2,500
Super PeeWee Dolly II	Super PeeWee Dolly II 摄影移动机车	2,500
Includes:	包括:	
1 Leveling Head - PW	1个 水平云台	
1 PeeWee Right Angle Plate	1个 直角板	
2 PeeWee Seat w/Locknut	2个 座椅	
1 PeeWee Seat Offset Frm	1个 座椅横臂	
1 PeeWee Seat Riser 12"	1个 座椅升座12寸	
1 PeeWee Narrow Side Board	1个 窄侧踏板	
1 PeeWee wide side board	1个 踏板	
1 PeeWee Front Board	1个 前踏板	
1 Mitchell Camera Riser 6" - PW	1个 6寸 - 平底升座	
1 Mitchell Camera Riser 12" - PW	1个 12寸 - 平底升座	
1 Camera Extension Plate 24"	1个 24寸延长板	
1 Value Control Handle - PW	1个 升降控制杆	
1 Tilt Nose Plate - PW	1个 平台	
1 150MM Bowl Extension	1个 150MM圆底升座	
1 Steering Column - PW	1个 转向杆	
1 PeeWee Wrench & AC Cable	1个 扳手和交流电	
1 AM Bowl Adapter	1个 平底转圆底	

PEEWEE TRACKS AND ACCESSORIES**PEEWEE 轨道和配件**

5ft Light wt. Straight Track	5尺轻型直轨	30
Light wt. Curve Track (12 sections)	轻型弯轨	40
light weight curve track equal 360 degree)	(360度, 平分12节重型弯轨)	
2ft GFM Straight Track	2尺重型轨道	100
5ft GFM Straight Track	5尺重型轨道	100
7.5ft GFM Straight Track	7.5尺重型轨道	100
GFM 45 degree Curve Track (Ø: 20ft / 16ft)	45度重型轨道 (直径: 20尺 / 16尺)	120
MSE 90 degree Curve Track (Ø: 10ft)	90度轨道 (直径: 10尺)	120
Camera Extension Plate 24"	24寸延长板	50
HYBRID Low Camera Plate	HYBRID 低角度录影机平台	50
MITCHELL Camera Riser 3" - PW	平底升座3寸	50
MITCHELL Camera Riser 6" - PW	平底升座6寸	50
MITCHELL Camera Riser 12" - PW	平底升座12寸	50
PeeWee Drop Down Sideboard	低角度侧踏板	50
PeeWee Seat Riser 12"	座椅升座12寸	25
PeeWee Soft Tires 8pcs/set	PeeWee 软轮胎每组8个	250
PeeWee Standing Board	PeeWee 企板	50
PeeWee Tracking Bar	PeeWee 把手	25
Pneumatic Wheels - PW 8pcs/set	气胎 - PW 每组8个	250
Vibration Isolator - PWw/case	防震座	500
Paddle Mount	划桨装配	300
Drop Wown Plate	低角度板	165
Skateboard Wheel / Centipede	移动车专用路轧器	250

DOLLIES
移动摄影车DAILY HK\$
每日价格 (港元)**FISHER DOLLY****FISHER 摄影移动机车**

FISHER 10 Dolly	FISHER 10液压升降移动摄影车	3,000
FISHER 11 Dolly	FISHER 11液压升降移动摄影车	3,000
Includes:	包括:	
2 High Sideboards	2个 高侧板	
2 Low Sideboards	2个 低侧板	
4 Push Rods	4个 抬杆	
2 Seats	2个 座椅	
1 Seat Offset Arm	1个 座椅横臂	
1 Front Board	1个 前企板	
1 Mitchell Camera Riser 6"	1个 6寸平底升座	
1 Mitchell Camera Riser 12"	1个 12寸平底升座	
1 30" Extension Plate	1个 30寸延长板	
1 Bowl Adapter	1个 圆底转接座	
1 Low Angle Plate	1个 低角度板	
1 AC Cable	1个 电线	
1 Skateboard Wheels	1个 滑动轮 (千足虫)	
FISHER 10 Round Track Wheels (Set)	FISHER 10 轨道轮 (套装)	350
FISHER 10 Soft Wheels (Set)	FISHER 10 气胎轮 (套装)	350

SUPER PANTHER III DOLLY**SUPER PANTHER III 电动升降移动摄影车** 3,000

Includes:	包括:
1 Column Drive and Computer Memory	1个 升降柱
1 Platform	1个 平台
2 Seats	2个 座椅
1 Ball Adapter	1个 底座座
2 Batteries	2个 电池
1 Charger	1个 充电器

PLATFORM, BRIEFCASE AND FOCUS DOLLY**移动车**

PLATFORM Dolly	移动车	500
BRIEFCASE Dolly	移动车	500
FOCUS Dolly	移动车	500
Includes:	包括:	
4 5ft Light wt. Straight Track	4个5尺型直轨	
2 Light wt. Cure Track	2个轻型弯轨	

DOORWAY DOLLY**小气吹移动摄影车**

500

WESTERN DOLLY**大气吹移动摄影车**

800

DANNA DOLLY

400

RICKSHAW**人力车**

1,200

CRASH BOX**爆炸箱**

500

SLIDER**移动滑轨**

RONFORD 36" Mitchell Base	RONFORD 36寸滑轨	800
RONFORD 48" Mitchell Base	RONFORD 48寸滑轨	1,000
RONFORD 60" Mitchell Base	RONFORD 60寸滑轨	1,300
RONFORD 72" Mitchell Base	RONFORD 72寸滑轨	1,500
RONFORD 96" Mitchell Base	RONFORD 96寸滑轨	1,800
CINEPED Rotational Slider Set	CINEPED 旋转滑轨	1,200
CINEPED 3.5ft Slider	CINEPED 3.5尺滑轨	900

G.F.M GRIP EQUIPMENT**G.F.M 配套附件**

GFM U-Bangi - 1.2M	GFM U-Bangi - 1.2公尺	800
2M Rail	2公尺轨道	200
Combi Rig		350

GFM ADJ GAS RISER**G.F.M 气压立柱**

13" - 26"		250
20" - 45"		250

CRANE EQUIPMENT
摄影升降台设备

DAILY HK\$
每日价格 (港元)

THE SUPERTECHNO 30

15,600

Telescopes during the shot, offering you the ability to film sequences difficult to achieve with any fixed length crane. The long reach of the SuperTechno 30 means you can put the camera anywhere in a 60' diameter without ever moving the dolly. That means you won't have to set up track to get your shot, saving you the price of the crane in time alone.

The SuperTechno 30 在拍摄时
可以远拍。让您可以拍摄任何
在固定升降台上难以拍摄的场
面。SuperTechno 30的远程拍
摄意味着您可以把摄影机放在
任何60呎半径以内的地方。不
需移动摄影车的位置。这样您
就可以不必为了拍摄镜头而重
新设置推到, 节省您的时间。

Set Includes:
SUPERTECHNO
Dolly
Operator's Console
9", 14" Colour Monitors
All Necessary Cables

设备包括:
SUPERTECHNO
移动车
操作员操纵台
9寸, 14寸彩色监视器
电线

Specifications:
Maximum Speed: 4' 6" per second
Minimum Speed: 3' 3" per hour
Maximum Lens Height: 30ft Underslung
Maximum Tilt of Arm: 57 Down, 60 Up
Overall Length: 16' 7" Closed, 39' 2" Open
Front Length: 8' 8" Closed, 31' 4" Open
Rear Length: 8ft
Crane Weight: 1,175kg Including Z-Head
Dolly
Length 5'5", Width 6'5"
Crane Height:
6' 11" with Post Wown, 8' 5" with Post Up
Track Width: 6'5"
Length: 17" in Shortest Config.
29" in Normal Config.
Minimum Dimensions: 17" x 16"
Weight: 22 - 27kg 2 Axis,
32 - 36kg with 3rd Axis

规格:
最大速度: 每秒4尺6寸
最小速度: 每小时3尺3寸
最大镜头高度: 水平高度30尺
最大摇臂倾斜角度: 57°下, 60°仰角
全长: 关闭时: 16尺7寸, 打开时: 39尺2寸
前部长度: 8尺8寸, 打开时: 31尺4寸
后部长度: 8尺
升降台重量: 1,175公斤包括: Z-控云台
移动车
长度5尺5寸, 阔度6尺5寸
摄影升降台高度: 升降台后部水平高度
最低6'11寸, 最高8'5寸
宽度: 6尺5寸
长度: 最小配置: 17寸, 一半配置: 29寸
最小尺寸: 17寸 X 16寸
重量: 两轴: 22-27公斤, 三轴: 32-36公斤

Accessories:
5ft Straight Track
10ft Straight Track
Rain Cover

附件:
5尺直车轨 200
10尺直车轨 200
防雨罩 1,560

CRANE EQUIPMENT
摄影升降台设备

DAILY HK\$
每日价格 (港元)

NEW TECHNO CRANE WITH Z HEAD (22 FT)

12,000

Technicians are required from Salon Films. They must be chosen from a list of technicians who have successfully completed basic competency training on the crane from Salon Films. Please call us for a list of these technicians.

技术人员自沙龙公司。他们
需要从已经通过沙龙公司
必要摇臂训练的技术人员中
挑选。我们打电话索取人员
名单。

GF 8 XTEN-FULL SET

G.F. 8 XTEN 11米升降系统 (套装)

7,000

GF 16-FULL SET

G.F. 16 -16米升降系统 (套装)

9,000

G.F. JIB ARM

G.F. 摇臂

1,200

Includes:
Arm, Counter Weight and Weight Bracket

包括:
摇臂、平衡配重和平衡托架

GF MINI-JIB

G.F. 摇臂 - 短

800

MINI JIB ARM - LONG

小型摇臂 - 长

800

Egripment Mini-Jib Arm (long) with Counter Weight
GF OFF SET Rig

Egripment 小摇臂 (长版) 附带平衡配重
900
600

SUPER MAXI JIB ARM

SUPER MAXI 摇臂

1,700

Includes:
Arm, Counter Weight,
Weight Bracket and Dolly Adapter

包括:
摇臂、平衡配重、
平衡托架和移动车接合器

SWISS JIB - IMPROVED VERSION

瑞士摇臂 - 改进版

4,500

Includes:
"Arm, Counter Weight, Weight Bracket,
Extension and Bracking Kit"

包括:
摇臂、平衡配重、平衡托架、
延长和支架组

PANTHER SUPER JIB III

PANTHER 超摇臂 III

1,000

Includes:
Arm, Counter Weight, Jib-A-Round
and 2 Seats

包括:
摇臂、平衡配重、平台和2个椅子

STANDARD PORTA JIB

标准 PORTA 摇臂

800

Includes:
MITCHELL Base,
150mm Front and Counter Weight

包括:
平底前置、圆底前置和平衡配重

PHOENIX CRANE

PHOENIX 摇臂

Complete with Riser, Counter Weight
and Wide Base Dolly
18ft Version
25ft Version
33ft Version

完整版, 附带升高器、平衡配重
和宽移动摄影车
18尺版本 3,000
25尺版本 4,000
33尺版本 5,000

TULIP CRANE

TULIP 摇臂

2,800

Includes:
Arm, Column, Counter Weight,
Weight Bracket and Track Wheels.

包括:
摇臂、柱杆、平衡配重、
平衡托架和轨道轮

TULIP CRANE SUPER SKYMOTE

TULIP CRANE SUPER SKYMOTE 摇臂

4,400

CAMERA REMOTE PRODUCTS

远程摄影机产品

DAILY HK\$
每日价格 (港元)

SUPERTECHNO THE TELESCOPIC CAMERA CRANE

POWER POD MK IV REMOTE POWER POD MK IV 遥控云台系统 5,500

Head System

Includes:

- 1 150MM Power Pod Riser
- 2 Worrall Handle Control
- 1 Power Supply
- 1 Zapper
- 5 24/30V Battery
- 1 9" Color Monitor
- 2 12V 24/30V Battery

Optional Accessory:

Power Pod Pan Bar Control

包括:

- 1个 150MM 升座
- 2个 轮式控制器
- 1个 电源供应器
- 1个 控制器
- 5个 24/30伏特电池
- 1个 9寸彩色监视器
- 2个 12伏特电池

可选组件:

直转杆, 推杆式控制器

1,500

REMOTE HEAD (PAN BAR OR HAND WHEEL CONTROL) 摇控云台

SCORPIO Stabilized Head 4 Axis	SCORPIO 四轴防震云台	25,000
SCORPIO Classic Head 2 Axis (Max Loading: 80KG)	SCORPIO Classic 控云台 2 (最大负重: 80公斤)	7,000
SCORPIO Classic Head 3 Axis (Max Loading: 40KG)	SCORPIO Classic 控云台 3 (最大负重: 40公斤)	8,500
SCORPIO JDR Pan Bar Control		1,000
SCORPIO Handwheels Control (WORRAL)		1,000
SCORPIO Microwave Wireless	微波摇控组件	1,700

CABLE CAM 飞猫 (滑索式拍摄架)

SLP Cable Cam	SLP 飞猫	2,000
---------------	--------	-------

WALKIE TALKIE 对讲机

Walkie Talkie with Ear Set (w/License)	对讲机连耳机 (有牌照)	80
--	--------------	----

ST30

Max. lens height: 9.2 m / 30 ft.
Max telescope extend: 7 m / 23 ft.
Max speed: 1.5 m/s / 5 ft/s.
Max camera weight: 35 kg / 80 lbs
Total weight: 1200 kg / 2640 lbs

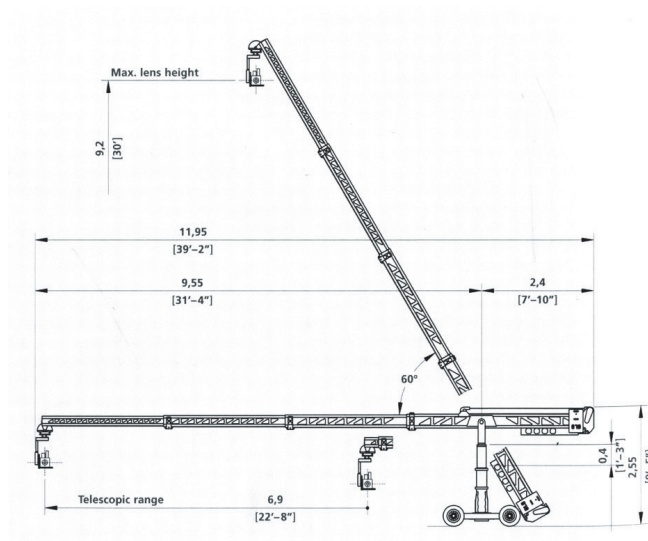

RENTAL CONDITIONS

1. For the purposes hereof Salon Films (H.K.) Limited is hereinafter called "The Owner".
2. The Hirer will indemnify the Owner against loss or damage to the equipment or any part thereof (fair wear and tear only excepted) from whatever cause arising and whether or not such loss or damage results from the negligence of the Hirer.
3. No liability shall attach to the owner either in contract or in tort for loss injury or damage sustained by the Hirer or any third party as a result of the presence or use of the equipment or any defect therein in the equipment whether such defect be latent or apparent on examination and in connection therewith the Hirer will indemnify the Owner against all claims and demands made upon the Owner.
4. The Hirer will not part with the possession or control of the equipment the subject matter of this Agreement without the consent in writing of the Owner.
5. The equipment the subject matter of this Agreement shall remain the property of the Owner and nothing contained in this Agreement shall confer or be deemed to confer any interest in the equipment on the Hirer.
6. The Hirer will keep the equipment free from any lien distress execution or other legal process.
7. The Hirer will permit any person authorised by the Owner at all reasonable times wherever the equipment may be to examine the condition of the said equipment.
8. The Hirer will be responsible for insuring the equipment during the continuance of the hiring against loss and/or damage by accident fire or theft to the current full replacement value thereof.
9. If the Hirer shall commit an act of bankruptcy or have a receiving order made against him or shall make any arrangement with his creditors or if distress shall be levied or threatened upon any of the Hirer's property or any Judgment against the Hirer shall remain unsatisfied for more than 14 days then this Agreement shall automatically and without notice determine and therefore the Hirer shall cease to be in possession of the equipment with the Owner's consent.
10. In the event of loss or damage to the equipment hired, the Hirer will pay to the Owner the costs and expenses of all such repairs or replacements as are deemed necessary by the Owner and in addition thereto the Hirer will pay rental, at the rate set forth, for such period of time as it takes to repair or replace the equipment in question.

RENTAL CONDITIONS

11. The Owner shall not under any circumstances be liable to make any payment to the Hirer in respect of or to indemnify the Hirer against and loss injury not damage sustained by the Hirer or by any third party as a result of the Owner providing the wrong equipment or equipment which breaks down or is defective in any way whatsoever and in collecting or taking delivery of the machinery the Hirer shall be deemed to have satisfied himself that the equipment is the equipment required and is in proper working order.
12. The Hirer shall take the equipment in the condition in which it is at the date of this Agreement and the Owner does not in any way represent or warrant that the equipment is of merchantable quality or suitable or fit for the particular or any purpose for which it is or may be required.
13. Any extension of hire must be arranged prior to termination of original hire. Extension of hire will only be possible if no prior bookings have been arranged.
14. Any damage to or malfunction of the equipment should be reported immediately upon the return of the equipment to the owner.
15. All equipment is serviced at termination of each hire, and the Hirer shall be entitled to test all equipment before accepting delivery.
16. All rental prices and/or specifications are subject to change without notice.
17. No relaxation, forbearance delay or indulgence delay in indulgence by the Owner in enforcing any of the terms and conditions of this Agreement shall prejudice, affect or restrict the rights and powers of the Owner hereunder nor shall any waiver by the Owner of any breach hereof operate as a waiver of any subsequent or any continuing breach hereof.
18. Rental equipment must be returned to Owner by 10:00 a.m. on the date following the last day of the rental period to avoid an extra full day rental charge.
19. The hire charge for equipment commences from the time equipment leaves the company's premises and is terminated at the end of the agreed hire period or when the equipment is returned there whichever is the later.
20. Where equipment is delivered and/or collected by the Owner, such delivery and/or collection is at the Hirer's risk and expense and the Hirer shall be liable for physical loss or damage to the equipment from the time the equipment leaves the Owner's premises until it is returned to the Owner's premises whether or not the equipment is being delivery or collected by the Owner or is in the custody of the Owner, its employee or agent.

THE CHAPMAN PEEWEE AND SUPER PEEWEE DOLLIES

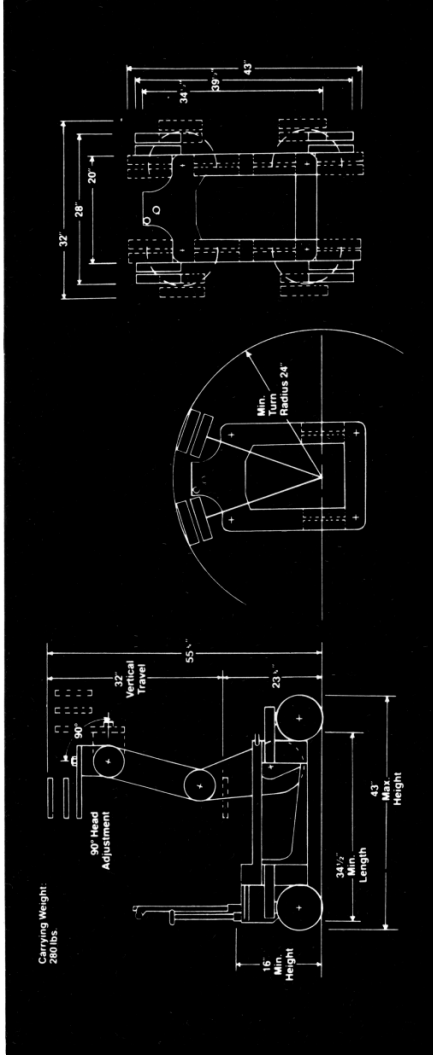

PEEWEE & SUPER PEEWE SPECIFICATIONS

Lens Height (without risers)	5ft. 9 in.
Lens Height (with standard 12" riser)	6ft. 9 in.
Low Lens Height (without risers)	37 in.
Low Lens Height with PEEWEE Drop Down Attachment to Camera Base	3 in.
Vertical Boom Travel	32 in.
Carrying Capacity of Camera Plate (extended 24" in any direction from the PEEWEE base plate)	250 lbs.
Maximum Boom Lifts (fully charged)	3 lifts.
Chassis Maximum Length (wheels fully extended)	43 in.
Chassis Minimum Length (wheels fully retracted)	34 1/2 in.
Minimum Chassis Height for Transportation	16 in.
Chassis Variable Widths — Legs in	20 in.
Legs at 45°	28 in.
Legs at 90°	32 in.
Steering Post Height	35 in.
Minimum Turn Radius	24 in.
Accumulator Charging Time (foot pump only)	30-60 sec.
Hand Brake Holding Capacity (wheel brake)	100 lbs.
Minimum Width Door PEEWEE can be carried through	16 in.
Carrying Weight	280 lbs.

SPECIFICATION OF FISHER DOLLY

Maximum Elevation (without riser)	63"	(160 cm)
Minimum Elevation (unaided)	16"	(41 cm)
Minimum Elevation (low level head)	5½"	(14 cm)
Vertical Beam Travel	47"	(119 cm)
Lift Capacity	500 lbs.	(227 kg)
Lifts Per Charge	7	
Length	54"	(137 cm)
Width (wheels-in)	26-5/8"	(68 cm)
Width (wheels-out)	32"	(81 cm)
Height (operating)	38½"	(98 cm)
Height (folded)	25"	(63 cm)
Minimum Turn Radius (Round Steering)	22"	(56 cm)
Minimum Turn Radius (Conventional Steering)	44"	(112 cm)
Carrying Weight	420 lbs.	(190 kg)

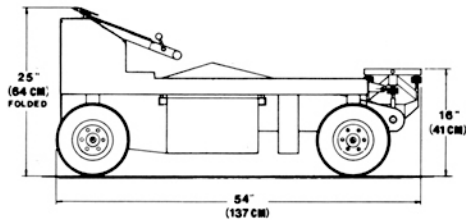
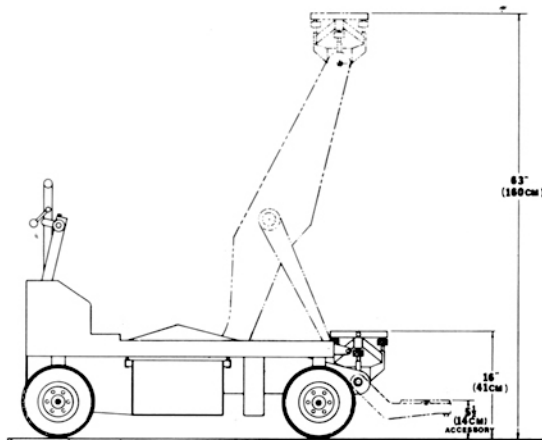

FISHER TEN DOLLY

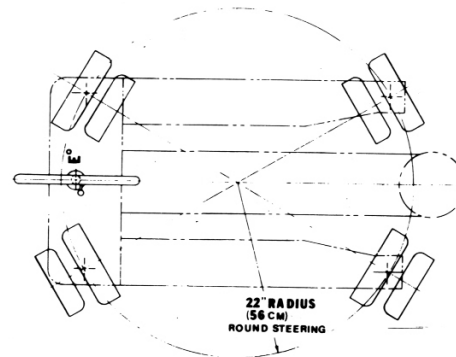
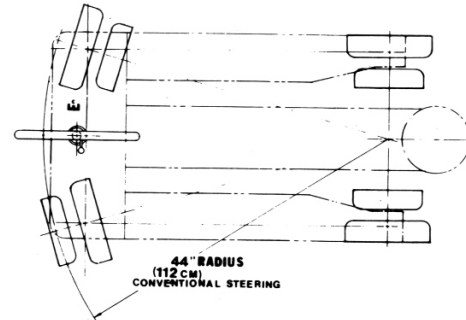
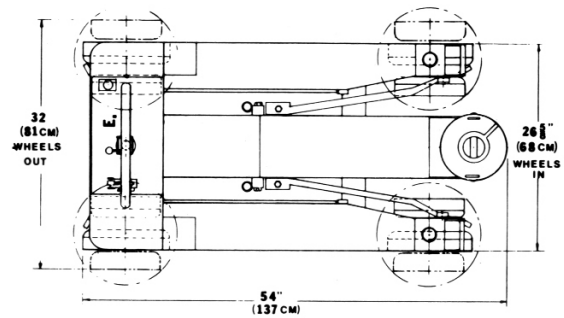

TULIP CRANE SPECIFICATIONS

Tulip Crane Arm (Dimensions Open)	Length 376 cm (148") Width 57 cm (22.5")
Tulip Crane Arm (Dimensions Folded)	Length 251.5 cm (99") Width 44.5 cm (17.5")
Minimum Height Complete on Pedestal	61 cm (24") Negative to Foot Platform
Maximum Height Complete on Pedestal	420 cm (165") to Typical Camera Lens
	Without Camera Risers.
Maximum Recommended Load Front End	249 kg (550 lbs.)
Maximum Horizontal Reach To Typical Camera Lens	366 cm (144")
Maximum Pan Diameter in Horizontal Mode	732 cm (228")
Minimum Turning Radius With Camera Platform Fully Elevated	121 cm (48")
Minimum Turning Radius With Camera Platform in Lowest Position	228 cm (90")

swissjib Jib

	min. optical height	max. reach	max. height	max. payload	number of counterweights
Version 1	- 2,0 m (-6'7")	3 m (9'10")	3,4 m / (11'2")	90 kg (200 lbs)	7
Version 2	- 3,4 m (-11'2")	5 m (16'5")	4,8 m / (15'9")	80 kg (175 lbs)	14
Version 3	- 4,8 m (-15'9")	7 m (23')	6,2 m / (20'4")	70 kg (150 lbs)	20
Version 4	- 6,2 m (-20'4")	9 m (29'6")	7,6 m / (25')	70 kg (150 lbs)	40
Version 5	- 7,6 m (-24'11")	11 m (36')	9,0 m / (29'6")	45 kg (100 lbs)	40
Version 6	- 9,0 m (-29'5")	13 m (42'8")	10,4 m / (34'1")	25 kg (55 lbs)	40

The weight of the Swissjib in its longest version (Version 6) inclusive the hotdog dolly is only 440 kg (970 lbs)
Das Gesamtgewicht des Swissjib in der längsten Version (Version 6) inklusive des hotdog Dollys beträgt lediglich 440 kg.

Subject to technical alterations without notice
Technische Änderungen vorbehalten.

SWISSJIB / CAMERACRANE FOR REMOTE HEADS

SWISSJIB Camera crane for remote head applications with main arm of Carbon Fibre Composite.

ARMLENGTHS The crane consists of 2 m elements (6.5ft) and can be extended up to 6 elements.

This leads to the following possible arm lengths:

2 / 4 / 6 / 8 / 10 / 12 m
(6.5 / 13.1 / 19.7 / 26.2 / 39.4 ft)

There are two possible set-ups for the carbon fibre arm:

- 1) Carbon fibre arm only, up to 10 m (33ft) length.
- 2) Carbon fibre arm in conjunction with the bracing kit, for 8m (26ft), 10m (33ft) and 12 m (39ft) length and the advantage of higher stability and greater load capacities.

MAX. LOAD CAPACITY / ARM LENGTHS

Number of arm elements (2m each)		1	2	3	4	5	6
Total arm length	Feet	6.5	13.1	19.7	26.2	32.8	39.4
	Meters	2	4	6	8	10	12
Height measured on	Feet	11.1	15.7	20.3	24.9	29.5	34.1
	head part (Mitchell-base)	Meters	3.4	4.8	6.2	7.6	9.0
Max. load without	lbs	200	175	150	110	55	-
	kg	90	80	70	50	25	-
Max. load with	lbs	-	-	-	150	100	55
	kg	-	-	-	70	45	25

ASSEMBLY

On Holdog dolly, Swissdolly. Other products upon request.

Modular system that fits with Cineclib parts.

Head part with Mitchell-mount and built-in levelling.

Adapters for Euro-Standard are available.

The Carbon fibre arm parts already include the track rods and cable channels.

SET-UP TIME

15 minutes for grip with unskilled helper and extremely fast changes in arm length during work.

WEIGHTS

	lbs	kg
12 meter version :		
Holdog dolly incl. column and fork	320	145
6 carbon fibre arm parts and head part	234	106
Arm rear part and counterweight holder	192	87
Bracing complete	106	48
Counterweights (36pcs.)	1273	576

TOTAL OPERATIONAL WEIGHT

2125 962

TEMPERATURE RANGE

-30° C to + 80° C (-20° F to 176° F)

SAFETY

Corrosion free materials combined with quality-controlled production.

Carbon fibre:

QSF-C Certificate from German Aerospace Industry.

Cast aluminium parts:

BVQI / ISO 9002 Quality Management Certification.

TRANSPORTATION

For example in Toyota Hiace, or similar.

Longest piece measures 2 meters (6.6ft)

WARRANTY

3 Years on manufacture and parts, as all Cinerent Technik Products.

Quality Management Certificate

BVQI/ISO 9002

Quality Assurance Requirements

GERMAN AEROSPACE INDUSTRY (BUL)

QSF - C

Specifications subject to be changed without notice. February 1997



Aspect
Ratio Size Description

1.78 : 1 .378 x .212
(HD TV-16x9)
2.39 : 1 .378 x .158

Digital CCD Area
Digital CCD Area
Extracted for Anamorphic

1.37 : 1 .404 x .295
Regular 16mm
Camera Aperture

Various .486 x .295
Super 16mm
Camera Aperture

Panavision
Various .980 x .735
35mm Full
Camera Aperture

Arriflex
Various .945 x .708

Panavision
2.40 : 1 .825 x .690
Anamorphic
Projection Aperture
Anamorphic Projection

Arriflex
2.35 : 1 .839 x .700

1.85 : 1 .825 x .446
35mm 1.85 : 1
Projection Aperture

Panavision
2.40 : 1 .945 x .394
Panavision Super 35
Extracted Area for
Anamorphic Projection

Arriflex
2.35 : 1 .925 x .394

1.33 : 1 .792 x .594
35mm TV Trans. Area
(SMPTE recom. practice)
.713 x .535
35mm TV Safe Action

1.78 : 1 .945 x .531
(HD TV-16x9)
Panavision Super 35
4-Perf Transmitted Area

Various .980 x .546
Panavision 3-Perf 35mm
Camera Aperture

1.78 : 1 .910 x .511
(HD TV-16x9)
3-Perf Transmitted Area

PV GROUND GLASS FORMATS

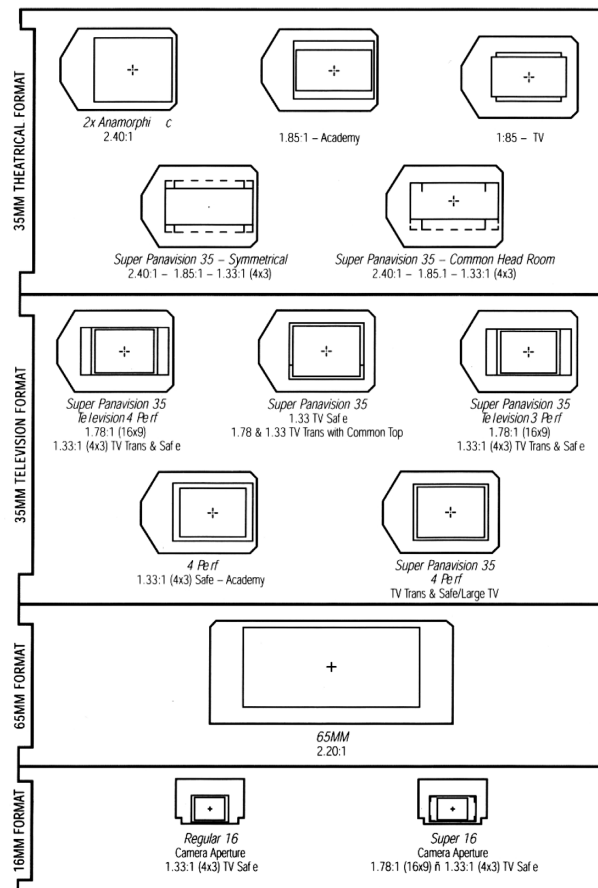

50 Hz HMI FLICKERFREE FILM SPEEDS

Speed (fps) At Any			With Specific Shutter Angles	
Shutter Angle			fps	Shutter Angle
100.000	5.555		55.556	200°
50.000	5.263		54.167	195°
33.333	5.000		52.778	190°
25.000	4.761		48.000	172.8°
20.000	4.545		47.222	170°
16.666	4.347		45.833	165°
14.285	4.166		44.444	160°
12.500	4.000		41.667	150°
11.111	3.333		40.000	144°
10.000	3.125		38.889	140°
9.090	2.500		37.500	135°
8.333	2.000		36.111	130°
7.692	1.250		30.556	110°
7.142	1.000		29.167	105°
6.666			27.778	100°
6.250			24.000	86.4°
5.882			22.222	80°

60 Hz HMI FLICKERFREE FILM SPEEDS

Speed (fps) At Any			With Specific Shutter Angles	
Shutter Angle			fps	Shutter Angle
120.000	6.666		66.667	200°
60.000	6.315		65.000	195°
40.000	6.000		63.333	190°
30.000	5.714		57.600	172.8°
24.000	5.454		56.667	170°
20.000	5.217		55.000	165°
17.143	5.000		53.333	160°
15.000	4.800		50.000	150°
13.333	4.000		48.000	144°
12.000	3.750		46.667	140°
10.909	3.000		45.000	135°
10.000	2.500		43.333	130°
9.231	2.000		36.667	110°
8.571	1.875		35.000	105°
8.000	1.500		33.333	100°
7.500	1.000		26.667	80°
7.058			25.000	75°

ALWAYS USE FILM TESTS TO VERIFY RESULTS

PATH OF THE SUN THROUGHTOUT THE YEAR

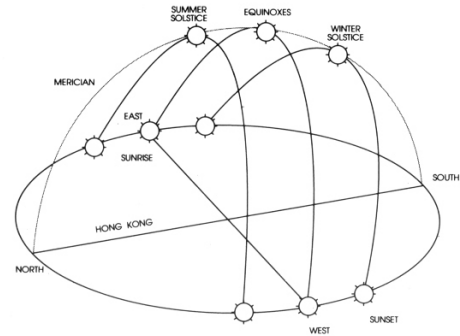

		SUNRISE	TRANSIT	SUNSET
SUMMER SOLSTICE 21/6	AZIMUTH	64	360	296
	ALTITUDE	-1	89	-1
VERNAL AND AUTUMNAL EQUINOXES 21/3, 23/9	AZIMUTH	90	180	270
	ALTITUDE	-1	68	-1
WINTER SOLSTICE 22/12	AZIMUTH	115	180	245
	ALTITUDE	-1	44	-1

The above positions refer in the centre of the Sun's disk. The minus one degree in altitude at sunrise and sunset includes both the apparent radius of the Sun and the affect of atmospheric refraction

Unit : Degrees

DURATION OF TWILIGHT

DURATION OF TWILIGHT (IN MINUTES) IN HONG KONG BEFORE
SUNRISE AND AFTER SUNSET FOR EACH MONTH

DATE		CIVIL TWILIGHT	NAUTICAL TWILIGHT	ASTRONOMICAL TWILIGHT
		MIN	MIN	MIN
JAN	1	24	52	80
	10	24	52	79
	20	24	51	78
FEB	1	23	50	76
	10	23	50	76
	20	23	49	75
MAR	1	23	49	74
	10	22	48	74
	20	22	48	75
APR	1	22	49	75
	10	23	49	76
	20	23	50	77
MAY	1	23	51	79
	10	24	52	81
	20	24	53	83
JUL	1	25	55	86
	10	25	54	85
	20	24	54	84
AUG	1	24	52	82
	10	24	51	80
	20	23	50	78
SEP	1	23	49	76
	10	23	49	75
	20	22	48	75
OCT	1	22	48	74
	10	22	48	74
	20	23	49	75
NOV	1	23	50	76
	10	23	50	77
	20	24	51	78
DEC	1	24	52	79
	10	24	52	80
	20	24	52	80



SALON FILMS (H.K.) LTD.
香港沙龍電影有限公司

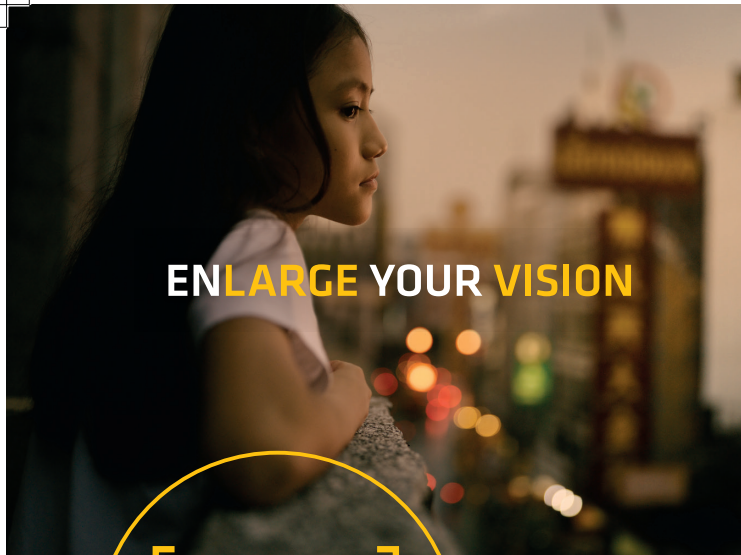

THE NEW LARGE-FORMAT CAMERA SYSTEM

ALEXA LF | *Signature Prime*

ARRI introduces a complete large-format system that meets and exceeds modern production requirements, delivering unprecedented creative freedom. Based on an enlarged 4K version of the ALEXA sensor, it comprises the ALEXA LF camera, ARRI Signature Prime lenses, LPL lens mount and PL-to-LPL adapter. The system also offers full compatibility with existing lenses, accessories and workflows.

www.arri.com/largeformat

For more information please contact:

ARRI ASIA Limited
41st Floor, One Kowloon,
1 Wang Yuen Street, Kowloon Bay,
Kowloon, Hong Kong

Tel. +852 2571 6288
Fax. +852 2875 9181
info@arri.asia



ARRI Signature Prime Lenses – Technical Details

	18/T1.8	21/T1.8	25/T1.8	35/T1.8	40/T1.8
Lens Mount	LPL	LPL	LPL	LPL	LPL
MOD from sensor plane (min. marked distance)	0.35 m / 14"	0.35 m / 14"	0.35 m / 14"	0.35 m / 14"	0.35 m / 14"
MOD from lens front	0.13 m / 5.1"	0.13 m / 5.1"	0.13 m / 5.1"	0.13 m / 5.1"	0.13 m / 5.1"
Length from flange	178 mm / 7.01"	178 mm / 7.01"	178 mm / 7.01"	178 mm / 7.01"	178 mm / 7.01"
Magnification Ratio at MOD (Paraxial)	1:9.2	1:8.2	1:7.1	1:5.4	1:4.8
Entrance pupil position (related to image plane, in direction to object)	189.9 mm / 7.48"	183.4 mm / 7.22"	178.1 mm / 7.01"	162.5 mm / 6.40"	159.8 mm / 6.29"
Angle of view H - V - D for LF Open Gate	91.4° / 71.0° / 102.6°	82.8° / 63.0° / 94.0°	73.0° / 54.4° / 84.0°	55.4° / 40.2° / 65.2°	49.2° / 35.4° / 58.2°
Front diameter	114 mm / 4.49"	114 mm / 4.49"	114 mm / 4.49"	114 mm / 4.49"	114 mm / 4.49"
Max. housing diameter	115 mm / 4.53"	115 mm / 4.53"	115 mm / 4.53"	115 mm / 4.53"	115 mm / 4.53"
Weight (lens only)	2.0 kg / 4.4 lb	2.1 kg / 4.6 lb	1.9 kg / 4.2 lb	1.7 kg / 3.7 lb	1.9 kg / 4.2 lb

	47/T1.8	75/T1.8	125/T1.8	150/T2.5
Lens Mount	LPL	LPL	LPL	LPL
MOD from sensor plane (min. marked distance)	0.45 m / 18"	0.65 m / 26"	1 m / 3' 4"	1.5 m / 5'
MOD from lens front	0.23 m / 9.0"	0.43 m / 16.9"	0.78 m / 2' 7"	1.25 m / 4' 2"
Length from flange	178 mm / 7.01"	178 mm / 7.01"	178 mm / 7.01"	208 mm / 8.19"
Magnification Ratio at MOD (Paraxial)	1:6.3	1:7.2	1:7.0	1:9.0
Entrance pupil position (related to image plane, in direction to object)	156.1 mm / 6.15"	118.6 mm / 4.67"	66.3 mm / 2.61"	145.4 mm / 5.72"
Angle of view H - V - D for LF Open Gate	42.6° / 30.4° / 50.8°	27.6° / 19.4° / 33.2°	16.6° / 11.6° / 20.2°	13.8° / 9.8° / 16.8°
Front diameter	114 mm / 4.49"	114 mm / 4.49"	114 mm / 4.49"	114 mm / 4.49"
Max. housing diameter	115 mm / 4.53"	115 mm / 4.53"	115 mm / 4.53"	135 mm / 5.31"
Weight (lens only)	1.8 kg / 4.0 lb	1.9 kg / 4.2 lb	2.3 kg / 5.1 lb	3.5 kg / 7.7 lb

Technical data are subject to change without notice.

ARRI Camera - Overview



Camera model	ALEXA LF	ALEXA SXT W	ALEXA SXT Studio	ALEXA Mini	AMIRA
Sensor format	Slightly larger than Full Frame35mm	35mm	35mm	35mm	35mm
Sensor/ recording modes	2.39:1, 16:9, Open Gate	16:9, 6.5: 4.3, Open Gate	16:9, 6.5: 4.3, Open Gate	16:9, Open Gate	16:09
Max. number of recorded sensor photo sites	4448 x 3096	3424 x 2202	3424 x 2202	3424 x 2202	3200 x 1800
Frame rate	0.75 – 150 fps	0.75 - 120 fps	0.75 - 120 fps	0.75 - 200 fps	0.75 - 200 fps
Max. frame rate ARRIRAW	150 fps	120 fps	120 fps	48 fps	48 fps
Weight (body & lens mount)	7.8 kg / 17.2 lbs	7.2 kg / 15.9 lbs	8.2 kg / 18.1 lbs	2.3 kg / 5 lbs	4.1 kg / 9.2 lbs
Viewfinder	Electronical	Electronical	Optical	Electronical	Electronical
Shutter	Electronic Shutter, 5.0° - 358°	Electronic shutter, 5.0° to 358.0°	Rotating mirror shutter, 11.2° - 180.0° or Electronic shutter, 5.0° - 358.0°	Electronic shutter, 5.0° to 356.0°	Electronic shutter, 5.0° to 356.0°
Built-in wireless video monitoring	Yes	Yes	No	No	No
Integrated radio for wireless remote control	Yes	Yes	Yes	Yes	No
Multicam interface	No	No	No	Yes	Yes
Behind the lens ND filter	Manual	Manual	Motorized	Motorized	Motorized

All information as of SUP 4.0 (ALEXA LF), SUP 2.0 (ALEXA SXT), SUP 5.4 (ALEXA Mini) and SUP 5.4 (AMIRA)
Technical data are subject to change without notice.

Data Rates

For in-camera recording with ALEXA SXT cameras ⁽⁵⁾



Sensor Mode	Recording File Type (1,2)	Recording Resolution	Output Resolution	Bit Depth	Target Data Rate @ 24 fps (3)	Data Volume @ 24 fps in GB/year/h	Recording Time @ 24fps on					
							SXR Capture Drive 2 TB	SXR Capture Drive 1 TB	XR Capture Drive 512 GB	C-FAST 2.0 256 GB	S/S PRO+ 128 GB	S/S PRO+ 64 GB
16:9	ProRes 4444	HD	1920 x 1080	12	297 Mbit/s	134 GB/h	430 min	215 min	107 min	114 min	54 min	28 min
		2K	2048 x 1152	12	340 Mbit/s	153 GB/h	376 min	188 min	94 min	100 min	47 min	25 min
		3.2K	3200 x 1800	12	830 Mbit/s	374 GB/h	154 min	77 min	38 min	41 min	19 min	10 min
		4K UHD	3840 x 2160	12	1195 Mbit/s	538 GB/h	107 min	53 min	26 min	28 min	-	-
	ARRIRAW	2.8K	2880 x 1620	12	1386 Mbit/s	624 GB/h	189 min	94 min	47 min	-	-	-
6.5	ProRes 4444	3.2K	3168 x 1782	12	1668 Mbit/s	751 GB/h	157 min	78 min	39 min	-	-	-
		2K	2048 x 858	12	253 Mbit/s	114 GB/h	505 min	252 min	126 min	134 min	64 min	33 min
		4K Cine Anamorphic	4096 x 1716	12	1012 Mbit/s	455 GB/h	126 min	63 min	31 min	33 min	16 min	8 min
		2.6K	2592 x 2160 (4)	12	1655 Mbit/s	745 GB/h	158 min	79 min	39 min	-	-	-
	ARRIRAW	2.8K	2880 x 2160	12	896 Mbit/s	403 GB/h	142 min	71 min	35 min	38 min	18 min	9 min
4:3	ProRes 4444	2.8K	2880 x 2160	12	1834 Mbit/s	825 GB/h	142 min	71 min	35 min	-	-	-
	ARRIRAW	2.8K	2880 x 2160	12	1834 Mbit/s	825 GB/h	142 min	71 min	35 min	-	-	-
Open Gate	ProRes 4444	3.4K	3424 x 2202	12	1081 Mbit/s	486 GB/h	118 min	59 min	29 min	31 min	15 min	7 min
	ARRIRAW	3.4K	4096 x 2636	12	1555 Mbit/s	700 GB/h	82 min	41 min	20 min	21 min	-	-
	ARRIRAW	4K Cine	3424 x 2202	12	2214 Mbit/s	996 GB/h	117 min	58 min	29 min	-	-	-
							117 min	58 min	29 min	-	-	-

(1) ProRes is a variable bit rate codec. While it is usually close to the target data rate, the actual data rate can vary with image content.
(2) The ALEXA ProRes target data rate is the Apple target data rate plus metadata and other overhead.
(3) The remaining time indicated by the camera is always calculated based on the theoretical maximum data rate, not the target data rate, to be on the safe side.
(4) The recording resolution is 2592 x 2160, although 2578 x 2160 pixel are used for image content. 14 pixels on the left and right of the recorded image do not belong to the image content and are stated as that in the metadata.
(5) For the data rates in ProRes 4444 XU, 422 HQ and 422 please download from www.arri.com/camera/alexsa/downloads



The Blackmagic URSA Mini Pro 4.6K is the first digital film camera with easy to use features and the controls of a broadcast camera!

The URSA Mini Pro is a true digital film camera with a 4.6K image sensor, 15 stops of dynamic range and a wide color gamut that delivers amazingly rich skin tones, natural color response and incredible detail. You also get built in ND filters, dual C-Fast and SD card recorders, an interchangeable lens mount and more! URSA Mini Pro works in both film and video modes, so it's perfect for digital film or broadcast use all while delivering better image quality!



**Blackmagic Raw
Free Upgrade**

**Blackmagic
URSA Mini Pro
HK\$50,550.00***

Includes DaVinci Resolve 15 Studio
for editing and color correction.

Learn more at www.blackmagicdesign.com/hk

* MSRP excludes sales taxes/duties and shipping costs.
Viewfinder, lens and accessories shown, can be purchased separately.

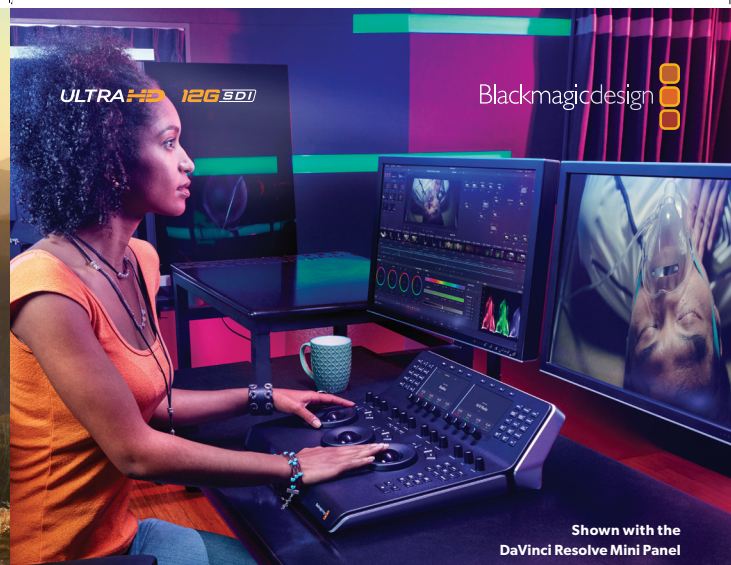

Create cinematic feature film looks faster than ever with DaVinci Resolve 15 and DaVinci Resolve control panels!

The new DaVinci Resolve 15 gives you editing, color correction, audio post and visual effects, all in a single application. You can use DaVinci Resolve as a stand alone software tool, or for faster and more creative color correction options you can add DaVinci Resolve color correction control panels. You get fluid, hands-on control with smooth, high resolution weighted trackballs, precision engineered knobs and dials, and a logical layout that puts everything you need right at your fingertips. DaVinci Resolve color correction panels let you adjust multiple parameters at the same time, to create unique looks that are simply impossible with a mouse and keyboard!

Software

DaVinci Resolve 15 **Free Download**
DaVinci Resolve 15 Studio **HK\$2,550***

Hardware

DaVinci Resolve Micro Panel **HK\$8,400***
DaVinci Resolve Mini Panel **HK\$25,250***
DaVinci Resolve Advanced Panel **HK\$252,900***

Learn more at www.blackmagicdesign.com/hk

* MSRP excludes sales taxes/duties and shipping costs.

Blackmagic URSA Mini Pro

DESCRIPTION	URSA Mini Pro is a professional digital film camera that combines incredible 4.6K image quality with the features and controls of a traditional broadcast camera! You get a Super 35mm 4.6K sensor with 15 stops of dynamic range that's perfect for feature films and can also be instantly switched to traditional video mode for regular video work. Also included are built in ND filters, user changeable lens mount, plus RAW and ProRes format recording to dual media CFast or SD cards. URSA Mini Pro is a perfectly balanced, compact body that's comfortable enough to be used all day!
-------------	--

CAMERA FEATURES

Effective Sensor Size	25.34mm x 14.25mm (Super35)
Lens Mount	EF mount included. Interchangeable with optional PL, B4 and F lens mounts.
Lens Control	Electronic control via EF mount pins or 12-pin broadcast connector for compatible lenses.
Dynamic Range	15 Stops.
Shooting Resolutions	4608 x 2592, 4608 x 1920 (4.6K 2.40:1), 4096 x 2304 (4K 16:9), 4096 x 2160 (4K DCI), 3840 x 2160 (Ultra HD), 3072 x 2560 (3K Anamorphic), 2048 x 1152 (2K 16:9), 2048x1080 (2K DCI), 1920 x 1080
Frame Rates	Maximum sensor frame rate dependent on resolution and codec selected. Project frame rates of 23.98, 24, 25, 29.97, 30, 50, 59.94 and 60 fps supported. Off-speed frame rates up to 60p in 4.6K, 120p in 2K windowed.
Built in ND Filters	Four position ND filter wheel with clear, 2-stop, 4-stop and 6-stop ND filters.
Focus	Focus button turns on peaking, auto focus available using compatible lenses.
Iris Control	Iris wheel and touchscreen slider for manual iris adjustment on electronically controllable lenses, iris button for instant auto iris settings on compatible lenses so no pixel is clipped in film mode. Scene average auto exposure in video mode.
Screen Dimensions	4 inch 1920 x 1080
Screen Type	LCD capacitive touchscreen.
Metadata Support	Automatically populated lens data from electronic EF, B4 and iTechnology compatible PL lenses. Automatic recording of camera settings and slate data such as project, scene number, take and special notes.
Controls	Touchscreen menus on 4 inch screen. Push buttons for other controls. 2 assignable shortcut keys.
Timecode Clock	Highly accurate timecode clock. Less than 1 frame drift every 8 hours.

Blackmagic URSA Mini Pro

CONNECTIONS	
Total Video Inputs	1 x SDI
Total Video Outputs	1 x SDI, 1 x SDI Monitoring.
SDI Rates	1.5G, 3G, 6G, 12G.
Analog Audio Inputs	2 x XLR analog switchable between mic, line and AES audio. Phantom power support.
Analog Audio Outputs	1 x 3.5mm headphone jack, supports iPhone microphone for talkback.
Reference Input	Tri-Sync/Black Burst/Timecode.
Remote Control	2 x 2.5mm LANC input for Rec Start/Stop, plus Iris and Focus control using compatible lenses.
Computer Interface	USB Type-C for software updates.

AUDIO

Microphone	Integrated stereo microphone.
Built in Speaker	1 x mono speaker.

STANDARDS

SD Video Standards	None.
HD Video Standards	1080p23.98, 1080p24, 1080p25, 1080p29.97, 1080p30, 1080p50, 1080p59.94, 1080p60 1080i50, 1080i59.94, 1080i60
Ultra HD Video Standards	2160p23.98, 2160p24, 2160p25, 2160p29.97, 2160p30, 2160p50, 2160p59.94, 2160p60
SDI Compliance	SMPTE 292M, SMPTE 424 Level B, SMPTE 2081-1, SMPTE 2082-1
SDI Audio Sampling	48 kHz and 24 bit.

MEDIA

Media	2 x CFast for 4.6K RAW and ProRes recording. 2 x SD UHS-II card slots for HD and Ultra HD recording.
Media Format	Can format cards to ExFAT for Windows and Mac or HFS+ for Mac (file systems).

SUPPORTED CODECS

Codecs	CinemaDNG RAW, CinemaDNG RAW 3:1, CinemaDNG RAW 4:1, Apple ProRes 4444 XQ QuickTime, ProRes 4444 QuickTime, ProRes 422 HQ QuickTime, ProRes 422 QuickTime, ProRes 422 LT QuickTime and ProRes 422 Proxy QuickTime.
--------	--

CONTROL

External Control	Blackmagic SDI Control Protocol, iPad control, Bluetooth control, 2 x 2.5mm LANC for lens and record control.
------------------	---

COLOR CORRECTOR

Color Corrector	DaVinci YRGB.
-----------------	---------------

TALKBACK AND TALLY

Talkback	SDI Channels 15/16 and iPhone headset.
Live Tally Indicator	Tally on LCD, URSA Viewfinder and URSA Studio Viewfinder.

Blackmagic URSA Mini Pro

STORAGE FEATURES	
Storage Type	2 x CFast 2.0 2 x SD UHS-II cards
Storage Rates	4608 x 2592 CinemaDNG RAW - 513MB/s CinemaDNG RAW 3:1 - 180 MB/s CinemaDNG RAW 4:1 - 135 MB/s 3840 x 2160 Apple ProRes 444 XQ - 250 MB/s Apple ProRes 444 - 165 MB/s Apple ProRes 422 HQ - 110 MB/s Apple ProRes 422 - 73.6 MB/s Apple ProRes 422 LT - 51 MB/s Apple ProRes Proxy - 22.4 MB/s 1920 x 1080 Apple ProRes 444 XQ - 62.5 MB/s Apple ProRes 444 - 41.25 MB/s Apple ProRes 422 HQ - 27.5 MB/s Apple ProRes 422 - 18.4 MB/s Apple ProRes 422 LT - 12.75 MB/s Apple ProRes Proxy - 5.6 MB/s Storage rates based on 30 frames per second.
Recording Formats	Lossless CinemaDNG RAW, RAW 3:1 and RAW 4:1 with film dynamic range at 4608 x 2592, 4608 x 1920, 4096 x 2304, 4096 x 2160, 3072 x 2560, 2048 x 1152, 2048 x 1080 and 1920 x 1080. Apple ProRes 4608 x 2592, 4608 x 1920, 4096 x 2304, 4096 x 2160, 3072 x 2560, 2048 x 1152, 2048 x 1080 and 1920 x 1080 with either film or video dynamic range.

SOFTWARE	
Software Included	URSA Mini Operating System. DaVinci Resolve Studio grading software including Resolve USB dongle for Mac OS X and Windows. Blackmagic Camera Setup.

OPERATING SYSTEMS	
	Mac OS X 10.11 El Capitan, macOS 10.12 Sierra or later. Windows 8.1 or Windows 10.

POWER REQUIREMENTS	
Power Supply	1 x External 12V power supply.
External Power Input	1 x 4-pin XLR port for external power or battery use. 1 x 12-pin Molex connector on rear battery plate. Custom V-mount battery plate with D-tap +12V regulated output from camera.
Power	Rear camera mount compatible with industry standard V-mount or gold mount battery plates.

Blackmagic URSA Mini Pro

ACCESSORIES	
Optional Accessories	URSA Mini Pro PL, EF, B4 and F mounts URSA Mini Shoulder Kit including top handle and extender arm URSA Viewfinder URSA Studio Viewfinder URSA Mini Pro Shim Kit URSA VLock Battery Plate URSA Mini Mini Mic Mount

PHYSICAL SPECIFICATIONS	
Width:	202mm
Height:	146.8mm
Depth:	209mm
Weight:	2.31kg

ENVIRONMENTAL SPECIFICATIONS	
Operating Temperature	0°to 40°C (32° to 104°F)
Storage Temperature	-20°to 45°C (-4° to 113°F)
Relative Humidity	0% to 90% non-condensing

WHAT'S INCLUDED	
	URSA Mini Pro body Turret dust cap EF lens mount Side Handle with LANC Cable and strap Power supply SD card with software and manual DaVinci Resolve Studio activation license key

WARRANTY	
	12 Month Limited Manufacturer's Warranty.



SALON FILMS (H.K.) LTD.
香港沙龍電影有限公司

XEEN™
 X-EXPERIENCES



Discover to Create

SAMYANG
VDSLR II CINE LENS

complete your cinematic creative with Samyang VDSLR II CINE LENS



8mm T3.8 10mm T3.1 16mm T2.2 12mm T3.1 14mm T3.1 24mm T1.5 35mm T1.5 50mm T1.5 85mm T1.5 100mm T3.1 135mm T2.2

SAMYANG^{XP}
 Premium Lens Series



10mm F3.5 14mm F2.4 35mm F1.2 50mm F1.2 85mm F1.2



BRONSTER
 COMPANY LIMITED

+852 2368 4328

www.bronster.com.hk

enquiry@bronster.com.hk

Specification

Focal length	14mm	16mm	20mm	24mm	35mm	50mm	85mm	135mm
Maximum T-stop	T3.1	T2.6	T1.9	T1.5	T1.5	T1.5	T1.5	T2.2
Negative size	24x36mm	24x36mm	24x36mm	24x36mm	24x36mm	24x36mm	24x36mm	24x36mm
Angle of view	Full Frame (1:1x)	108.91°	94.82°	84.1°	63.4°	46.2°	28.4°	18.7°
	Super 35	87.43°	75.31°	61.2°	46.9°	31.2°	19.0°	13.5°
	APS-C (1:1.5x)	82.02°	70.28°	60.4°	43.1°	30.8°	18.7°	12.3°
	APS-C (1:1.6x)	79.85°	68.94°	57.3°	41.5°	29.0°	17.7°	11.5°
Focusing range	Micro Four Thirds (1:2x)	66.86°	56.06°	47.6°	33.4°	23.6°	14.4°	9.48°
	∞ to 0.28m	∞ to 0.30m	∞ to 0.20m	∞ to 0.25m	∞ to 0.33m	∞ to 0.45m	∞ to 1.12m	∞ to 0.8m
Front size	Φ114mm	Φ114mm	Φ114mm	Φ114mm	Φ114mm	Φ114mm	Φ114mm	Φ114mm
Number of blades	9	11	11	11	11	11	11	11
Size	PL	Φ117.6x113.7mm	Φ117.6x113.7mm	Φ117.6x113.7mm	Φ117.6x113.7mm	Φ117.6x113.7mm	Φ117.6x113.7mm	Φ117.6x113.7mm
	Canon EF	Φ117.6x83.3mm	Φ117.6x95.3mm	Φ117.6x121.7mm	Φ117.6x121.7mm	Φ117.6x121.7mm	Φ117.6x121.7mm	Φ117.6x121.7mm
	Nikon F	Φ117.6x85.8mm	Φ117.6x92.8mm	Φ117.6x119.2mm	Φ117.6x119.2mm	Φ117.6x119.2mm	Φ117.6x119.2mm	Φ117.6x119.2mm
	Sony E	Φ117.6x114.3mm	Φ117.6x121.3mm	Φ117.6x147.7mm	Φ117.6x147.7mm	Φ117.6x147.7mm	Φ117.6x147.7mm	Φ117.6x147.7mm
Angle	Micro Four Thirds	Φ117.6x113.1mm	Φ117.6x120.1mm	Φ117.6x146.5mm	Φ117.6x146.5mm	Φ117.6x146.5mm	Φ117.6x146.5mm	Φ117.6x146.5mm
	Focus angle	200°	200°	200°	200°	200°	200°	200°
	Iris angle	30°	32.5°	37.5°	40°	40°	40°	35°
	PL	1,170g	1,175g	970g	1,180g	1,360g	1,600g	1,382g
Weight (without Lens cap)	Canon EF	1,170g	1,175g	1,010g	1,180g	1,375g	1,600g	1,394g
	Nikon F	1,125g	1,130g	935g	1,135g	1,320g	1,115g	1,200g
	Sony E	1,175g	1,180g	990g	1,185g	1,380g	1,650g	1,407g
	Micro Four Thirds	1,175g	1,180g	1,000g	1,185g	1,380g	1,650g	1,413g

SAMYANG^{XP}

Specification

Focal Length	10mm	14mm	35mm	50mm	85mm
Aperture Range	F3.5 ~ F22	F2.4 ~ F22	F1.2 ~ F16	F1.2 ~ F16	F1.2 ~ F16
Lens Optical	Construction	18 Elements in 14 Groups	12 Elements in 10 Groups	11 Elements in 8 Groups	10 Elements in 7 Groups
	Special Lens	2 ASP, 1 HSP, 1 ED, 1 HR	2 ASP, 3 HR, 1 ED	1 ASP, 1 HR	1 ASP, 2 HR
Minimum Focusing Distance	0.26 m	0.28 m	0.34 m	0.45 m	0.8 m
Number of Blades	7	9	9	9	9
Filter Size (mm)	-	-	Ø 86 mm	Ø 86 mm	Ø 86 mm
Maximum Diameter	Ø 95 mm	Ø 95 mm	Ø 93 mm	Ø 93 mm	Ø 93 mm
Mount	Canon EF	Canon EF, Nikon, Sony E	Canon EF	Canon EF	Canon EF
Angle of View	Full Frame	130°	114.12°	46.6°	28.52°
	APS-C	104°	89.52°	31°	18.98°
Length (mm)	98.1 mm	109.4 mm	117.4 mm	117.4 mm	18.98°
Weight (g) without Lens Cap, Hood	731 g	791 g	1,106 g	1,200 g	1,050 g
Weight (g)	779 g	782 g	1,205 g	1,300 g	1,300 g



SALON FILMS (H.K.) LTD.
香港沙龍電影有限公司

Canon

Delighting You Always



CINEMA EOS SYSTEM



熱線: 3191 2333 | hk.canon

佳能香港有限公司總經銷 ISO 9001、ISO 14001、ISO 27001 (佳能數碼製作中心) 及 OHSAS 18001 之管理體系認證
佳能香港有限公司總辦事處 香港九龍紅磡灣道18號中國人壽中心A座5樓
Canon Image[®] 佳能數碼影像坊 • 佳能客戶服務中心 九龍尖沙咀彌敦道63號國泰廣場20樓

Canon EOS C700 / C700 PL / C700 GS PL Specifications

System

• Recording System

Movies: Video compression: MPEG-4 AVC/H.264, Intra-frame or Long GOP / Apple ProRes
Audio compression: Linear PCM, 24 bit, 48 kHz, 4 channels
File format: MXF, Apple QuickTime File Format
Photos: DCF (Design rule for Camera File system), compatible with Exif Ver. 2.3, JPEG compression

• Video Configuration (recording/playback)

Recordings on the CFast card:

Format : XF-AVC (main recording/sub recording), ProRes (main recording)
Bit rate (XF-AVC) : 810 Mbps, 440 Mbps, 410 Mbps, 360 Mbps, 310 Mbps, 225 Mbps, 210 Mbps, 170 Mbps, 160 Mbps (Intra-frame); 50 Mbps (Long GOP)
Codec (ProRes) : Apple ProRes 4444, ProRes 422 HQ, ProRes 422
Resolution : 4096x2160, 3840x2160, 2048x1080, 1920x1080
Color sampling : YCbCr 4:2:2, 10 bit; RGB 4:4:4, 12 bit; RGB 4:4:4, 10 bit
Frame rate : 59.94P, 59.94i, 50.00P, 50.00i, 29.97P, 23.98P, 25.00P, 24.00P

Recordings on the SD card:

Format : XF-AVC Proxy (sub recording)
Bit rate : 35 Mbps, 24 Mbps (Long GOP)
Resolution : 2048x1080, 1920x1080
Color sampling : YCbCr 4:2:0, 8 bit
Frame rate : 59.94P, 59.94i, 50.00P, 50.00i, 29.97P, 23.98P, 25.00P, 24.00P

• Recording Media (not included)

Main recording/sub recording: CFast 2.0 card (2 slots)
Sub recording and photos: SD, SDHC (SD High Capacity) or SDXC (SD eXtended Capacity) memory card

• Image Sensor

C700 / C700 PL : Super 35mm-equivalent CMOS sensor
C700 GS PL : Super 35mm-equivalent CMOS sensor with global electronic shutter
Effective pixels : When the resolution is 4096x2160 or 2048x1080: approx. 8,850,000 pixels (4096x2160)
When the resolution is 3840x2160 or 1920x1080: approx. 8,290,000 pixels (3840x2160)
When the main recording format is [RAW (Capture Drive)]:
C700 / C700 PL: approx. 10,720,000 pixels (4512x2376)
C700 GS PL: approx. 10,150,000 pixels (4272x2376)

• Control Display

7.66 cm (3.0 in.) color LCD, approx. 1,036,000 dots, aspect ratio 3:2

• Lens Mount

C700 : Canon EF mount with Cinema Lock compatible with Canon EF lenses
C700 PL / C700 GS PL: PL mount compatible with EF Cinema lenses (PL mount) and Cooke's /i Technology
Lens multiplication factor for 35mm equivalent focal length (approximate):
When the resolution is 4096x2160, 2048x1080: 1.460
When the resolution is 3840x2160, 1920x1080: 1.534

• Shutter Speed

Speed (1/3-stop increments or 1/4-stop increments), angle, clear scan, slow, off

• Iris

Manual (1/2-stop increments or 1/3-stop increments, fine adjustment available), push auto iris, automatic aperture

• ISO Speed

C700 / C700 PL: ISO 100 to ISO 102400 / C700 GS PL: ISO 200 to ISO 102400 (1-stop or 1/3-stop increments)

• Gain

C700 / C700 PL: -6 dB to 54 dB / C700 GS PL: -6 dB to 48 dB (3-dB increments),
C700 / C700 PL: -2 dB to 54 dB / C700 GS PL: -2 dB to 48 dB (fine adjustment in 0.5-dB increments)

• ND Filter: Built-in (Off, 2, 4, 6, 8 or 10 stops), motor operated

• Exposure: AE shift, light metering modes (standard, spotlight, backlight)

• White Balance

Auto white balance (AWB); custom white balance [2 sets, A and B]; user-set white balance [5 settings, 2,000 K to 15,000 K]; two preset settings (daylight and tungsten lamp)
Color temperature and color compensation (CC) adjustment available for all settings except AWB.

• Focus

Manual focus
C700 only: Also autofocus (one-shot AF, AF-boosted MF, continuous AF); face AF and subject tracking
C700: AF type: Dual Pixel CMOS AF, contrast-detection AF

• Subject Illumination (ISO 25600, with a f/1.2 lens, 100% output)

59.94 Hz: 0.45 lux (shutter speed 1/30)
50.00 Hz: 0.38 lux (shutter speed 1/25)

• Built-In Microphone: Monaural electric condenser microphone

Terminals

• SDI OUT Terminals (SDI OUT 1 to SDI OUT 4) / MON, Terminals (MON, 1 and MON, 2)
BNC jack, output only, 0.8 Vp-p / 75 Ω, unbalanced
3G-SDI: SMPTE 424, SMPTE 425, SMPTE ST 299-2
HD-SDI: SMPTE 292, SMPTE ST 299-1 Embedded audio, time code (VITC/LTC)

• HDMI OUT Terminal: HDMI connector, output only

• VIDEO Terminal: Proprietary connector for the optional EVF-V70 OLED Electronic Viewfinder, output only

• INPUT Terminals (INPUT 1 and INPUT 2)

XLR 3-pin jack (pin1: shield, pin2: hot, pin3: cold), 2 sets, balanced

Analog Inputs Sensitivity:

MIC setting: -60 dBu (volume center, full scale -18 dB) / 600 Ω

LINE setting: 4 dBu (volume center, full scale -18 dB) / 10 kΩ

Microphone attenuator: 20 dB

Digital Inputs (AES/EBU)

AES3 standard (48 kHz, 24 bit, 2ch) / 110 Ω

• MIC Terminal

Ø 3.5 mm stereo mini-jack, -72 dBV (volume center, full scale -18 dB) / 1.2 kΩ

Microphone attenuator: 20 dB

• Headphone Terminal

Ø 3.5 mm stereo mini-jack, -α to -8 dBV (16 Ω load, volume range Min to Max) / 50 Ω or less

• GENLOCK/SYNC OUT Terminal

BNC jack, 1.0 Vp-p / 75 Ω

GENLOCK setting: input only; SYNC OUT setting: output only, tri-level HD signal

• TIME CODE IN/OUT Terminal

BNC jack, input/output

Input setting: 0.5 Vp-p to 18 Vp-p / 100 kΩ; Output setting: 1.3 Vp-p / 50 Ω or less

• REMOTE A Terminal, REMOTE B Terminal

REMOTE A: Ø 2.5 mm stereo sub-mini jack

REMOTE B: Circular 8-pin jack (for the optional RC-V100 Remote Controller, RS-422 interface)

• CTRL Terminal: LEMO circular 7-pin jack (for the optional OU-700 Remote Operation Unit)

Power/Others

• Compatible Batteries: V-mount batteries, rated input: 14.8 V DC (acceptable range: 12 V to 20 V DC)

• DC IN 12V Terminal

XLR 4-pin jack (male connector), rated input: 12 V DC

(acceptable range: 11.5 V to 20 V DC), 10 A (acceptable maximum load current)

• DC OUT 24V 2A Terminal: Fischer 3-pin connector, rated output: 24 V DC, maximum current: 2.0 A

• DC OUT 12V 2A Terminal: LEMO 2-pin connector, rated output: 12 V DC, maximum current: 2.0 A

• D-TAP Terminal: D-Tap connector, maximum output: 50 W (nominal)

• Power Consumption

49.3 W (XF-AVC, 4K recording at 59.94P or 50.00P), 59.1 W (ProRes 422 HQ, 4K recording at 29.97P or 25.00P)

• Operating Temperature: 0 - 40 °C (32 - 104 °F)



SALON FILMS (H.K.) LTD.
香港沙龍電影有限公司



Anamorphic/3
Full Frame Plus

Prime Lenses T2.3

32mm / 40mm / 50mm / 50mm / 75mm / 100mm /
 135mm / 180mm



Tokina
CINEMA ATX

VISTA
 BEYOND FULL FRAME



smallHD COM

FOCUS SERIES

5吋觸控高亮度機頂監視器



K 5600
 LIGHTING



LEE
 Filters

oconnor



sachtler

Schneider OPTICS

迎光 **SEKONIC**

smallHD COM



TIFFEN

Tokina
CINEMA ATX

CS 正成集團
 影視器材總匯
 中國、香港、澳門、台灣代理
 www.chengseng.com

北京正晟貿易有限公司 Tel: +86-10-5870-0996
 上海邑威商貿有限公司 Tel: +86-21-3372-8678
 香港正成商貿控股有限公司 Tel: +852-5425-5005
 台灣正成貿易股份有限公司 Tel: +886-2-8511-1311



Cooke S7/i[®] Prime Lenses T2.0

16mm / 18mm / 21mm / 25mm / 27mm / 32mm / 40mm / 50mm / 65mm / 75mm /
135mm / 180mm

S7/i[®]

	16mm	18mm	21mm	25mm	27mm	32mm	40mm	50mm	65mm	75mm	100mm	135mm
T-stop Range	TBC	T2-T22	T2-T22	T2-T22	T2-T22	T2-T22	T2-T22	T2-T22	T2-T22	T2-T22	T2-T22	T2-T22
Angular Rotation of Iris Scale	TBC	90°	90°	90°	90°	90°	90°	90°	90°	90°	90°	90°
Min. Marked Object Distance	TBC	400 mm 16 in	400 mm 16 in	350 mm 14 in	350 mm 14 in	350 mm 14 in	450 mm 18 in	500 mm 20 in	475 mm 20 in	475 mm 19 in	700 mm 30 in	950 mm 39 in
Close Focus from Lens Front	TBC	158 mm 6 in	158 mm 6 in	109 mm 4 in	109 mm 4 in	109 mm 4 in	209 mm 8 in	259 mm 10 in	235 mm 10 in	234 mm 9 in	459 mm 18 in	709 mm 28 in
Angular Rotation to MOD Endstop	TBC	270°	270°	270°	270°	270°	270°	270°	270°	270°	270°	270°
Max. Diagonal Angle of View for Super 35 Format	TBC	78°	70°	61°	56°	50°	41°	33°	27°	23°	17°	13°
Maximum Diagonal Angle of View for 24 x 36mm Format	TBC	100°	91°	82°	76°	68°	57°	47°	37°	32°	24°	18°
Length from front of Lens to Lens Mount	TBC	200 mm 7.87 in	189 mm 7.44 in	189 mm 7.44 in	189 mm 7.44 in	189 mm 7.44 in	189 mm 7.44 in	189 mm 7.44 in	189 mm 7.44 in	189 mm 7.44 in	189 mm 7.44 in	189 mm 7.44 in
Max Front Diameter	TBC	110 mm 4.33 in	110 mm 4.33 in	110 mm 4.33 in	110 mm 4.33 in	110 mm 4.33 in	110 mm 4.33 in	110 mm 4.33 in	110 mm 4.33 in	110 mm 4.33 in	110 mm 4.33 in	110 mm 4.33 in
Total Weight	TBC	3.5 kg 7.7 lbs	3.3 kg 7.28 lbs	3.3 kg 7.28 lbs	3.3 kg 7.28 lbs	3.4 kg 7.5 lbs	3.5 kg 7.72 lbs	3.4 kg 7.5 lbs	3.0 kg 6.61 lbs	3.0 kg 6.61 lbs	3.3 kg 7.28 lbs	3.7 kg 8.16 lbs

*Specifications are subject to change without prior notice.



Vista Cinema Prime

卡口	18mm		25mm		35mm	
	PL	EF	PL	EF	PL	EF
焦點距離	18mm		25mm		35mm	
光圈	T1.5 ~ T22		T1.5 ~ T22		T1.5 ~ T22	
光學結構	14 群 17 枚		15 群 16 枚		13 群 14 枚	
成像直徑	ø 46.7mm		ø 46.7mm		ø 46.7mm	
最短拍攝距離	0.45m		0.35m		0.41m	
最大微距倍率	1 : 14.37		1 : 7.80		1 : 7.81	
光圈葉片數	9 片		9 片		9 片	
濾鏡口徑	—		112mm		112mm	
前端直徑	ø 114mm		ø 114mm		ø 114mm	
最大直徑	ø 114mm (不含腳架接座)		ø 114mm (不含腳架接座)		ø 114mm (不含腳架接座)	
重量	2.68kg	2.76kg	2.19kg	2.27kg	2.03kg	2.11kg

卡口	50mm		85mm		105mm	
	PL	EF	PL	EF	PL	EF
焦點距離	50mm		85mm		105mm	
光圈	T1.5 ~ T22		T1.5 ~ T22		T1.5 ~ T22	
光學結構	10 群 13 枚		13 群 14 枚		13 群 19 枚	
成像直徑	ø 46.7mm		ø 46.7mm		ø 46.7mm	
最短拍攝距離	0.48m		0.95m		1.15m	
最大微距倍率	1 : 7.01		1 : 9.92		1 : 9.88	
光圈葉片數	9 片		9 片		9 片	
濾鏡口徑	112mm		112mm		112mm	
前端直徑	ø 114mm		ø 114mm		ø 114mm	
最大直徑	ø 114mm (不含腳架接座)		ø 114mm (不含腳架接座)		ø 114mm (不含腳架接座)	
重量	2.11kg	2.19kg	2.15kg	2.23kg	2.56kg	2.64kg

*支援卡口: PL / EF / MFT / E

*Specifications are subject to change without prior notice.

CS 正成集團
影視器材總匯
中國、香港、澳門、台灣代理
www.chengseng.com

北京正晟貿易有限公司 Tel: +86-10-5870-0996
上海邑威商貿有限公司 Tel: +86-21-3372-8678
香港正成商貿控股有限公司 Tel: +852-5425-5005
台灣正成貿易股份有限公司 Tel: +886-2-8511-1311

CS 正成集團
影視器材總匯
中國、香港、澳門、台灣代理
www.chengseng.com

北京正晟貿易有限公司 Tel: +86-10-5870-0996
上海邑威商貿有限公司 Tel: +86-21-3372-8678
香港正成商貿控股有限公司 Tel: +852-5425-5005
台灣正成貿易股份有限公司 Tel: +886-2-8511-1311



SALON FILMS (H.K.) LTD.
香港沙龍電影有限公司



SHRIRO

+852 2524 5031

video.cine@shriro.com.hk

www.shriro.com.hk



Technical data --- ZEISS Cine lenses

Supreme Prime

	Release	Aperture	Close focus ¹	Length ²	Front diameter	Weight	Horizontal Angle of View	
							Full Frame ³	Super 35 ⁵
15 mm / T1.8	2020	T 1.8-22	TBD	TBD	114 mm	TBD	TBD	TBD
18 mm / T1.5	2020	T 1.5-22	TBD	TBD	114 mm	TBD	TBD	TBD
21 mm / T1.5	2019 Q3	T 1.5-22	0.35 m	119 mm	95 mm	1.5 kg	79.5°	59.8°
25 mm / T1.5	Available	T 1.5-22	0.26 m	119 mm	95 mm	1.42 kg	70.8°	52.3°
29 mm / T1.5	Available	T 1.5-22	0.33 m	121 mm	95 mm	1.61 kg	64°	46.8°
35 mm / T1.5	Available	T 1.5-22	0.45 m	119 mm	95 mm	1.40 kg	55°	39°
50 mm / T1.5	2019 Jun	T 2.1-22	0.60 m	121 mm	95 mm	1.63 kg	30.5°	21.3°
65 mm / T1.5	Available	T 1.5-22	0.84 m	119 mm	95 mm	1.42 kg	24°	16.7°
100 mm / T1.5	Available	T 1.5-22	1.1 m	119 mm	95 mm	1.7 kg	20.4°	14.2°
135 mm / T1.5	2019 Q3	T 1.5-22	1.35 m	146 mm	114 mm	2.3 kg	15.6°	10.9°
150 mm / T1.8	2019 Q4	T 1.8-22	1.5 m	146 mm	114 mm	2.3 kg	13.7°	9.5°
200 mm / T2.1	2020	T 2.1-22	TBD	TBD	114 mm	TBD	TBD	TBD

CP.3XD

	Aperture	Close focus ¹	Length ²	Front diameter	Weight	Horizontal Angle of View			
						Full Frame ³	Super 35 ⁵	Normal 35°	MFT ⁸
15 mm / T2.9	T 2.9-22	0.3 m	83.7 mm	95 mm	0.87 kg	100°	79°	73°	60°
18 mm / T2.9	T 2.9-22	0.3 m	83.7 mm	95 mm	0.86 kg	89°	69°	63°	51°
21 mm / T2.9	T 2.9-22	0.24 m	83.7 mm	95 mm	0.82 kg	81°	61°	55°	45°
25 mm / T2.1	T 2.1-22	0.26 m	83.7 mm	95 mm	0.82 kg	72°	53°	47°	38°
28 mm / T2.1	T 2.1-22	0.24 m	83.7 mm	95 mm	0.84 kg	65°	47°	43°	34°
35 mm / T2.1	T 2.1-22	0.3 m	83.7 mm	95 mm	0.80 kg	54°	39°	35°	28°
50 mm / T2.1	T 2.1-22	0.45 m	83.7 mm	95 mm	0.77 kg	40°	34°	25°	20°
85 mm / T2.1	T 2.1-22	1.0 m	83.7 mm	95 mm	0.88 kg	24°	20°	17°	15°
100 mm / T2.1 CF ⁹	T 2.1-22	0.7 m	126.5 mm	95 mm	1.01 kg	20°	17°	14°	13°
135 mm / T2.1	T 2.1-22	1.0 m	126.5 mm	95 mm	1.15 kg	15°	11°	9°	7°



Technical data --- ZEISS Cine lenses

CZ.2

	Aperture	Close focus ¹	Length ²	Front diameter	Weight	Horizontal Angle of View			
						Full Frame ³	Super 35 ⁵	Normal 35°	MFT ⁸
CZ.2 15-30 mm / T2.9	T 2.9-22	0.85 m	198 mm	114 mm	2.6 kg	100-62°	79-46°	72-41°	59-33°
CZ.2 28-80 mm / T2.9	T 2.9-22	0.83 m	196 mm	95 mm	2.5 kg	25-66°	21-57°	18-43°	12-34°
CZ.2 70-200 mm / T2.9	T 2.9-22	1.5 m	250 mm	95 mm	2.8 kg	10-29°	7-20°	6-18°	5-14°

LWZ.3									
LWZ.3 21-100 mm / T2.9-3.9	T 2.9-22	0.8 m	226 mm	114 mm	2.0 kg	N/A	61-14°	55-12°	45-9°

- 1) Close focus distance is measured from the image plane
- 2) Front to PL mount flange
- 3) Horizontal angle of view for a full-frame camera aperture (aspect ratio 1:1.5, dimensions 36 mm x 24 mm)
- 4) Horizontal angle of view for an APS-H camera aperture (aspect ratio 1:1.81, dimensions 30.2 mm x 16.7 mm)
- 5) Horizontal angle of view for an ANSI Super 35 Silent camera aperture (aspect ratio 1:1.33, dimensions 24.9 mm x 18.7 mm)
- 6) Horizontal angle of view for a Normal 35 Academy camera aperture (aspect ratio 1:1.37, dimensions 22 mm x 16 mm)
- 7) Horizontal angle of view for an APS-C camera aperture (aspect ratio 1:1.50, dimensions 22.3 mm x 14.9 mm)
- 8) Horizontal angle of view for a Micro 4/3 (MFT) camera aperture (aspect ratio 1:1.33, dimensions 17.3 mm x 13 mm)
- 9) CF: Close focus capability



SHIRO

www.shiro.com.hk

+852 2524 5031

video.cine@shiro.com.hk

SONY

Perfection re-defined

The new Sony BVM-HX310 4K TRIMASTER HX™ professional master monitor scores for colour accuracy, true blacks and high-contrast performance, making it the perfect choice for colour grading, 4K HDR production workflow and quality control.

- Pinpoint colour accuracy even from a single pixel with Sony's proprietary TRIMASTER HX LCD screen
- Delivers 1,000 nits* of brightness in full screen with 1,000,000:1 contrast ratio – perfect for HDR and true blacks
- Supports industry-leading colour gamuts including DCI-P3, ITU-R BT.2020, S-Gamut3.cine and S-Gamut3
- Quad-View Display Function with individual customised settings

* Typical at D65



4K

For more information,
please visit www.pro.sony

BVM-HX310
Professional Master Monitor

Beyond Definition

SONY

Full-frame splendour

Sony's next generation motion picture camera system with forward thinking full frame sensor, just got even better with the new V3.0 firmware upgrade.

VENICE

- 36mm x 24mm full-frame 6K sensor for superior depth of field with dual based ISO
- Supports anamorphic, Super 35mm, full-frame PL and E-mount lenses
- New colour system with wide colour gamut
- 15 stops of latitude
- Built-in 8-stage glass ND filter system
- Compact and customizable
- Mobility with Sony VENICE extension system
- 4K@60p with single BNC with 12SDI support
- Wireless remote control over Wi-Fi
- 4K@120FPS in X-OCN (2.39:1) with R7 and more frame rates*

*Future firmware upgrade and option license, please check with Sony representative.



For more information,
please visit www.pro.sony



VENICE
Full-Frame Digital Motion
Picture Camera System

Beyond Definition

COMPARISON CHART

Model	VENICE + AXS-R7 Raw Recorder	F55 + AXS-R7 Raw Recorder	F55 + AXS-R5 Raw Recorder
Sensor	Full-Frame	Super 35mm 17:9	Super 35mm 17:9
Aperture of Recorded Image	35.9 x 24.0mm	24.0 x 12.66mm	24.0 x 12.66mm
Latitude	15+ Stop (6/9)	14 Stop (6/8)	14 Stop (6/8)
ISO Sensitivity	500 / 2500	1250	1250
Shutter	Fast Shutter	Global Shutter	Global Shutter
Internal ND Filters	Clear, 8NDs (0.3-2.4)	Clear, 0.9, 1.8	Clear, 0.9, 1.8
Lens Mount	PL, E-Mount	PL, FZ Mount	PL, FZ Mount
6K RAW	1-24FPS (6Kx4K) 1-30FPS (6Kx3K)	-	-
4K RAW	1-30FPS (4Kx3.4K) 1-48FPS (4Kx3K) 1-60FPS (4Kx2K)	1-120FPS (4Kx2K)	1-60FPS (4Kx2K)
4K Video HFR	1-60 FPS, W/ X-OCN: 120fps @2.39:1 4K, 110fps @17:9	1-60 FPS	1-60 FPS
Simul Rec. (RAW + 4K Video)	✓	-	-
Simul Rec. (RAW + HD)	✓	✓	✓
Simul Rec. (4K Video + HD)	✓	✓	✓
RAW Rec. + 4K SDI Output	✓	-	-
4K SDI Output	✓	✓	✓
6G/12G SDI Output	✓	-	-
HDMI Output	✓	✓	✓
Weight (VF Incl.)	3.9kg (VENICE) + 1.0kg (R7)	2.3kg (F55) + 1.2kg (R7)	2.3kg (F55) + 0.9kg (R5)

SPECIFICATION VENICE MPC-3610

Camera	
Imaging Device	Full-Frame CMOS
Imaging Device Pixel Count	24.7M (total), 24.4M (effective)
Imaging Device Size	36.2 x 24.1mm 43.5mm Diagonal
Built-In ND Filters	Clear, 0.3 (1/2), 0.6 (1/4), 0.9 (1/8), 1.2 (1/16), 1.5 (1/32), 1.8 (1/64) 2.1 (1/128), 2.4 (1/256)
ISO Sensitivity	ISO500
Lens Mount	PL Mount E-mount (lever lock type, without supplied PL lens mount adaptor)
Latitude	15+ Stop
Select FPS*	3.8K 16:9, 4K 17:9: 1-60FPS,
	4K 4:3: 1-48FPS
	4K 6:5, 5.7K 16:9, 6K 17:9, 6K 1.85:1, 6K 2.39:1: 1-30FPS
	6K 3:2: 1-24FPS
White Balance	2000~15000Kelvin and Green/ Magenta adjust, AWB*
Gamma Curve	S-Log3

Recording	
IRecording Format (Video)	XAVC 4K Class480: 23.98p, 24p, 25p, 29.97p
	XAVC 4K Class300: 23.98p, 24p, 25p, 29.97p, 50p, 59.94p
	XAVC QFHD Class480: 23.98p, 25p, 29.97p
	XAVC QFHD Class300: 23.98p, 25p, 29.97p, 50p, 59.94p
	MPEG HD422 (1920 x 1080): 23.98p, 24p, 25p, 29.97p, 50i, 59.94i
	HD ProRes 422HQ*: 23.98p, 24p, 25p, 29.97p, 50p, 59.94p, 50i, 59.94i
	HD ProRes 422*: 23.98p, 24p, 25p, 29.97p, 50p, 59.94p, 50i, 59.94i
Recording Format (RAW/X-OCN) *required AXS-R7	HD ProRes 422 Proxy*: 23.98p, 24p, 25p, 29.97p, 50p, 59.94p, 50i, 59.94i
	RAW SQ:
	4K 17:9 (4096 x 2160): 23.98p, 24p, 25p, 29.97p, 50p, 59.94p
	3.8K 16:9 (3840 x 2160): 23.98p, 25p, 29.97p, 50p, 59.94p
	X-OCN ST/LT:
	6K 3:2 (6048 x 4032)*: 23.98p, 24p,

Recording Format (RAW/X-OCN) *required AXS-R7	6K 2.39:1 (6048 x 2534)*: 23.98p, 24p, 25p, 29.97p
	6K 1.85:1 (6048 x 3270)*: 23.98p, 24p, 25p, 29.97p
	6K 17:9 (6048 x 3190)*: 23.98p, 24p, 25p, 29.97p
	5.7K 16:9 (5670 x 3190)*: 23.98p, 25p, 29.97p
	4K 6:5 (4096 x 3432)*: 23.98p, 24p, 25p, 29.97p
	4K 4:3 (4096 x 3024): 23.98p, 24p, 25p*, 29.97p*
	4K 17:9 (4096 x 2160): 23.98p, 24p, 25p, 29.97p, 50p, 59.94p
Recording Format (Audio)	3.8K 16:9 (3840 x 2160): 23.98p, 25p, 29.97p, 50p, 59.94p
	LPCM 4ch, 24-bit 48-kHz

Inputs/Outputs	
DC Input	XLR-type 4pin (male)
Battery DC Input	Square-shaped 5pin connector
DC Output	12V: Hirose 4pin x 1
	24V: Fischer 3pin x 2
SDI Output	BNC x 4, (12G*, 3G, 1.5G-SDI)
HD MONI Output	BNC x 1 (1.5G-SDI)
HDMI Output	Type A x 1
VF	LEMO 26pin
Audio Input	XLR-type 5pin (female) x 1 (LINE/ AES/EBU / MIC / MIC+48V selectable)
Timecode Input	BNC x 1
Genlock Input	BNC x 1
AUX	LEMO 5pin (female) x 1 (Timecode Output)
Remote*	8pin x 1
Lens*	12pin x 1
Lens Mount Hot Shoe	4pin x 2, conforming to Cooke/ i Intelligent Electronic Lens System
Network*	RJ-45 type x 1, 10BASE-T, 100BASE-TX
USB*	USB host, type-A x 1
Headphone Output	Stereo mini jack x 1
Speaker Output	Monaural
Media Type	ExpressCard/ 34 slot x 2
	SD card slot x 1

*Firmware update required

AXS-R7

AXS-R7 (operating with VENICE)	
Dimensions	106 x 135 x 67mm (4 ¼ x 5 3/8 x 2 5/8 inch) (Width/ height/ depth)
Mass	Approx. 840g (1 lb. 13.6 oz.)
Interface connector	144 pin
Battery DC Input	Square-shaped pin connector

DVF-EL200

DVF-EL200	
Dimensions	184 x 98 x 92mm (7 ¼ x 3 7/8 x 3 5/6 inch) (Width/ height/ depth)
Mass	Approx. 640g (1 lb 6.6 oz)
Brightness	200cd/m2 (typical)
Resolution	1920 x 1080
Color temperature	D65
VF connector	LEMO 26pin (female)

AXS-AR1

AXS-AR1	
Dimensions	100 x 71 x 193.5mm (3 15/16 x 2 51/64 x 7 5/8inch) (Width/ height/ depth)
Mass	Approx. 1.0kg (2 lb 3.3 oz)
Operating System	Mac OS X10.10 or higher
Supplied Accessories	Thunderbolt Cable (1)
	AC Adaptor (1)



沙
龍



SALON FILMS (H.K.) LTD.
香港沙龍電影有限公司